

REVISIONS

P	LTR	DESCRIPTION	DATE	DWN	APVD
B14		ECR-11-002636	05APR2011	SR	AR
B15		REVISED PER ECR-16-016780	19AUG2017	NG	MKO
B16		REVISED PER ECR-21-123503	12MAR2022	RK	JB
B17		REVISED PER ECR-25-241702	17APR2025	RK	WR

PN 1-1.2-1.3-1.4-1.5-1.1-2.2-2.3-2  
~~4-2.5-2.6-1.4-3.1-8.2-8.3-8.4-8.5-8.~~  
~~4-9.2-9.3-9.4-9 & 5-9~~

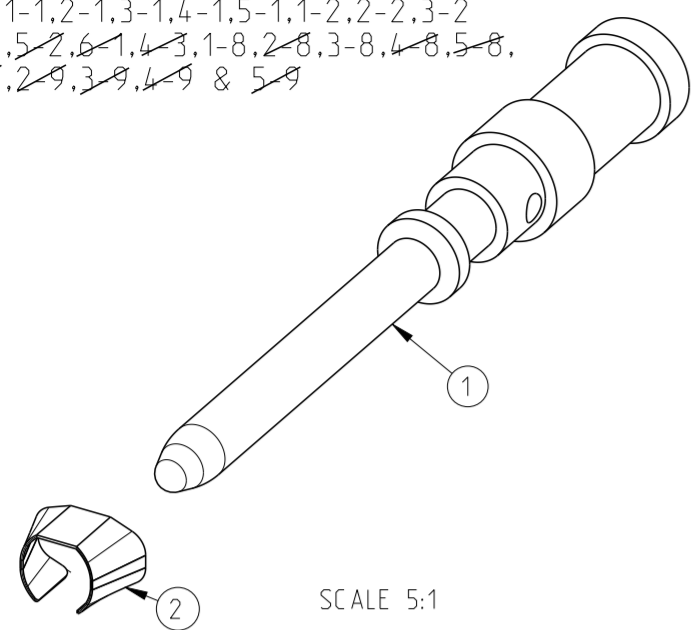

SCALE 5:1

PN 1-1.2-1.3-1.4-1.5-1.1-2.2-2.3-2  
~~4-2.5-2.6-1.4-3.1-8.2-8.3-8.4-8.5-8.~~  
~~4-9.2-9.3-9.4-9 & 5-9~~

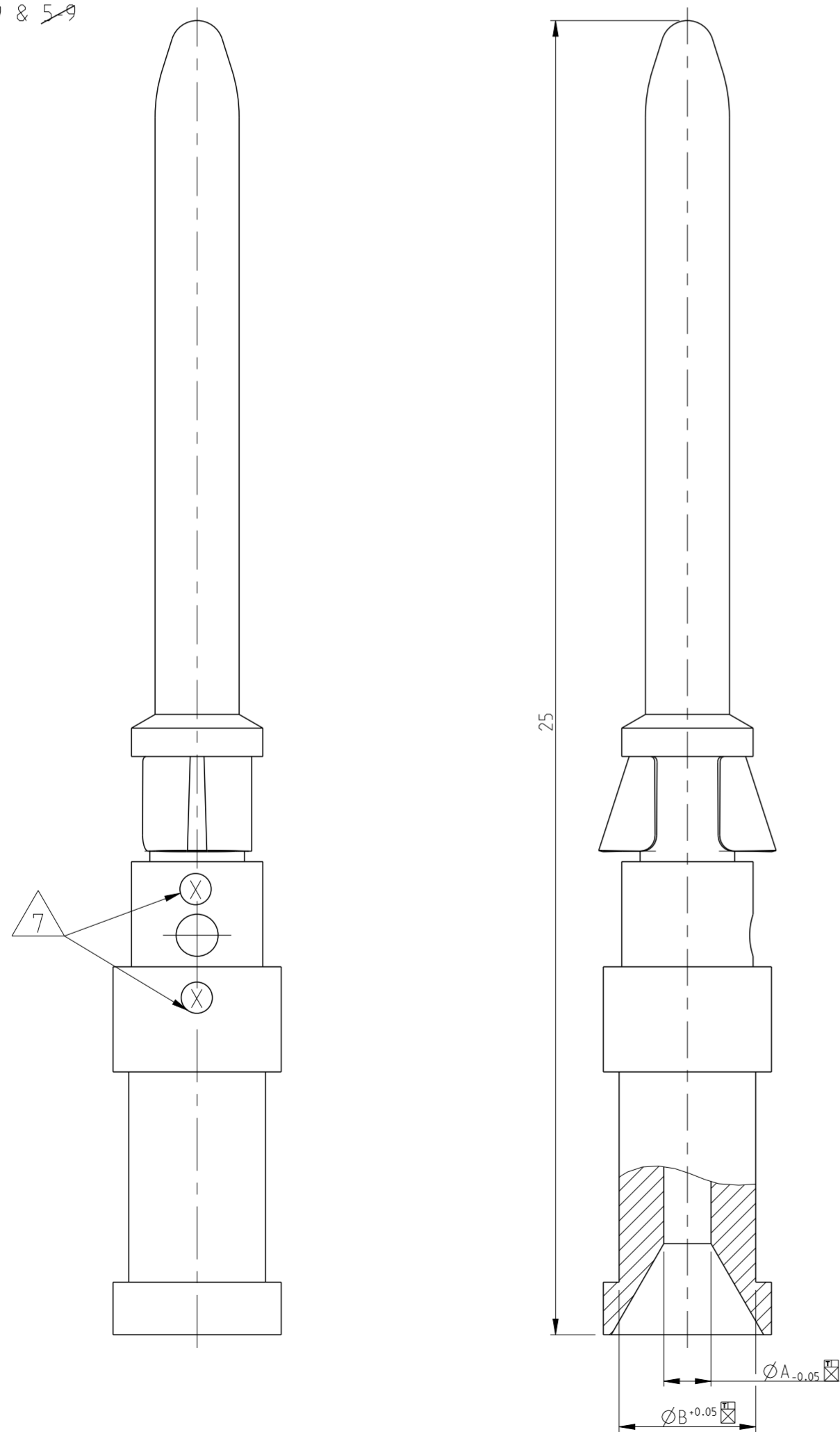

25

ØA<sub>0.05</sub>

ØB<sub>0.05</sub>

NOTES

- 1 MATERIAL SEE TABLE
- 2 SURFACE SEE TABLE
- 3 ASSEMBLY WEIGHT SEE TABLE
- 4 PACKAGING: 50 PIECES IN POLY-BAG 0-1243085-8
- 5 PACKAGING: 500 PIECES IN POLY-BAG 0-1243085-8
- 6 PACKAGING: 10 PIECES IN POLY-BAG 0-1243085-8
- 7 CROSS-SECTION MARKING

PN 1-1.2-1.3-1.4-1.5-1.1-2.2-2.3-2  
~~4-2.5-2.6-1.4-3.1-8.2-8.3-8.4-8.5-8.~~  
~~4-9.2-9.3-9.4-9 & 5-9~~

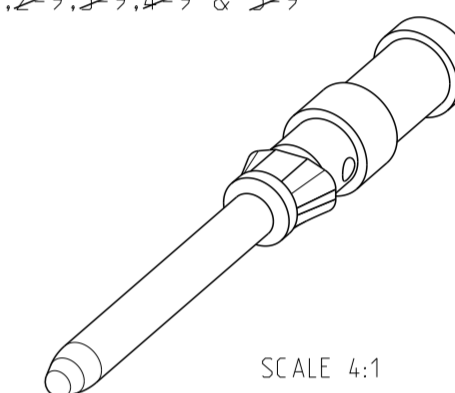

SCALE 4:1

QTY	DESCRIPTION	WEIGHT IN (KG)	MATERIAL	SURFACE	ØA	ØB	CROSS SECTION MARKING	POS
1	Catch Spring		Stainless Steel					2
1	Pin Contact 1.5 mm <sup>2</sup>	0.00062	Ms/Brass	Ag/Ni	1.8	3.0		4
1	Pin Contact 4.0 mm <sup>2</sup>	0.00059	Ms/Brass	Ag/Ni	2.4	3.2		6
1	Pin Contact 2.5 mm <sup>2</sup>	0.00067	Ms/Brass	Au	2.2	3.2		5
1	Pin Contact 1.5 mm <sup>2</sup>	0.00067	Ms/Brass	Au	1.8	3.0		4
1	Pin Contact 0.75-10 mm <sup>2</sup>	0.00063	Ms/Brass	Au	1.45	2.6		3
1	Pin Contact 0.5 mm <sup>2</sup>	0.00062	Ms/Brass	Au	1.1	2.6		2
1	Pin Contact 0.14-0.37 mm <sup>2</sup>	0.00061	Ms/Brass	Au	0.9	2.6		1
1	Pin Contact 2.5 mm <sup>2</sup>	0.00065	Ms/Brass	Ag/Cu	2.2	3.2		5
1	Pin Contact 1.5 mm <sup>2</sup>	0.00067	Ms/Brass	Ag/Cu	1.8	3.0		4
1	Pin Contact 0.75-10 mm <sup>2</sup>	0.00063	Ms/Brass	Ag/Cu	1.45	2.6		3
1	Pin Contact 0.5 mm <sup>2</sup>	0.00062	Ms/Brass	Ag/Cu	1.1	2.6		2
1	Pin Contact 0.14-0.37 mm <sup>2</sup>	0.00061	Ms/Brass		0.9	2.6		1
1	Pin Contact 0.14-0.37 mm <sup>2</sup>	0.00065	Fe	Au	0.9	2.6		1
1	Pin Contact 0.14-0.37 mm <sup>2</sup>	0.00067	Ms/Brass	Ag/Cu	0.9	2.6		1

OBSOLETE  
OBSOLETE

THIS DRAWING IS A CONTROLLED DOCUMENT.

DWN Braun 23.07.1997  
CHK Schurpfeil 23.07.1997  
APVD -



DIMENSIONS: mm	TOLERANCES UNLESS OTHERWISE SPECIFIED: ISO 9013 0 PLC 1 PLC 2 PLC 3 PLC 4 PLC ANGLES FINISH
MATERIAL	FINISH

PRODUCT SPEC	NAME	RESTRICTED TO
108-74018	PIN CONTACT SERIES HN.D	-
APPLICATION SPEC	SIZE	CAGE CODE
114-74015	A2	00779
WEIGHT	DRAWING NO	SCALE
-	C-1105050	10:1
CUSTOMER DRAWING	SHEET	1 OF 1
	REV	B17