

PART NO.  
20021112

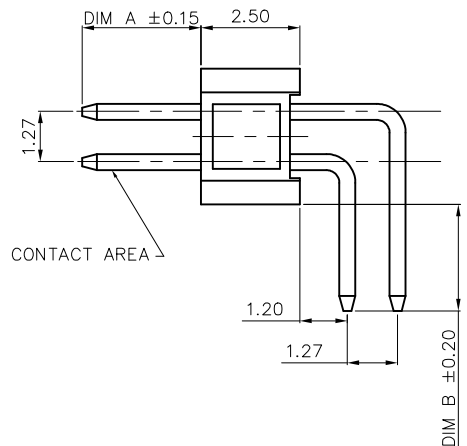

NOTES: UNLESS OTHERWISE SPECIFIED

1. ALL DIMENSIONS ARE IN MILLIMETER, PER ASME Y14.5M-2009.
2. ELECTRICAL CHARACTERISTICS:
  - 2-1 VOLTAGE RATING: 125 VAC MAX..
  - 2-2 CURRENT RATING: 1.0 A MAX. PER PIN, 30°C RISE ABOVE AMBIENT.
  - 2-3 CONTACT RESISTANCE: 20 MILLIOHMS MAX. FOR INITIAL, 40 MILLIOHMS MAX. AFTER TEST.
  - 2-4 DIELECTRIC WITHSTANDING VOLTAGE: 500V AC R.M.S..
  - 2-5 INSULATION RESISTANCE: 1000 MEGOHMS MIN..
3. OTHER CHARACTERISTICS:
  - 3-1 THE PRODUCT WILL WITHSTAND EXPOSURE TO 260°C PEAK TEMPERATURE FOR 10 SECONDS IN A WAVE SOLDER OR VAPOR PHASE REFLOW OVEN.
  - 3-2 PRODUCT SPEC: GS-12-629.
  - 3-3 PACKAGE SPEC: GS-14-1420.
  - 3-4 MATE WITH: 20021311 / 20021321 / 20021323.
  - 3-5 THIS PRODUCT MEETS EUROPEAN UNION DIRECTIVES AND OTHER COUNTRY REGULATIONS AS DESCRIBED IN GS-22-008,

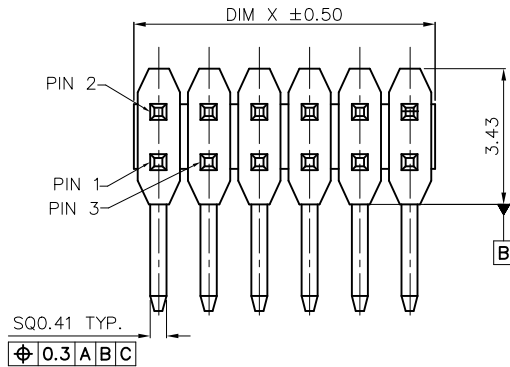
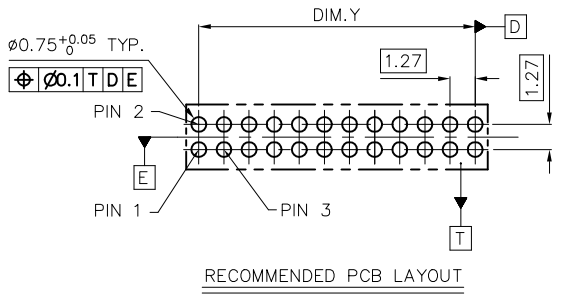
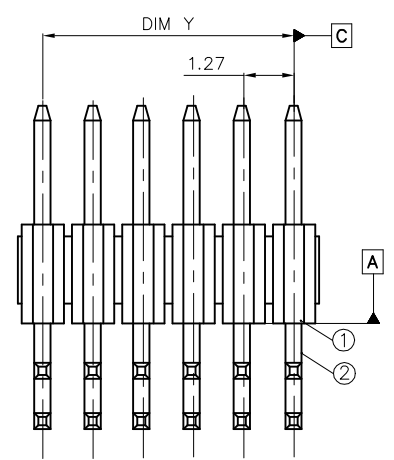

2	CONTACT	COPPER ALLOY	1.27µm MIN. NICKEL PLATING OVERALL UNDERPLATED 1.27µm MIN. MATTE TIN OR G/F PLATING OVER NICKEL AT TAIL GOLD OR GXT PLATING ON CONTACT AREA
1	HOUSING	THERMOPLASTIC UL 94V-0	MOLDED BLACK
ITEM	DESCRIPTION	MATERIAL	TREATMENT
mat'l. code		surface ISO 1302	tolerance ISO 406 ISO 1101
ltr		ecn no	dr
F		ELX-N-23548	TIM YAO
G		ELX-N-26146	TONY LENG
H		ELX-N-49660	SANFORD LU
J		ELX-N-291051	GRACE LIU
date		03/21/16	02/22/16
tolerances unless otherwise specified		angles	linear
0.X±0.30		0°±2'	0.XXX±0.10
projection		product family	
HPL 585		HPL 585	
title		MINITEK 1.27	
scale 1:1		dwg no	
20021112		sheet 1 of 3	
type		Product Customer Drawing	
sheet index		revision	
1		J	

Amphenol FCI

© 2016 AFCI

Amphenol FCI

PART NO.	POS.	DIM"X"	DIM"Y"
20021112-0XX04XXLF	2 X 2	2.54	2.54
20021112-0XX06XXLF	2 X 3	3.81	2.54
20021112-0XX08XXLF	2 X 4	5.08	3.81
20021112-0XX10XXLF	2 X 5	6.35	5.08
20021112-0XX12XXLF	2 X 6	7.62	6.35
20021112-0XX14XXLF	2 X 7	8.89	7.62
20021112-0XX16XXLF	2 X 8	10.16	8.89
20021112-0XX18XXLF	2 X 9	11.43	10.16
20021112-0XX20XXLF	2 X 10	12.70	11.43
20021112-0XX12XXLF	2 X 11	13.97	12.70
20021112-0XX24XXLF	2 X 12	15.24	13.97
20021112-0XX26XXLF	2 X 13	16.51	15.24
20021112-0XX28XXLF	2 X 14	17.78	16.51
20021112-0XX30XXLF	2 X 15	19.05	17.78
20021112-0XX32XXLF	2 X 16	20.32	19.05
20021112-0XX34XXLF	2 X 17	21.59	20.32
20021112-0XX36XXLF	2 X 18	22.86	21.59
20021112-0XX38XXLF	2 X 19	24.13	22.86
20021112-0XX40XXLF	2 X 20	25.40	24.13
20021112-0XX42XXLF	2 X 21	26.67	25.40
20021112-0XX44XXLF	2 X 22	27.94	26.67
20021112-0XX46XXLF	2 X 23	29.21	27.94
20021112-0XX48XXLF	2 X 24	30.48	29.21
20021112-0XX50XXLF	2 X 25	31.75	30.48

PART NO.	POS.	DIM"X"	DIM"Y"
20021112-0XX52XXLF	2 X 26	33.02	31.75
20021112-0XX54XXLF	2 X 27	34.29	33.02
20021112-0XX56XXLF	2 X 28	35.56	34.29
20021112-0XX58XXLF	2 X 29	36.83	35.56
20021112-0XX60XXLF	2 X 30	38.10	36.83
20021112-0XX62XXLF	2 X 31	39.37	38.10
20021112-0XX64XXLF	2 X 32	40.64	39.37
20021112-0XX66XXLF	2 X 33	41.91	40.64
20021112-0XX68XXLF	2 X 34	43.18	41.91
20021112-0XX70XXLF	2 X 35	44.45	43.18
20021112-0XX72XXLF	2 X 36	45.72	44.45
20021112-0XX74XXLF	2 X 37	46.99	45.72
20021112-0XX76XXLF	2 X 38	48.26	46.99
20021112-0XX78XXLF	2 X 39	49.53	48.26
20021112-0XX80XXLF	2 X 40	50.80	49.53
20021112-0XX82XXLF	2 X 41	52.07	50.80
20021112-0XX84XXLF	2 X 42	53.34	52.07
20021112-0XX86XXLF	2 X 43	54.61	53.34
20021112-0XX88XXLF	2 X 44	55.88	54.61
20021112-0XX90XXLF	2 X 45	57.15	55.88
20021112-0XX92XXLF	2 X 46	58.42	57.15
20021112-0XX94XXLF	2 X 47	59.69	58.42
20021112-0XX96XXLF	2 X 48	60.96	59.69
20021112-0XX98XXLF	2 X 49	62.23	60.96
20021112-0XXA0XXLF	2 X 50	63.50	62.23

20021112 - 0 X X XX X X LF

- LEAD FREE
- PLATING OPTIONAL
- 1: GOLD FLASH AT CONTACT, 1.27µm MIN. MATTE TIN AT TAIL
- 2: GOLD FLASH AT CONTACT, GOLD FLASH AT TAIL
- 3: 0.25GXT AT CONTACT, 1.27µm MIN. MATTE TIN AT TAIL
- 4: 0.25µm GOLD AT CONTACT, 1.27µm MIN. MATTE TIN AT TAIL
- 5: 0.25µm GOLD AT CONTACT, GOLD FLASH AT TAIL
- 6: 0.38GXT AT CONTACT, 1.27µm MIN. MATTE TIN AT TAIL
- 7: 0.38GXT AT CONTACT, GOLD FLASH AT TAIL
- 8: 0.76GXT AT CONTACT, 1.27µm MIN. MATTE TIN AT TAIL
- 9: 0.76GXT AT CONTACT, GOLD FLASH AT TAIL
- PACKING STYLE
- T: TUBE
- PIN NO. SEE TABLE
- TAIL LENGTH (DIM.B)
  - 0: 2.30mm (FOR 1.6mm PCB)
  - 1: 1.60mm (FOR 1.0mm PCB)
  - 2: 2.70mm (FOR 2.0mm PCB)
  - 3: 1.00mm (FOR 0.55mm PCB)
- MATING LENGTH (DIM.A)
  - 0: 3.05mm
- SELECTED LOADED
  - 0: FULL LOADED, OTHER SEE SHEET 3



© 2016 AFCI

mat'l. code		surface	tolerance	projection	product family
		ISO 1302 ✓	ISO 406 ISO 1101		HPL 585
ltr	ecn no	dr	date	title	
J				MINITEK 1.27	
tolerances unless otherwise specified				mm	scale 1:1
angles		linear			
		0.X±0.30			
		0.XX±0.20			
		0.XXX±0.10			
dr	GRACE LIU	03/26/26			
enr	GRACE LIU	03/26/26			
chr	LEI LQ	03/26/26			
appd	TIM YAO	03/26/26			
sheet index	revision sheet	J 2			
				Amphenol FCI	
				dwg no 20021112 sheet 2 of 3 size A3	
				type Product Customer Drawing	

PART NO.  
20021112

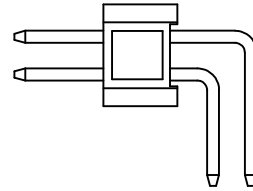
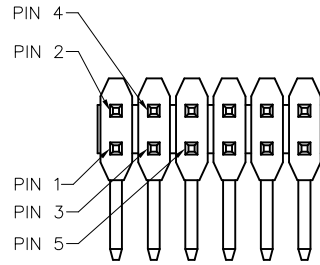

PART NO.	AMOUNT OF PINS	PIN FREE LOADED
20021112-1XXXXXXLF	13	PIN 5

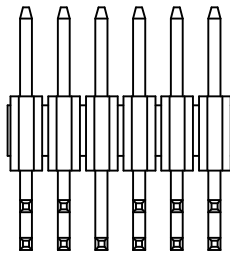

20021112-1XXXXXXLF REMOVE PIN 5

mat'l. code		surface	tolerance	projection	product family
		ISO 1302 ✓	ISO 406 ISO 1101		HPL 585
ltr	ecn no	dr	date	mm	title
J				← mm →	MINITEK 1.27
		angles	linear	scale 1:1	dwg no
		0°±2'	0.X±0.30 0.XX±0.20 0.XXX±0.10		sheet 3 of 3
		dr	GRACE LIU	03/26/26	size
		enr	GRACE LIU	03/26/26	A3
		chr	LEI LQ	03/26/26	type
		appd	TIM YAO	03/26/26	Product Customer Drawing
sheet	revision	J			
index	sheet	3			

© 2016 AFCI  
 Amphenol FCI