

APPROVED: _____
 DATE: _____ TITLE: _____

Rev	AWO #	Description	Date	Appr
-		RELEASED	2/02/10	
A		REVISED SHAPE	12/22/12	
B		REVISED DIM.	2/5/14	AY
C		UPDATE DRAWING	9/24/20	AYLL1

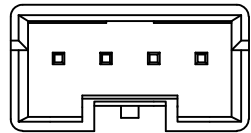

2~4P

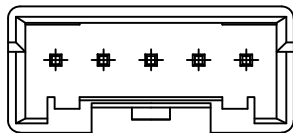

5~6P

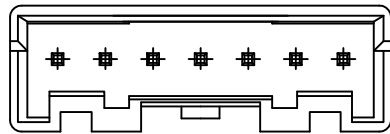

7~9P

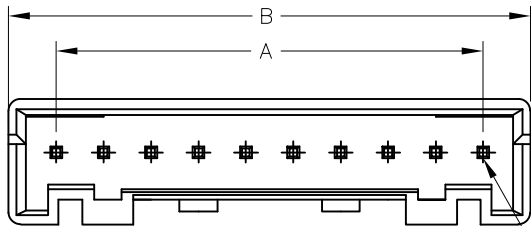

10P-15P

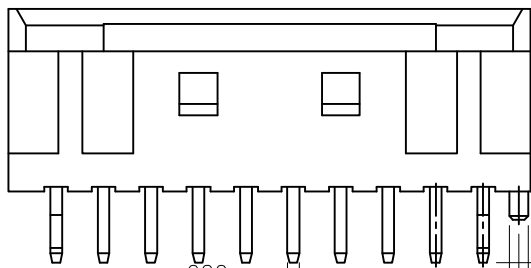
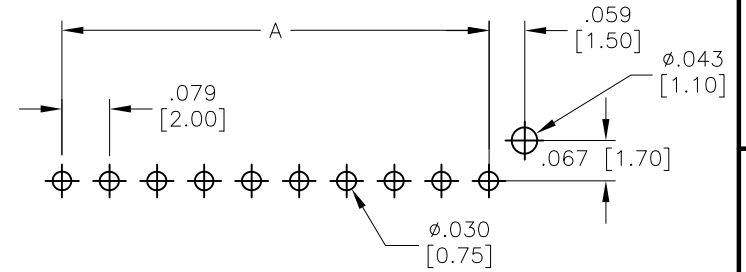

Circuit No.1

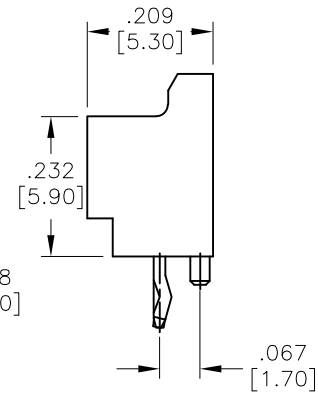

SPECIFICATIONS:

Material:
 Insulator: PBT, glass reinforced, rated UL 94V-0
 Insulator color: White

Contacts: Brass
 Plating:

Tin over Copper underplate overall

Electrical:
 Voltage rating: 250 AC/DC
 Current rating: 3A AC/DC max AWG#22
 Contact resistance: 20 mohms max
 Insulation resistance: 1000 Mohms min
 Dielectric withstanding voltage: 800 VAC for 1 minute

Temperature Rating:
 Operating temperature: -25°C to +85°C
 Environmental:

Lead free, RoHS compliant



Positions: 02 thru 15
 A = .079 [2.00] x No. of Spaces
 B = .079 [2.00] x No. of Spaces + .157 [4.00]

UNLESS OTHERWISE SPECIFIED
 ALL DIMENSIONS ARE INCHES [MM]
 TOLERANCES: EXCEPT AS NOTED

INCHES		HOLES	
.X	± .10	ϕ .X	± .10
.XX	± .020	ϕ .XX	± .015
.XXX	± .015	ϕ .XXX	± .010

ADAM TECH
INTERCONNECTS

909 Rahway Avenue,
 Union, NJ 07083
 Phone: 908-687-5000
 Fax: 908-687-5710

APPROVALS		DATE
DRAWN	DY	2/02/10
CHECKED		
APPROVED		

TITLE .079 [2.00] SHROUDED HEADER STRAIGHT, PCB		
SIZE X	PART NO. 2SH-H-XX-TS	REV. C
REF: S00015T	SCALE: NTS	SHEET 1 OF 1