

NOTES:

- SPECIFICATIONS  
Current Rating: 1A AC,DC  
Voltage Rating: 125V AC,DC  
Temperature Range: -40°C ~ +105°C  
Contact Resistance: 20mΩ Max.  
Insulation Resistance: 100MΩ Min.  
Withstanding Voltage: 500V AC/minute
- Material & finish:  
Housing: Natural Thermoplastic, UL94V-0  
Terminal: Phosphor Bronze  
Plating of contact area: Matte Tin or gold plating over Nickel  
Plating of solder area: Tin plated over Nickel
- Crimping application hand tool P/N: 10118656-1000
- Product specification: GS-12-675
- Packaging specification: GS-14-1593
- Mate With Receptacle: AFCI 10114826
- Ordering Information & Dimensions:

10114831- X X X XX X LF

Material 1: LCP

VOID: NORMAL  
1: SEE SHEET 2

pin code from 02~15(D=2.0mm)  
pin code from 32~45(D=2.3mm)

Plating  
0: Matte Tin  
1: Gold Flash  
2: 15u" Gold ON CONTACT AREA  
3: 30u" Gold ON CONTACT AREA

Packaging  
1: Tape & Reel

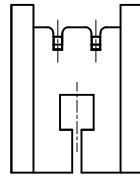
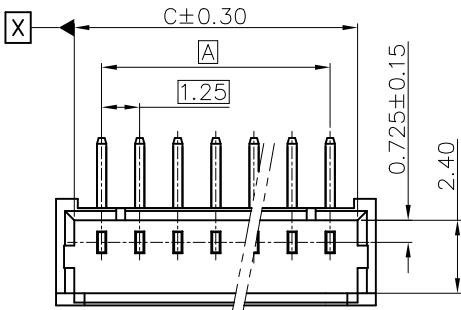

2 POS

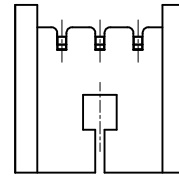

3 POS

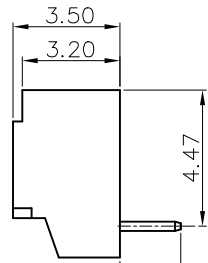
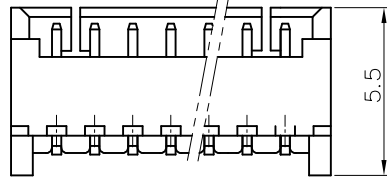

Tail length D

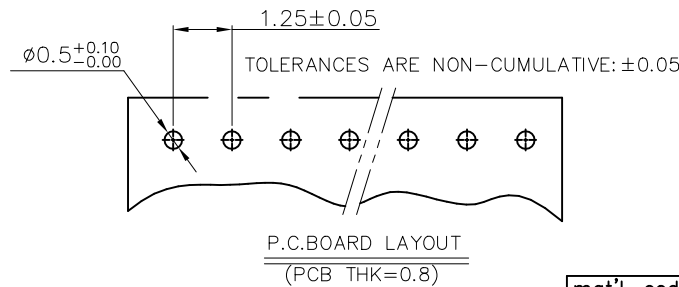
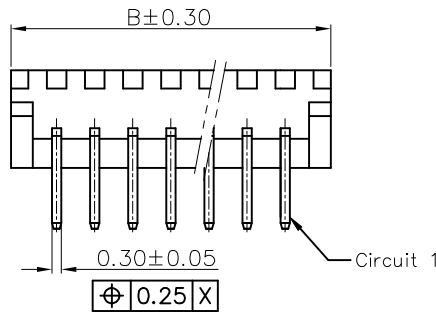
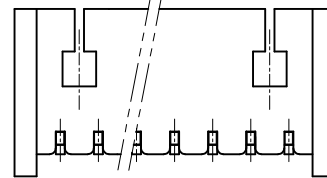

Part No.		Dimensions			
D=2.0mm	D=2.3mm	POS	A	B	C
10114831-xxx02LF	10114831-xxx32LF	2	1.25±0.10	4.25	3.05
10114831-xxx03LF	10114831-xxx33LF	3	2.50±0.10	5.50	4.30
10114831-xxx04LF	10114831-xxx34LF	4	3.75±0.10	6.75	5.55
10114831-xxx05LF	10114831-xxx35LF	5	5.00±0.10	8.00	6.80
10114831-xxx06LF	10114831-xxx36LF	6	6.25±0.15	9.25	8.05
10114831-xxx07LF	10114831-xxx37LF	7	7.50±0.15	10.50	9.30
10114831-xxx08LF	10114831-xxx38LF	8	8.75±0.15	11.75	10.55
10114831-xxx09LF	10114831-xxx39LF	9	10.00±0.15	13.00	11.80
10114831-xxx10LF	10114831-xxx40LF	10	11.25±0.20	14.25	13.05
10114831-xxx11LF	10114831-xxx41LF	11	12.50±0.20	15.50	14.30
10114831-xxx12LF	10114831-xxx42LF	12	13.75±0.20	16.75	15.55
10114831-xxx13LF	10114831-xxx43LF	13	15.00±0.20	18.00	16.80
10114831-xxx14LF	10114831-xxx44LF	14	16.25±0.20	19.25	18.05
10114831-xxx15LF	10114831-xxx45LF	15	17.50±0.20	20.50	19.30

mat'l. code		surface ISO 1302		tolerance ISO 406/ISO 1101		projection		product family	
ltr		ecn no		dr		date		FitMate	
F		BLX-N-47289		JH		2023/01/17		title	
								WTB 1.25MM WAFER 90° DIP	
								dwg no	
								sheet1 of 2	
								size	
								A4	
								type	
								Product Customer Drawing	
sheet index		revision		F		1~2			

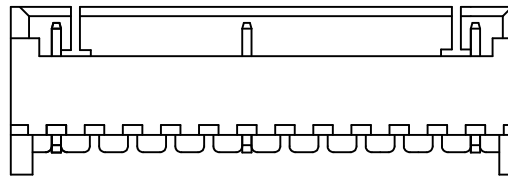
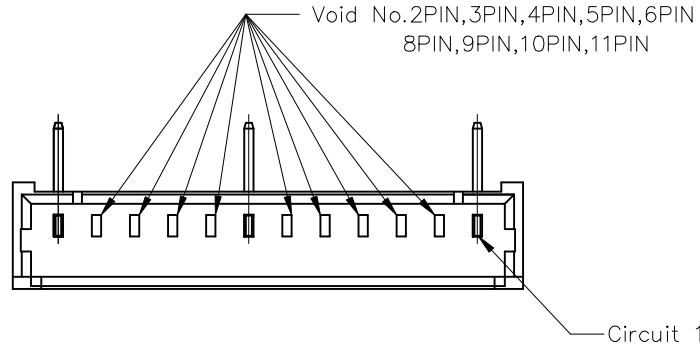

10114831-XXXXX1LF

mat'l. code				surface ISO 1302	tolerance ISO 406/ISO 1101	projection mm	product family FitMate			
ltr	ecn no	dr	date	tolerances unless otherwise specified			title			
F	ELX-N-47289	JH	2023/01/17	angles	.0±.5	mm	WTB 1.25MM WAFER 90° DIP			
				linear	.00±.25					
				0°±2°	.000±.010					
		dr	Jeffrey.Huang	-		Amphenol FCi	dwg no		sheet2 of 2	size
		enr	Jeffrey.Huang	-			10114831		A4	
		chr	TIM YAO	-			type Product Customer Drawing			
		appd	TIM YAO	-						
sheet index	revision	F								
	sheet	1~2								