

FRONT VIEW

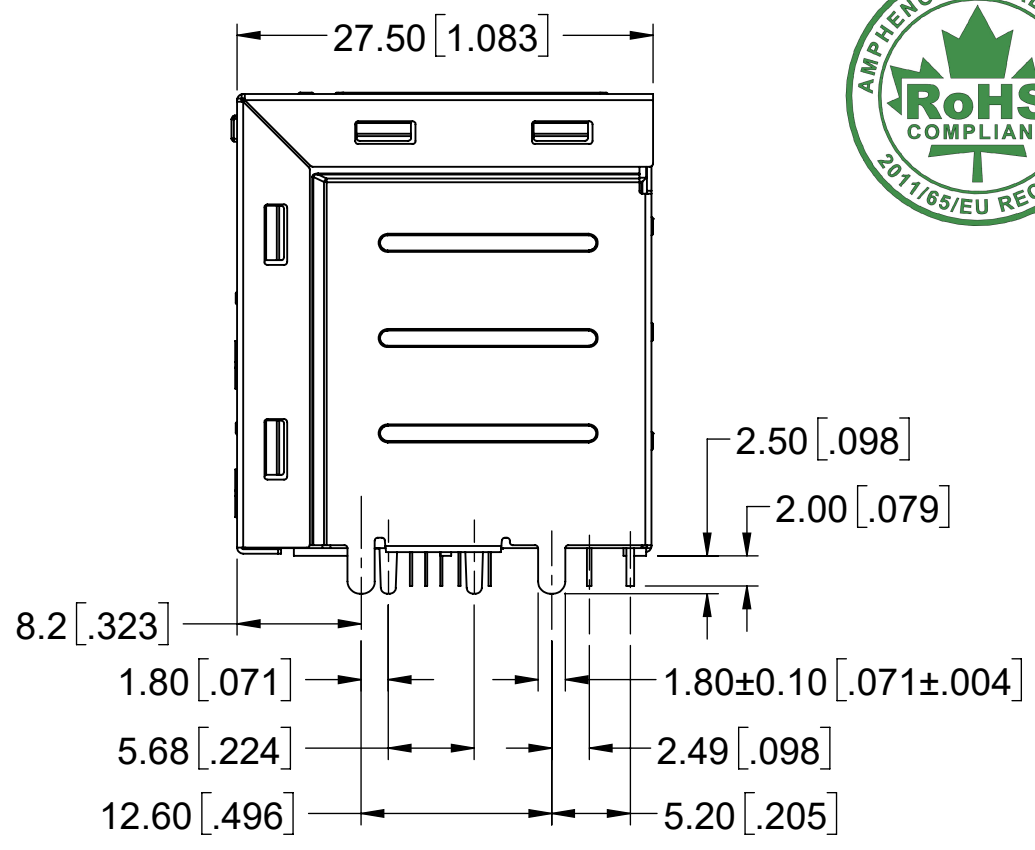

SIDE VIEW

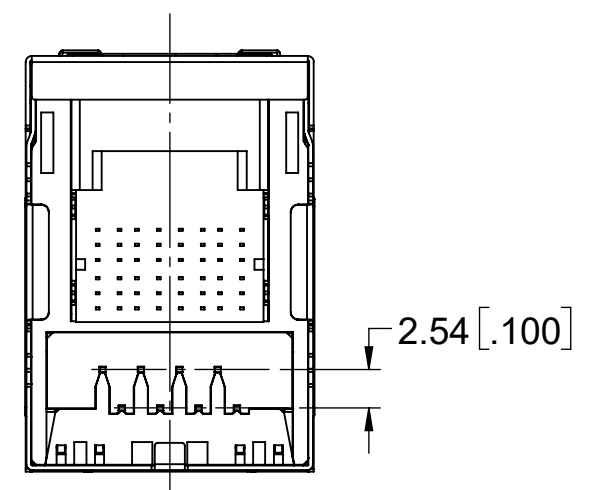

BOTTOM VIEW

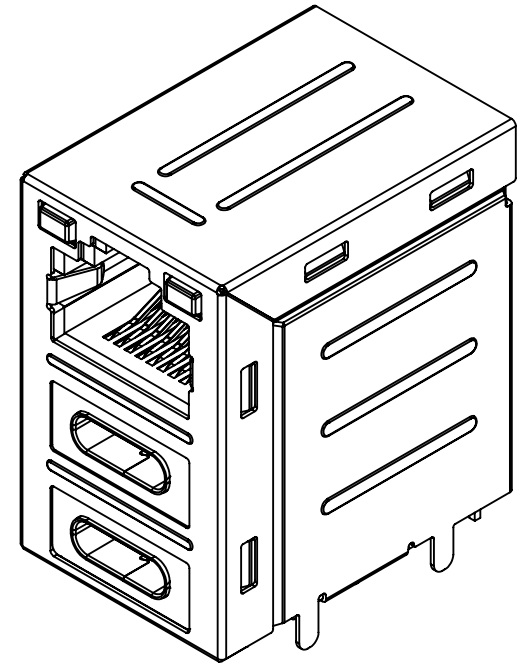

ISOMETRIC VIEW

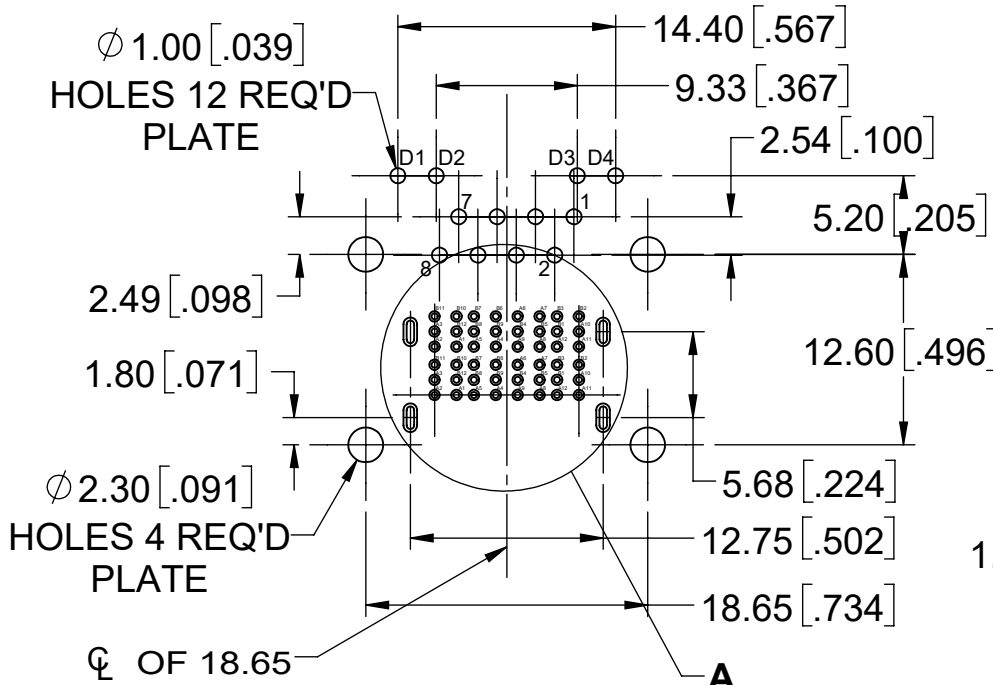

RECOMMENDED P.C.B LAYOUT (TOLERANCE: ±0.05 [0.002]) (COMPONENT SIDE OF BOARD)

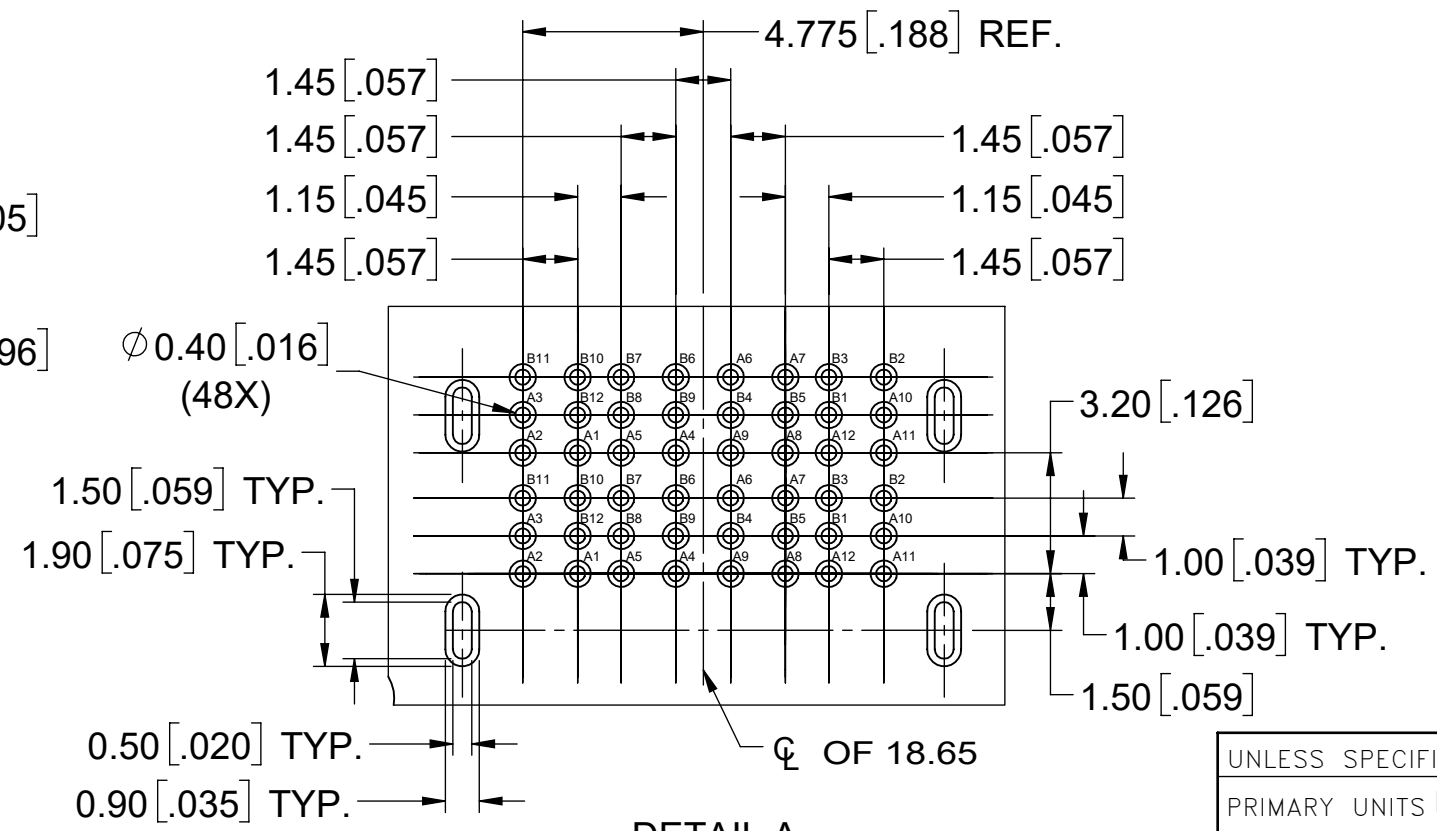

DETAIL A SCALE 5 : 1



REVISIONS			
REV	DESCRIPTION, ECN, EAR NO.	DATE	APP'D
A	INITIAL RELEASE	FEB6,2023	K.T
B	FIX THE ERROR FOR NOTES	SEP28/23	K.T
C	ADD HOLE SIZE FOR BOTTOM TYPE C	JUL31/24	K.T

PIN	SIGNAL NAME	DESCRIPTION	PIN	SIGNAL NAME	DESCRIPTION
A1	GND	Ground return	B12	GND	Ground return
A2	SSTXp1	Positive half of first SuperSpeed TX differential pair	B11	SSRXp1	Positive half of first SuperSpeed RX differential pair
A3	SSTXn1	Negative half of first SuperSpeed TX differential pair	B10	SSRXn1	Negative half of first SuperSpeed RX differential pair
A4	VBUS	Bus Power	B9	VBUS	Bus Power
A5	CC1	Configuration Channel	B8	SBU2	Sideband Use(SBU)
A6	Dp1	Positive half of the USB 2.0 differential pair-Position 1	B7	Dn2	Negative half of the USB 2.0 differential pair-Position 2
A7	Dn1	Negative half of the USB 2.0 differential pair-Position 1	B6	Dp2	Positive half of the USB 2.0 differential pair-Position 2
A8	SUB1	Sideband Use(SBU)	B5	CC2	Configuration Channel
A9	VBUS	Bus Power	B4	VBUS	Bus Power
A10	SSRXn2	Negative half of the second SuperSpeed RX differential pair	B3	SSTXn2	Negative half of second SuperSpeed TX differential pair
A11	SSRXp2	Positive half of the second SuperSpeed RX differential pair	B2	SSTXp2	Positive half of second SuperSpeed TX differential pair
A12	GND	Ground return	B1	GND	Ground return

**NOTES:**

- MATERIALS:**  
 PLASTIC HOUSING: HIGH TEMPERATURE THERMOPLASTIC FLAMMABILITY RATING UL94V-0, COLOR: BLACK  
 CONTACT: PHOSPHOR BRONZE  
 PLATING: SELECTIVE GOLD PLATING ON MATING SURFACE  
 SEE AMPHENOL PART NUMBER FOR DETAIL,  
 100µ" MIN. MATTE TIN ON CONTACT TAILS  
 50µ" MIN. NICKEL UNDERPLATE.  
 SHIELD: STAINLESS STEEL  
 PLATING: 100µ" MIN. MATTE TIN ON SOLDER TAILS,  
 30µ" MIN. NICKEL UNDERPLATE

- RECOMMENDED SOLDER TEMPERATURE:**  
 REFLOW SOLDER PEAK TEMPERATURE 260 °C FOR 10 SECONDS MAXIMUM.

AMPHENOL PART NUMBER: RJE36-188-3XXC-H

- GOLD PLATING OPTIONS:**
- 1 = 6µ" GOLD PLATING
  - 2 = 15µ" GOLD PLATING
  - 3 = 30µ" GOLD PLATING
  - 4 = 50µ" GOLD PLATING

REFER TO LED OPTIONS DRAWING FOR ORDERING CODES

UNLESS SPECIFIED OTHERWISE	DRAWN	KELVIN.T	FEB6,23
PRIMARY UNITS MILLIMETRES	CHECKED		
SECONDARY INCHES	M.E. APP'D		
REFERENCE IN PARENTHESES	Q.A. APP'D		
GENERAL TOLERANCES	DWG APPR.		
1 DECIMAL PLACE ±0.50	ENG. REL. NO.		
2 DECIMAL PLACES ±0.35	REF.		
3 DECIMAL PLACES ±0.20	THIRD ANGLE PROJECTION	DO NOT SCALE DRAWING	
ANGULAR DEGREES ±1.5°			

**Amphenol Canada Corp.**  
 Commercial Products

**8P8C MODULAR JACK OVER TWO TYPE C SHIELDED, WITH LED OPTIONS -RoHS COMPLIANT**

DWG. NO. **P-RJE36-188-3XXC-H** REV **C**

CODE ID NO. 03554 DWG SIZE: X SCALE: 2:1 SHEET 1 OF 3

REVISIONS			
REV	DESCRIPTION, ECN, EAR NO.	DATE	APP'D
A	INITIAL RELEASE	FEB6,2023	K.T
B	FIX THE ERROR FOR NOTES	SEP28/23	K.T
C	ADD HOLE SIZE FOR BOTTOM TYPE C	JUL31/24	K.T

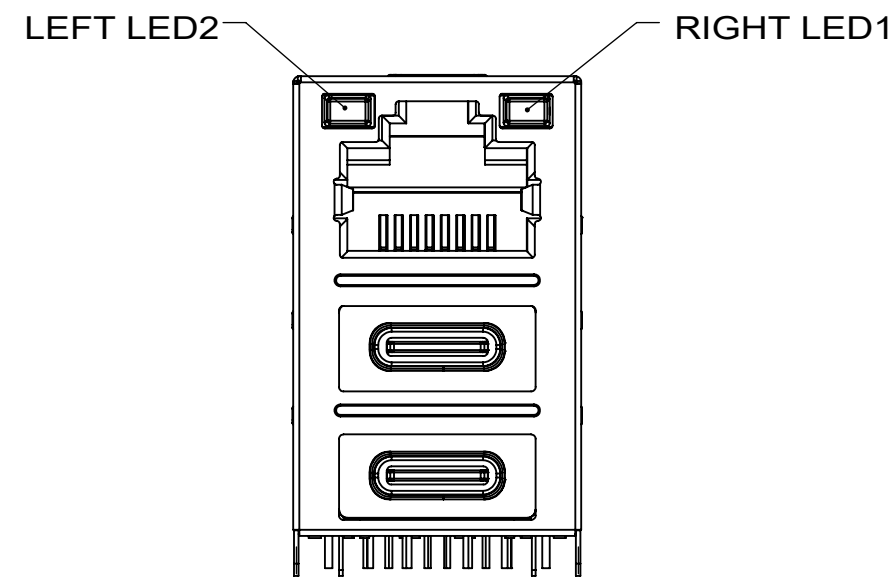

TYPICAL FOR SINGLE COLOR

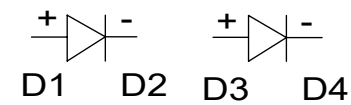

TYPICAL FOR BI-COLOR  
(E.G. BIC GREEN/YELLOW)

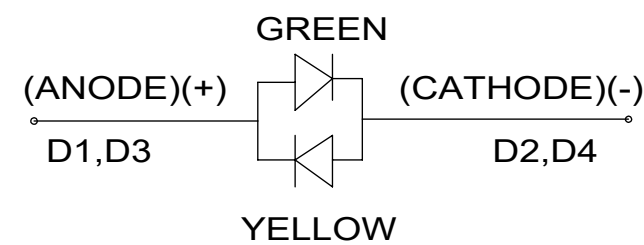

PRIMARY COLOR FOR BI-COLOR  
LEDS IN STANDARD ANODE/CATHODE  
CONFIGURATION IS:  
RED-GREEN=RED  
RED-YELLOW=RED  
GREEN-YELLOW=GREEN  
GREEN-ORANGE=GREEN

LEGEND  
BIC= BI-COLOR LED  
YE=YELLOW  
GR=GREEN  
RD=RED  
OR=ORANGE

NOTE:  
THE TWO DIGITS PRECEDING THE  
ADDITIONAL LED CODE MUST BE  
USED IN THE PART NUMBER, WHEN  
ORDERING ANY OF THE ADDITIONAL  
LED OPTIONS.

EXAMPLE:  
PART NUMBER: RJE36-188-3XXC-H

LED COLOR CODE

CODE	LED 2(LEFT)	LED 1(RIGHT)	CODE	LED 2(LEFT)	LED 1(RIGHT)	CODE	LED 2(LEFT)	LED 1(RIGHT)
0	BLOCKED	BLOCKED	9	GREEN	BLOCKED	J	BIC RD/GR	YELLOW
1	YELLOW	GREEN	A	BIC GR/YE	BIC GR/YE	K	YELLOW	BIC GR/OR
2	BLOCKED	GREEN	B	BIC RD/GR	BIC RD/GR	L	BIC GR/YE	RED
3	YELLOW	BLOCKED	C	BIC RD/GR	BIC GR/YE	M	RED	YELLOW
4	GREEN	YELLOW	D	GREEN	BIC GR/YE	N	BIC GR/RD	BIC GR/YE
5	GREEN	GREEN	E	YELLOW	BIC GR/YE	P	GREEN	BIC RD/GR
6	YELLOW	YELLOW	F	BIC GR/YE	YELLOW	R	BIC GR/OR	GREEN
7	RED	GREEN	G	BIC GR/OR	BIC GR/OR	T	RED	RED
8	GREEN	RED	H	BIC GR/YE	GREEN	V	BIC RD/GR	GREEN

UNLESS SPECIFIED OTHERWISE	DRAWN	KELVIN.T	FEB6,23
PRIMARY UNITS MILLIMETRES	CHECKED		
SECONDARY INCHES	M.E. APP'D		
REFERENCE IN PARENTHESES	Q.A. APP'D		
GENERAL TOLERANCES	DWG APPR.		
1 DECIMAL PLACE ±0.50	ENG. REL. NO.		
2 DECIMAL PLACES ±0.35	REF.		
3 DECIMAL PLACES ±0.20	THIRD ANGLE PROJECTION		
ANGULAR DEGREES ±1.5°	DO NOT SCALE DRAWING		

**Amphenol Canada Corp.**  
Commercial Products

**8P8C MODULAR JACK OVER TWO TYPE C SHIELDED, WITH LED OPTIONS -RoHS COMPLIANT**

DWG. NO. **P-RJE36-188-3XXC-H** REV **C**

CODE ID NO. 03554 DWG SIZE: X SCALE: 2:1 SHEET 2 OF 3

REVISIONS			
REV	DESCRIPTION, ECN, EAR NO.	DATE	APP'D
A	INITIAL RELEASE	FEB6,2023	K.T
B	FIX THE ERROR FOR NOTES	SEP28/23	K.T
C	ADD HOLE SIZE FOR BOTTOM TYPE C	JUL31/24	K.T

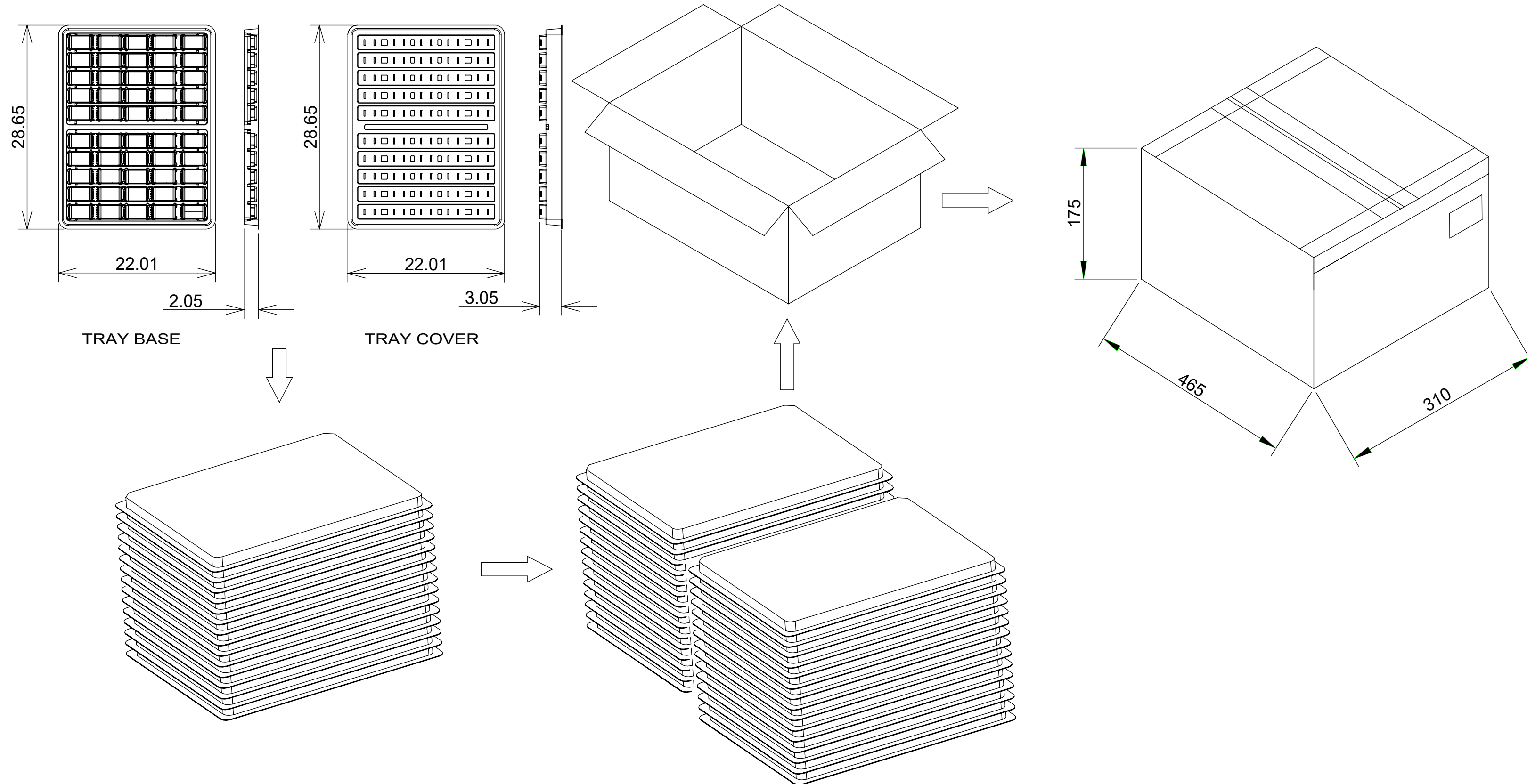

**PACKAGING NOTES:**

1. ONE TRAY SHOULD HOLD 50PCS CONNECTORS.
2. A FULLY LOADED CARTON SHOULD CONTAIN 10 TRAYS(500PCS) OF CONNECTORS.

UNLESS SPECIFIED OTHERWISE	DRAWN	KELVIN.T	FEB6,23
PRIMARY UNITS MILLIMETRES	CHECKED		
SECONDARY INCHES	M.E. APP'D		
REFERENCE IN PARENTHESES	Q.A. APP'D		
GENERAL TOLERANCES	DWG APPR.		
1 DECIMAL PLACE ±0.50	ENG. REL. NO.		
2 DECIMAL PLACES ±0.35	REF.		
3 DECIMAL PLACES ±0.20	THIRD ANGLE PROJECTION		
ANGULAR DEGREES ±1.5°	DO NOT SCALE DRAWING		

**Amphenol Canada Corp.**  
Commercial Products

**8P8C MODULAR JACK OVER TWO TYPE C SHIELDED, WITH LED OPTIONS -RoHS COMPLIANT**

DWG. NO. **P-RJE36-188-3XXC-H** REV **C**

CODE ID NO. 03554 DWG SIZE: X SCALE: 2:1 SHEET 3 OF 3