

PRODUCT NUMBER
91614-YXXZLF

RoHS COMPATIBLE PRODUCT, SEE NOTE 7

PACKAGING:
(MAY BE SUBJECT TO TOOLING FEES)

- A: TAPE & REEL PACKAGING, PRODUCT AND CAP GREY, TA-856
 - G: TAPE & REEL PACKAGING, PRODUCT AND CAP BLACK, TA-856
 - AV: TAPE & REEL PACKAGING FOR CUSTOMER DEDICATED PART, PRODUCT AND GREY CAP TA-856
 - KV: TAPE & REEL PACKAGING WITHOUT PICK-UP CAP FOR CUSTOMER DEDICATED PART GREY TA-856
 - TV: TUBE WITHOUT CAP FOR CUSTOMER DEDICATED PART, GREY COLOR
 - B: TUBE WITHOUT CAP, PRODUCT BLACK, SEE NOTE 3
 - : OMIT LETTER MEANS STD PACKAGING TUBE, SEE NOTE 3
- NUMBER OF POSITIONS: 03 UP TO 25, OVER 25 POS ON REQUEST

PLATING CODE:
(AS AVAILABLE)

- 3= 0.76µm GOLD ON CONTACT AREA
2µm MIN MATTE TIN ON TAIL
- 4= 2µm MIN MATTE TIN FULL PLATED
1.27µm Ni MIN UNDERPLATING

NOTES:

- 1 - HOUSING & PICK UP CAP MATERIAL: HIGH TEMPERATURE THERMOPLASTIC GLASS FILLED FLAME RETARDANT PER UL 94 COLOR: GREY OR BLACK
- 2 - TERMINAL MATERIAL: PHOSPHOR BRONZE.
- 3 - 91614-YXXLF & -YXXGLF & -YXXBLF ARE PACKED IN TUBE.
- 4 - TO DETERMINE DIMENSIONS:
N = NUMBER OF POSITIONS
EXAMPLE: 8 POS: ((N+2)x2.54)-0.08=25.32 mm.
- 5 - RECOMMENDED IR PROFILE PER TA842.
- 6 - ø2.65 MINI FOR PICK & PLACE ASSEMBLY(=0 INSERTION FORCE).
- 7 - RoHS COMPATIBLE PRODUCT SPECIFICATIONS
 - a - PLATING:
- "LF" MEANS THE PRODUCT IS LEAD-FREE, 2µm MINIMUM MATTE TIN OVER 1.27µm MINIMUM NICKEL UNDERPLATE.
 - b - MANUFACTURING PROCESS COMPATIBILITY
- THE HOUSING WILL WITHSTAND EXPOSURE TO 260°C PEAK TEMPERATURE FOR 30 SECONDS MAX IN A CONVECTION, INFRA-RED OR VAPOR PHASE OR REFLOW OVEN.
 - c - LABELING:
- MEETS PACKAGING SPECS AS PER GS-14-920
 - d - LEGAL STATEMENT: SEE GS-47-0004
- 8 - THIS PART SERIES IS NOT INITIALLY INTENDED FOR AUTOMOTIVE APPLICATIONS. ADDITIONAL FEES ARE CHARGEABLE FOR ANY ADDITIONAL QUALIFICATION AND TEST REPORTS PERFORMED OUTSIDE THE SCOPE OF THE STANDARD PRODUCT SPECIFICATIONS.
- 9 - UNLESS OTHERWISE APPROVED BY AMPHENOL, ALL PARTS AND COMPONENTS ARE DESIGNED & BUILT ACCORDING TO AMPHENOL'S SPECIFICATIONS WHICH ARE SUBJECT TO CHANGE WITHOUT NOTICE.

EXTENDED RANGE

- TOOLING FEASIBILITY CONFIRMED
- SAMPLES ON DEMAND
- AVAILABILITY ON DEMAND

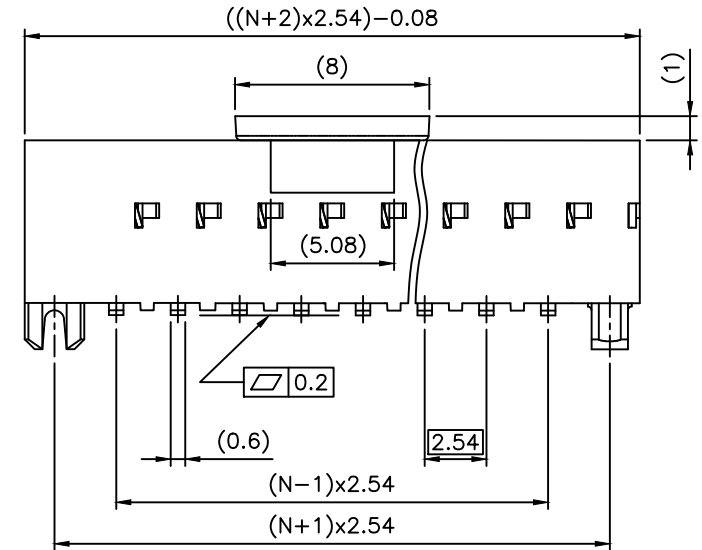
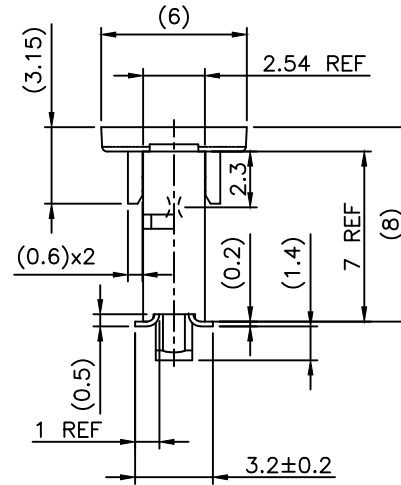
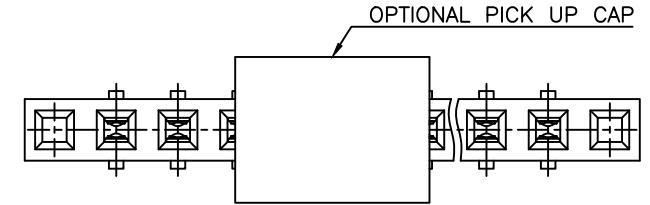

mat'l. code				surface		tolerance		projection		product family	
SEE NOTES				ISO 1302		ISO 406 ISO 1101		DUBOX		DUBOX	
ltr	ecn no	dr	date	tolerances unless otherwise specified		mm		title		BtB RECEPT.	
AF	F-41245	DDE	21.06.17	angles	linear	.X ±0.3	scale 1:1	VERT SR SMT		sheet 1 of 2	
AF	F-54525	DDE	25.02.06	±2'		.XX ±0.15		91614		A3	
AB	B-15631	JCO	13.07.26	dr	D.LEGRAND	02.01.31	dwg no		size		
AC	B-16805	JCO	14.01.21	enfr	P.NIZZI	02.01.31	91614		A3		
AD	B-19123	LMU	14.10.21	chr	D.LEGRAND	02.01.31	type		Drawing		
AE	B-19716	BVE	14.12.11	appd	P.NIZZI	02.01.31	CUSTOMER		Drawing		
sheet	revision	AF	C								
index	sheet	1	2								

A

B

C

D

A

B

C

D

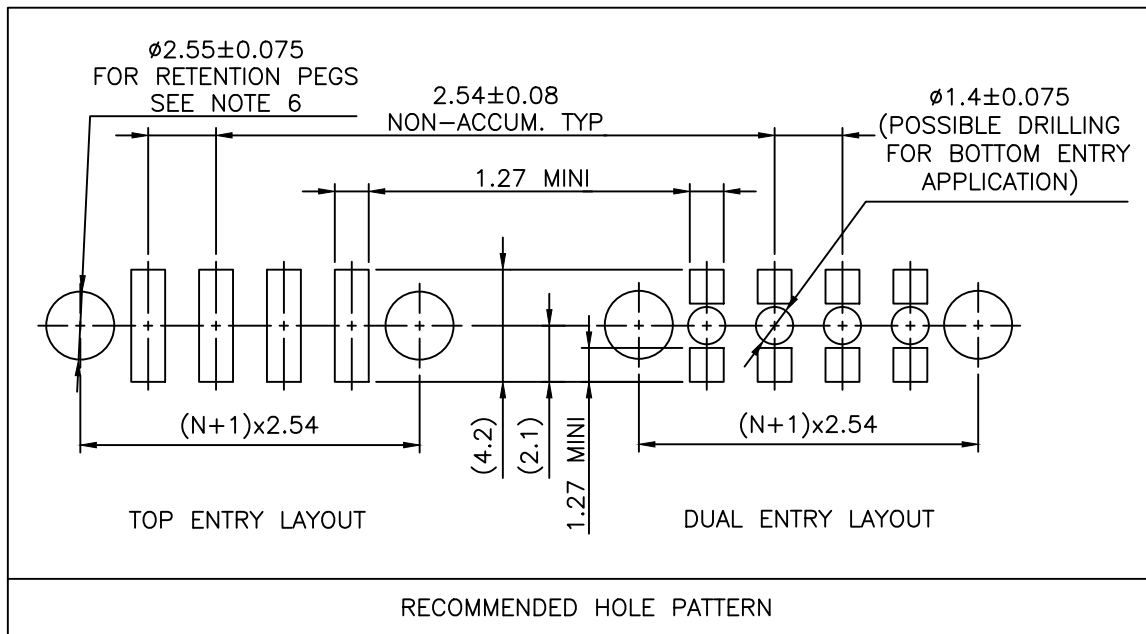

RECOMMENDED HOLE PATTERN

Amphenol FCI FCIconnect.com

Copyright FCI

mat'l. code SEE NOTES				surface ISO 1302 <input checked="" type="checkbox"/>	tolerance ISO 406 ISO 1101	projection 	product family DUBOX
ltr	ecn no	dr	date	tolerances unless otherwise specified		mm 	title
A	F04-0347	DLE	04.11.10	angles	linear ± 0.3		BtB RECEPT. VERT SR SMT
B	F06-0204	DLE	06.06.23	$\pm 2'$			
C	F-54525	DDE	25.02.06			scale 1:1	dwg no 91614
				dr	D.LEGRAND	04.11.10	sheet 2 of -
				enr	P.NIZZI	04.11.10	size A3
				chr	D.LEGRAND	04.11.10	type CUSTOMER Drawing
				appd	P.NIZZI	04.11.10	
sheet index	revision sheet						