

H
G
F
E
D
C
B
A

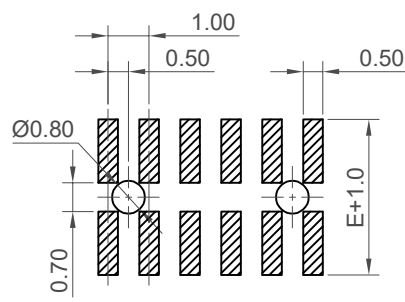

Recommended PCB Layout
Tolerance: ±0.05
Solder Area

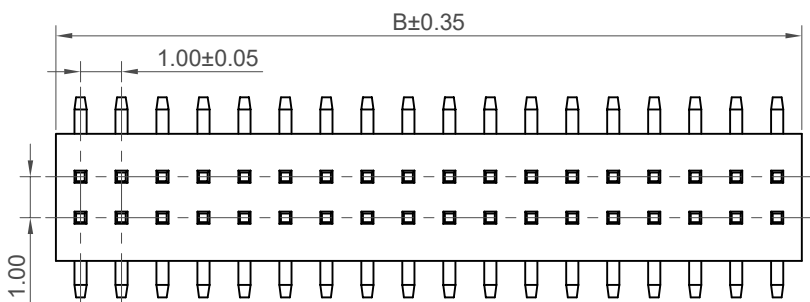
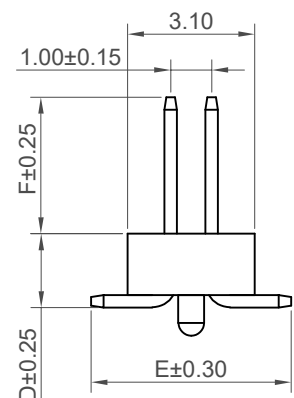
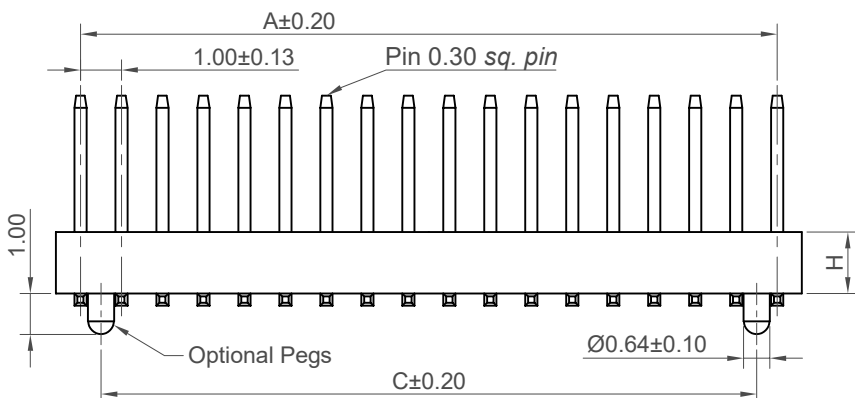
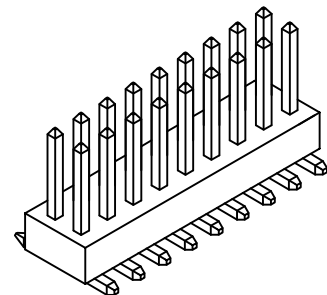

*Note: TPL=total pin length F + D + (E-1)/2
5mm ≤ TPL ≤ 12mm

Number of Contacts	Dimensions		
	A	B	C
4	1.00	2.00	---
6	2.00	3.00	---
8	3.00	4.00	---
10	4.00	5.00	3.00
12	5.00	6.00	4.00
14	6.00	7.00	5.00
16	7.00	8.00	6.00
18	8.00	9.00	7.00
20	9.00	10.00	8.00
22	10.00	11.00	9.00
24	11.00	12.00	10.00
26	12.00	13.00	11.00
28	13.00	14.00	12.00
30	14.00	15.00	13.00
32	15.00	16.00	14.00
34	16.00	17.00	15.00
36	17.00	18.00	16.00
38	18.00	19.00	17.00
40	19.00	20.00	18.00
42	20.00	21.00	19.00
44	21.00	22.00	20.00
46	22.00	23.00	21.00
48	23.00	24.00	22.00
50	24.00	25.00	23.00
52	25.00	26.00	24.00
54	26.00	27.00	25.00
56	27.00	28.00	26.00
58	28.00	29.00	27.00
60	29.00	30.00	28.00
62	30.00	31.00	29.00
64	31.00	32.00	30.00
66	32.00	33.00	31.00
68	33.00	34.00	32.00
70	34.00	35.00	33.00
72	35.00	36.00	34.00
74	36.00	37.00	35.00
76	37.00	38.00	36.00
78	38.00	39.00	37.00
80	39.00	40.00	38.00

Specifications

Material

Insulator: Polymer LCP, UL94V-0, Black
Contact: Copper Alloy

Plating

Gold Flash All Over

Electrical

Current Rating: 1 Amp Per Pin
Contact Resistance: 20 mΩ max.
Insulation Resistance: 1000 MΩ min.
Dielectric Withstand Voltage: 300V AC

Mechanical & Environmental

Operating Temperature: -40°C to +125°C
Soldering Process:
IR Reflow: 260°C for 10 sec.
Manual Solder: 350°C for 3-5 sec.

Mates with (Subject to pin length)

BC084 BC085

Ordering Grid

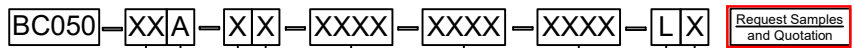

No. of Contacts
04 to 80

Contact Plating
A = Gold Flash All Over

Insulator Height 'H'
K = 1.00mm (Standard)
A = 1.50mm

Locating Peg
0 = No Peg
1 = With Peg

Dimension F (1/100mm) (Post Height)
0200 = 2.00mm (Standard)
0380 = 3.80mm (Standard)
or specify custom post height
e.g. 0250 = 2.50mm
(Maximum 0500=5.00mm)
(Minimum 0150=1.50mm, Packing option code B, E)
(Minimum 0100=1.00mm, Packing option code D, G)

Packing Options
B = Tape & Reel with Cap (Standard)
D = Tube (Available in 08-80 contacts)
E = Tube with Cap (Available in 08-80 contacts)
G = Plastic Box (Available in 04-06 contacts)

Insulator Material
L = LCP

Dimension E (1/100mm) (Footprint Width)
0480 = 4.80mm (Standard)
or specify custom footprint width
(Minimum 0360=3.60mm)
e.g. 0360 = 3.60mm
(Tooling charge may apply)

Dimension D (1/100mm) (Top of Insulator to Bottom of Pin)
0160 = 1.60mm (Standard when H=K)
0200 = 2.00mm (Standard when H=A)
or specify custom length
e.g. 0250 = 2.50mm
(Minimum 0140=1.40mm when H=K)
(Minimum 0190=1.90mm when H=A)

Part Number		Product Description	
BC050		1.0mm Pitch Pin Header, Dual Row, Surface Mount, Vertical	
Drawing Date		20th May 2008	
By	MW	Tolerances (Except as Noted)	Units: Metric (mm)
Detail	BC050 F PCN	Length: X. ± 0.30	Angle: X° ± 5°
Revision	F8	X.X ± 0.25	X.XX° ± 3°
Date	29/12/25	X.XX ± 0.15	X.XX° ± 2°
		X.XXX ± 0.10	X.XXX° ± 1°



This drawing is confidential and copyright of Global Connector Technology, Ltd (GCT). This drawing must not be copied or disclosed without written consent. E & OE



Not to Scale	Drawn By ASE	Sheet No. 1/1
--------------	--------------	---------------