

**EXTENDED RANGE**

- TOOLING FEASIBILITY CONFIRMED
- SAMPLES ON DEMAND
- AVAILABILITY ON DEMAND

PRODUCT DESCRIPTION CODE:  
10131937-YXXXXLF

- PLATING: (AS AVAILABLE)
- 1 = 0.76 μm GOLD ON CONTACT AREA  
2.00 μm MIN MATTE TIN ON TAIL
  - 2 = 0.38 μm GOLD ON CONTACT AREA  
2.00 μm MIN MATTE TIN ON TAIL
  - 3 = 0.20 μm GOLD ON CONTACT AREA  
2.00 μm MIN MATTE TIN ON TAIL
  - 4 = 0.76 μm GXT ON CONTACT AREA  
2.00 μm MIN MATTE TIN ON TAIL
  - 5 = 0.38 μm GXT ON CONTACT AREA  
2.00 μm MIN MATTE TIN ON TAIL
  - 6 = 0.20 μm GXT ON CONTACT AREA  
2.00 μm MIN MATTE TIN ON TAIL
  - 9 = 2.54 μm MIN MATTE TIN ON CONTACT AREA  
2.00 μm MIN MATTE TIN ON TAIL

- RoHS COMPATIBLE, SEE NOTE 3
- "V" : OPTION CUSTOMER DEDICATED PART
- PACKAGING: (MAY BE SUBJECT TO TOOLING FEES)
- "A" : TAPE & REEL WITH CAP
  - "K" : TAPE & REEL WITHOUT CAP
  - "U" : TUBE
  - "B" : TUBE WITH CAP
  - "R" : TAPE & REEL REVERSE  
SMT LEGS ON TOP WITHOUT CAP

TOTAL NUMBER OF POSITIONS: 04 TO 50

1.27 μm NICKEL MIN UNDERLAYER

NOTES :

- MATERIAL  
HOUSING : HIGH TEMPERATURE GLASS FILLED FLAME  
RETARDANT PER UL 94 V-0  
TERMINAL: COPPER ALLOY
- TO DETERMINE DIMENSIONS :  
N = NUMBER OF POSITIONS PER ROW  
EXAMPLE : 8 POS N x 2 = 16mm  
UP TO N = 24 TOLERANCE : 0  
-0.10  
FROM N = 26 TOLERANCE : 0.05  
-0.10
- RoHS COMPATIBLE PRODUCT SPECIFICATIONS
  - PLATING :  
"LF" MEANS THE PRODUCT IS LEAD-FREE, 2 μm MINIMUM  
MATTE TIN OVER 1.27 μm MINIMUM NICKEL UNDERPLATE
  - MANUFACTURING PROCESS COMPATIBILITY  
THE HOUSING WILL WITHSTAND EXPOSURE TO 260°C PEAK  
TEMPERATURE FOR 30 SECONDS MAX IN A CONVECTION,  
INFRA-RED OR VAPOR PHASE OR REFLOW OVEN
  - LABELLING :  
MEETS PACKAGING SPECS AS PER GS-14-920
  - LEGAL STATEMENT : SEE GS-47-0004
- THIS PART SERIES IS NOT INITIALLY INTENDED FOR  
AUTOMOTIVE APPLICATIONS. ADDITIONAL FEES ARE  
CHARGEABLE FOR ANY ADDITIONAL QUALIFICATION AND  
TEST REPORTS PERFORMED OUTSIDE THE SCOPE OF THE  
STANDARD PRODUCT SPECIFICATIONS.
- UNLESS OTHERWISE APPROVED BY AMPHENOL, ALL PARTS  
AND COMPONENTS ARE DESIGNED & BUILT ACCORDING TO  
AMPHENOL'S SPECIFICATIONS WHICH ARE SUBJECT TO  
CHANGE WITHOUT NOTICE.

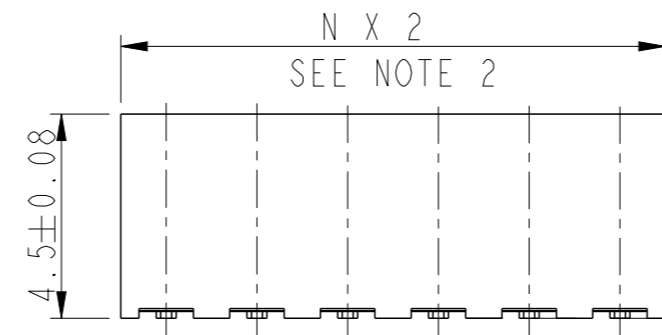
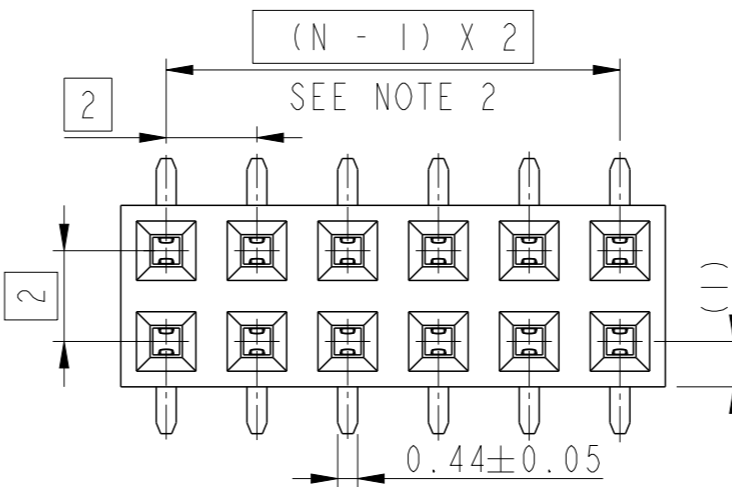
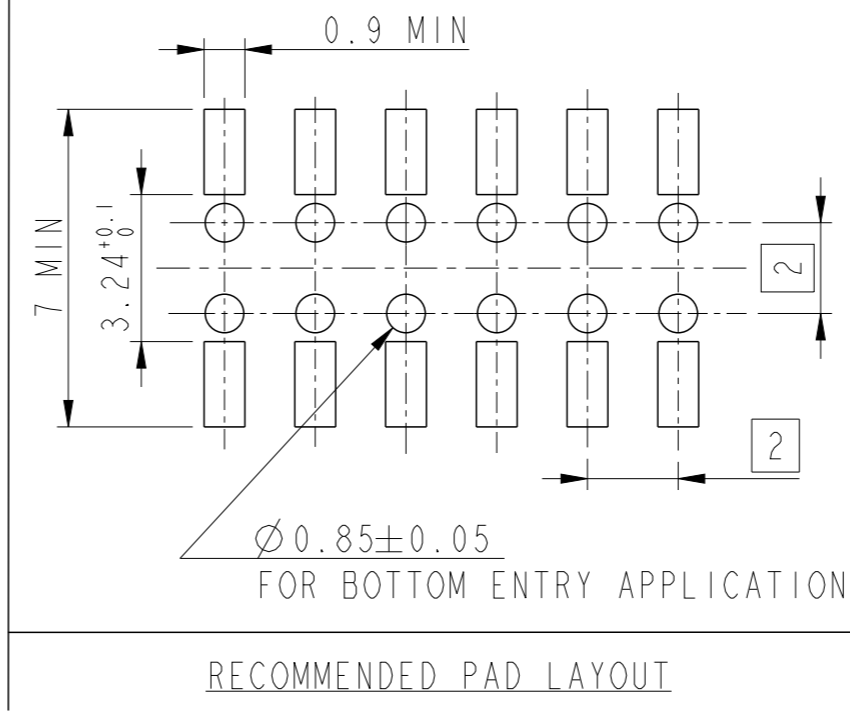

	0.1	< 24 POS
	0.15	> 24 POS

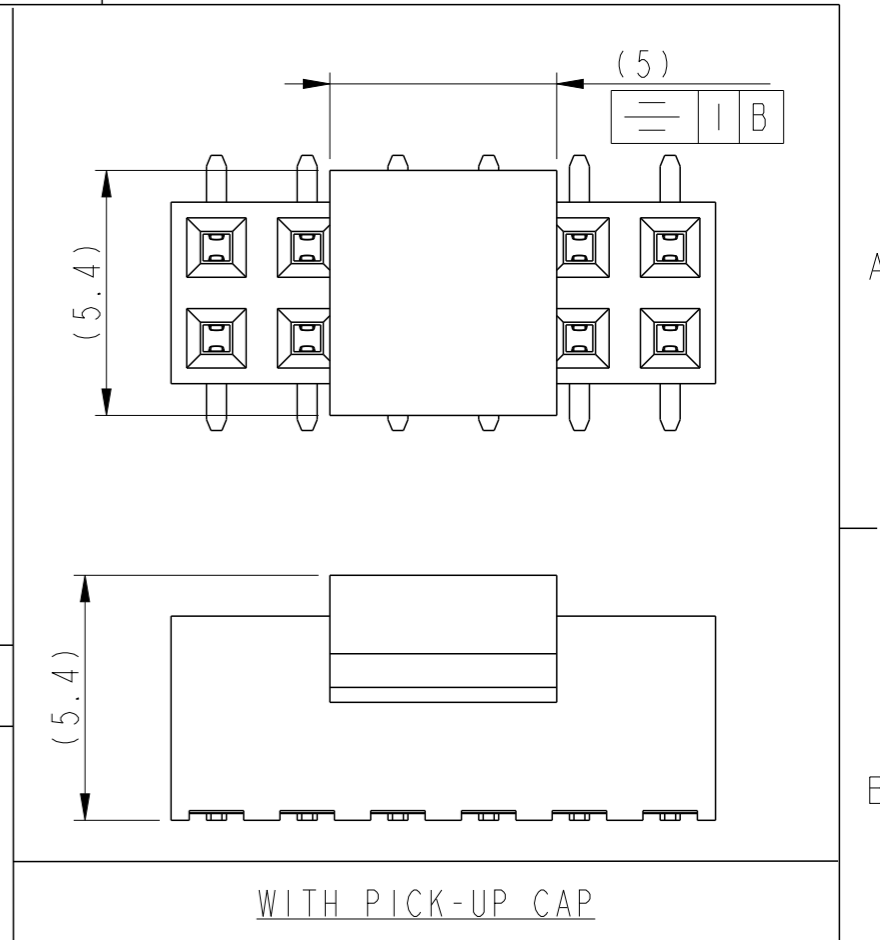

Charateristic	Symbol	Quantity
Special	<C>	0
Control		0

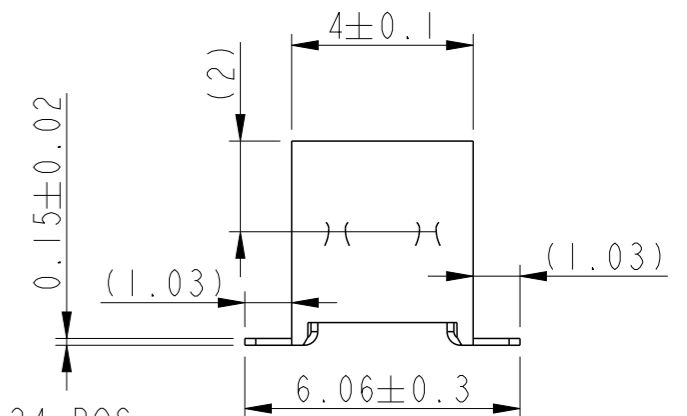

spec ref	GS-12-1326	dr	Cyril Jeune	2014/12/02	projection	mm	size	A3	scale	6:1
tolerance std	ISO 406 ISO 1101	eng	Detouillon, Da	2025/02/05		mm	ecn no	ELX-F-54311-1	rel level	Released
TOLERANCES UNLESS OTHERWISE SPECIFIED		chr	-	apppr						
surface	linear	0.X	±	<b>Amphenol FCI</b>	MINITEK RECEPTACLE 2MM ASSEMBLY VCC DR SMT	dwg no	10131937	rev	C	www.fci.com
		0.XX	±							
		0.XXX	±							
	angular	0°	±°	cat. no.	-	Product - Customer Drw	sheet 1 of 1			