

PRODUCT NUMBER
98417-XXX-XX-XXXLF

PLATING
(AS AVAILABLE)

G = 0.76µm GOLD/GXT
ON CONTACT AREA
2.0µm MATTE TIN
ON TAILS.

S = 0.38µm GOLD/GXT
ON CONTACT AREA
2.0µm MATTE TIN
ON TAILS.

T = 2.0-6.0µm FULL MATTE TIN

1.27µm Ni MIN UNDERLAYER

LEAD FREE
RoHS COMPATIBLE, SEE NOTE 8
POLARIZATION, SEE NOTE 7
(AS AVAILABLE)

PACKAGING OPTION, SEE NOTE 5
(MAY BE SUBJECT TO TOOLING FEES)

TOTAL NB OF POSITIONS, 06 TO 50

PIN STYLE, SEE TABLE
(AS AVAILABLE)

STYLE	SOLDER TAIL
51	2.00
61	2.50

NOTES:

- MATERIAL HOUSING: HIGH TEMP. THERMOPLASTIC LCP
UL 94V-0, COLOR CREAM, MEETS GWT 850°C-960°C.
- MATERIAL TERMINAL: COPPER ALLOY
- TO DETERMINE DIMENSIONS:
N = NUMBER OF POSITIONS PER ROW
- 7N MIN. PIN RETENTION IN EITHER DIRECTION.

5. PACKAGING:

- = PLASTIC BOX
- = PLASTIC BOX WHEN POLARISATION FEATURE APPLICABLE
- U = TUBE PACKAGING AVAILABLE FROM 06 TO 50 POS
- K = TAPE & REEL PACKAGING WITHOUT PICK UP CAP, AS AVAILABLE
- UV = TUBE WITHOUT PICK UP CAP FOR VALEO
- KV = TAPE & REEL WITHOUT PICK UP CAP FOR VALEO

6. DIM "C" = (N x 2) + 1.4

EXAMPLE : N = 7
DIM "C" = (7 x 2) + 1.4 = 15.4 mm

7. FOR POLARIZATION, SPECIFIED PIN

EXAMPLE: A03= ROW A, POSITION 03 TO OMIT PIN
OMIT FROM PRODUCT NUMBER IF THIS FEATURE IS NOT APPLICABLE

8. RoHS COMPATIBLE PRODUCT SPECIFICATIONS

- PLATING:**
 - "LF" MEANS THE PRODUCT IS LEAD-FREE,
2µm MINIMUM MATTE TIN OVER 1.27µm
MINIMUM NICKEL UNDERPLATE.
- MANUFACTURING PROCESS COMPATIBILITY**
 - THE HOUSING WILL WITHSTAND EXPOSURE TO
260°C ±5°C SOLDER BATH TEMPERATURE FOR
5 SECONDS IN A WAVE SOLDER APPLICATION
WITH A 1.6mm MIN THICK CIRCUIT BOARD.
 - COMPATIBLE 260°C REFLOW PROCESS
- LABELLING:**
 - MEETS PACKAGING SPECS AS PER GS-14-920
- THIS PRODUCT MEETS EUROPEAN DIRECTIVES
AND OTHER COUNTRY REGULATIONS AS DISCRIBED
IN GS-47-0004

9. LOCATION OF CAVITIES MOULD IDENTIFICATION

10. THIS PART SERIES IS NOT INITIALLY INTENDED FOR
AUTOMOTIVE APPLICATIONS. ADDITIONAL FEES ARE
CHARGEABLE FOR ANY ADDITIONAL QUALIFICATION AND
TEST REPORTS PERFORMED OUTSIDE THE SCOPE OF THE
STANDARD PRODUCT SPECIFICATIONS.

11. UNLESS OTHERWISE APPROVED BY AMPHENOL, ALL PARTS
AND COMPONENTS ARE DESIGNED & BUILT ACCORDING TO
AMPHENOL'S SPECIFICATIONS WHICH ARE SUBJECT TO
CHANGE WITHOUT NOTICE.

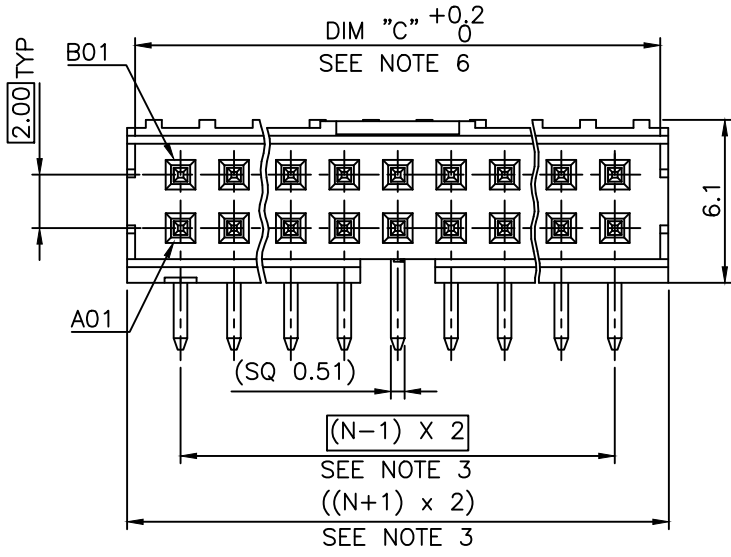

EXTENDED RANGE
- TOOLING FEASIBILITY CONFIRMED
- SAMPLES ON DEMAND
- AVAILABILITY ON DEMAND

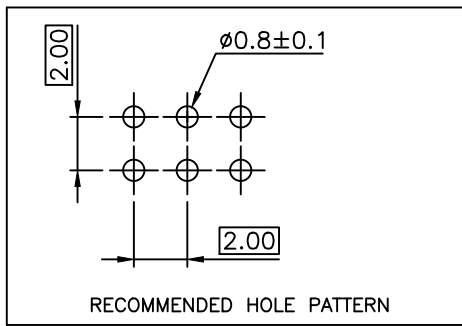
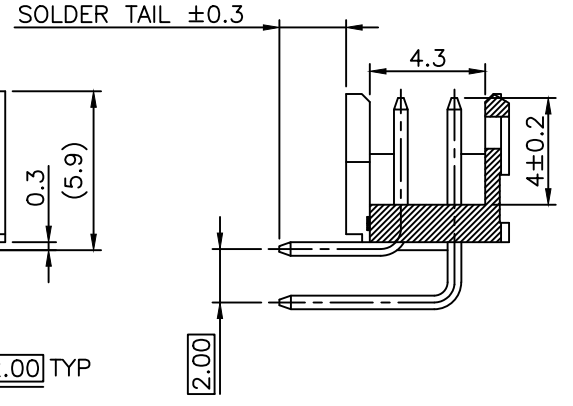
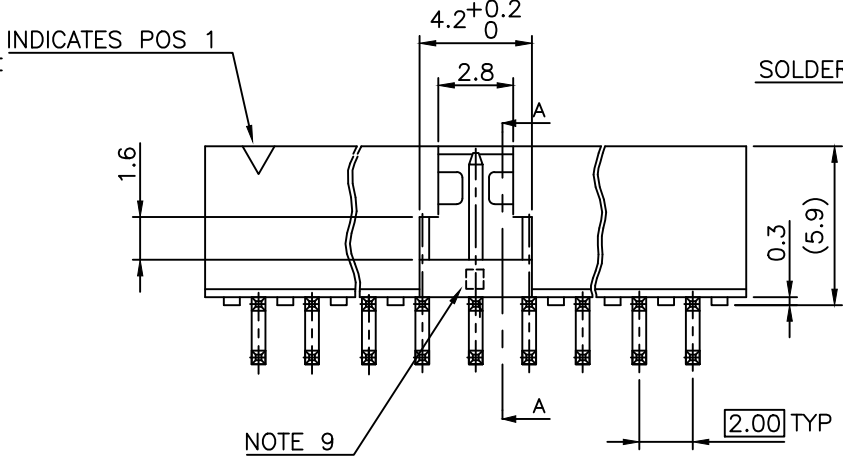
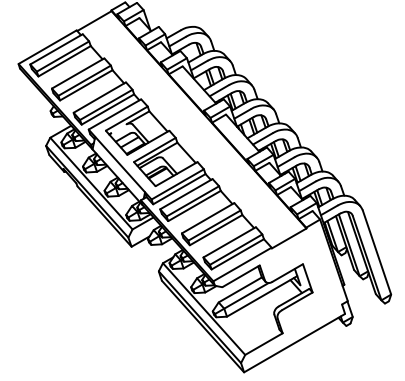

mat'l. code		surface		tolerance		projection	product family		
SEE NOTES		ISO 1302	✓	ISO 406	ISO 1101		MINITEK		
ltr	ecn no	dr	date	tolerances unless otherwise specified		mm	title		
H	F-23051	AMA	16.01.15	angles	linear		SHROUDED HEADER		
J	F-54489	DDE	25.02.05				2.00 RA REVERSED		
						scale 1:1	dwg no		
D	B-19190	LMU	14.10.24	dr	L.MULIN	07.11.26	sheet 1 of 2		
E	B-20201	BVE	15.02.05	engr	J.COMPAGNON	07.11.26	size		
F	B-20254	LMU	15.02.16	chr			98417		
G	F-21929	AMA	15.09.15	appd	JM.C	08.02.14	A3		
sheet	revision	J	B						
index	sheet	1	2						

Amphenol
FCI
FCIconnect.com

Copyright FCI

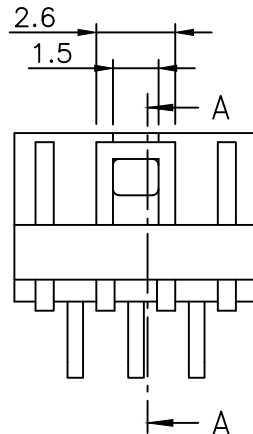
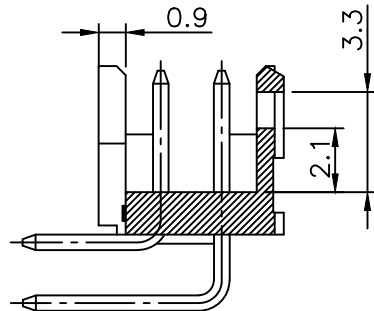
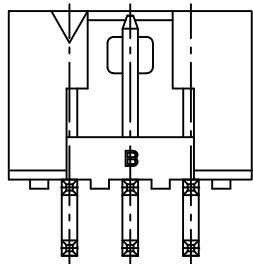

LATCHING FEATURES FOR 2x3 POS AND 2x4 POS
NO LATCHING AVAILABLE FOR 2x2 POS

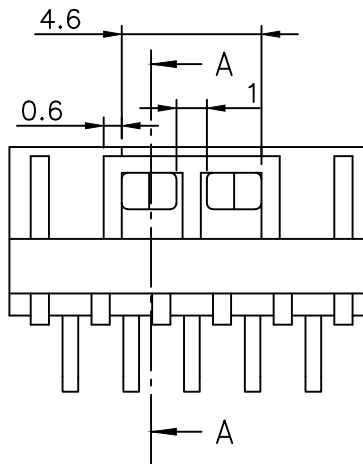
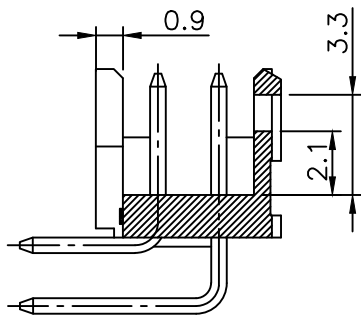
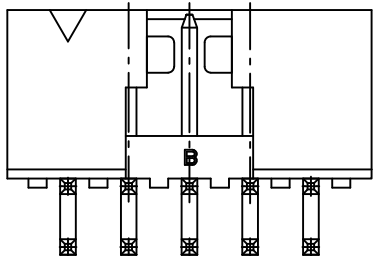

LATCHING FEATURES FOR 2x5 POS UP TO 2x25 POS

Amphenol
FCI
FCIconnect.com

Copyright FCI

mat'l. code SEE NOTES				surface ISO 1302	tolerance ISO 406 ISO 1101	projection mm	product family MINITEK
ltr	ecn no	dr	date	tolerances unless otherwise specified		mm	title SHROUDED HEADER 2.00 RA REVERSED
A	B-18376	JCO	14.07.23	angles	.x ± 0.3		
B	F-54489	DDE	25.02.05	linear	.xx ± 0.15		
					xxx ± 0.05	scale 1:1	dwg no 98417
				dr	L.MULIN	14.07.21	sheet 2 of 2
				engr	J.COMPAGNON	14.07.21	size A3
				chr			type CUSTOMER Drawing
				appd	JM.C	14.07.21	
sheet index	revision sheet						