

**Technical specification/  
Technische Daten:**

Working voltage/ Betriebsspannung:	60 V AC/DC
Insulation resistance/ Isolationswiderstand:	min. 3000 MOhm
Dielectric withstanding voltage/ Spannungsfestigkeit:	1000 V AC / minute
Operating temperature/ Betriebstemperatur:	- 55 °C ... + 105 °C
Current rating/ Strombelastbarkeit:	3 A
Contact Resistance/ Durchgangswiderstand:	max. 15 mOhm

**Materials/  
Werkstoffe:**

Contact/ Kontakt:	Cu alloy, Underplate/ 50 µin Nickel Beschichtung: Contact area/ Kontaktbereich:	Gold flash
	Solder tails area/ Lötbereich:	Gold flash
Shell/ Gehäuse:	Steel, Nickel plated	
Rivet, Boardlock/ Befestigungsniet:	Copper alloy	
Insulator/ Isolierkörper:	Thermal plastic UL 94 V-0	

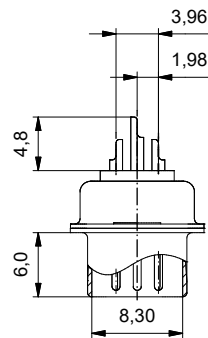
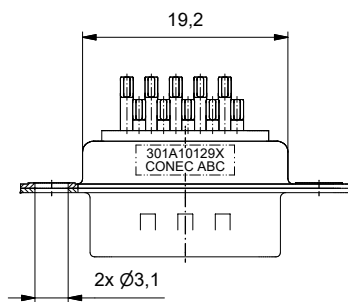
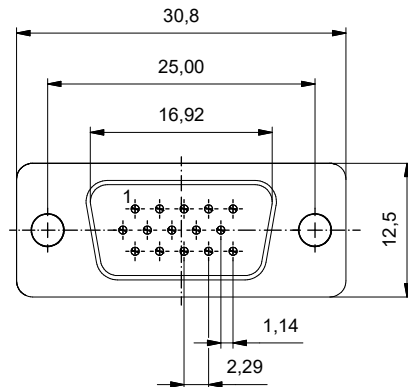

Part no. / Part marked/  
Art.-Nr. / Bedruckung:

301A10129X

general tolerance/ Allgemeintoleranz:	0 ± 0,5 mm	Date/Datum	Name	D-SUB HD Male 15pos. solder cup stamped contacts D-SUB HD Stift 15pol. Lötkehlch mit gestanzten Kontakten					
	0,0 ± 0,3 mm						drawn/ ges.	04.07.2022	Bub
	0,00 ± 0,2 mm						appd./ gepr.	22.08.2022	Lehmenkühler
Index: b	28.08.2025	JLE	Scale/Maßstab:	2:1	dwg no / Z.-nr.:	16K1A1570	DIN-A3		
							1 / 1		

The reproduction, distribution and sale of this document as well as the communication of its content to others without express authorization is prohibited. Offenders will be held liable for the payment of damages. We reserve the right to withdraw or amend this document. The appearance of errors in this document is expressly disclaimed. In the event of a discrepancy between this document and the original, the original shall prevail.