

⑤ **USB 2.0 COMPLIANT**

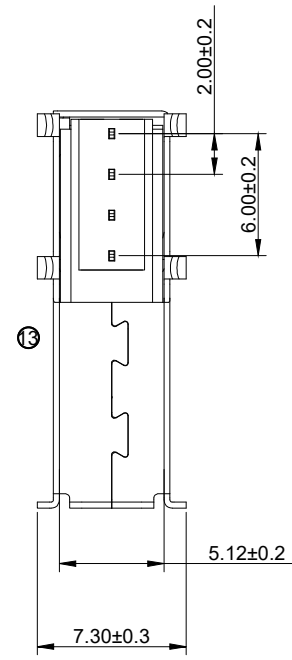

NOTES:

- ⑫ 1. Material:
 - 1.1 Housing: PBT+30%GF UL94V-0, LCP+30%GF UL94V-0,
 - 1.2 Cover: PBT +30%GF UL94V-0, LCP+30%GF UL94V-0,
 - ⑬ 1.3 Shell: Copper Alloy C2680
 - ⑬ 1.4 Contact :Copper Alloy C2680
- 2. FINISH:
 - 2.1 Contact Area: 1u"Au-flash/Selective 30u"Au/Selective
 - Solder Area: Tin Plated
 - Under: Ni Plated
- 3. MECHANICAL:
 - 3.1 Mating Force: 3.57kgf Max.
 - 3.2 Unmating Force: 1.02kgf Min
 - 3.3 Durability: 1500 cycles Min
- 4. ELECTRICAL:
 - 4.1 Current Rating: 1.5A
 - 4.2 Dielectric Strength: 500V AC FOR 1 MINUTE
 - ⑥ 4.3 Contact Resistance: 30mΩ Max
 - 4.4 Insulation Resistance: 1000 MΩ Min
 - ⑩ 4.5 Voltage Rating: 30VAC
 - 5. Operating temperature: -55°C TO +85°C
 - ⑩ 6. For wave soldering temperature : 235°C, 5sec max
 - ⑫ For reflow soldering temperature: 260°C, 5sec max
 - ⑫ 7. PACKING: Tray

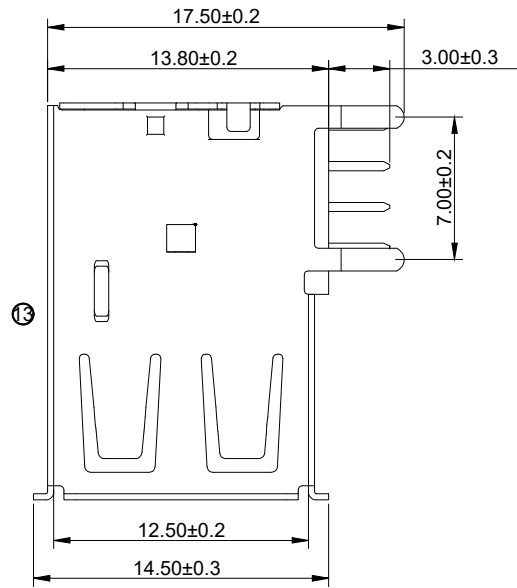
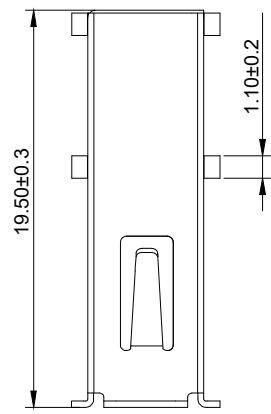
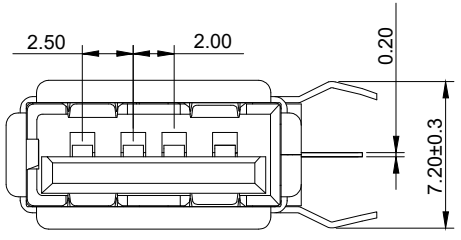
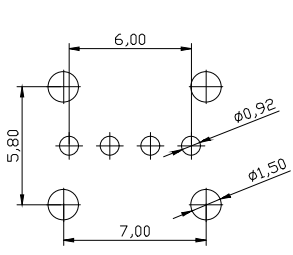

RECOMMENDED PCB LAYOUT(TOP VIEW)
GENERAL TOLERANCES: ±0.05

⑫⑬	WSW-P/N	Plating	Housing /Cover	Soldering Style
	A-USB A-E	Gold Flash Selective Tin	PBT+30%GF(White)	THT(Wave soldering)
	A-USB A-E-BK		PBT+30%GF(Black)	THT(Wave soldering)
	A-USB A-E-THR		LCP+30%GF(White)	THR(Reflow soldering)
	A-USB A-E-THR-BK	30u"Gold Selective Tin	LCP+30%GF(Black)	THR(Reflow soldering)
	A-USB/2-A-E		PBT+30%GF(White)	THT(Wave soldering)
	A-USB/2-A-E-BK		PBT+30%GF(Black)	THT(Wave soldering)
	A-USB/2-A-E-THR		LCP+30%GF(White)	THR(Reflow soldering)
	A-USB/2-A-E-THR-BK		LCP+30%GF(Black)	THR(Reflow soldering)

G	<p>RoHS compliant Unit:mm</p>	Scale	Free	⑬ Update	26.05.2021	Luca	Date	Name	Description: USB 2.0 Connector Female / A-type / 4Pin / Side 90°			
		TOLERANCE		⑫ Update	26.11.2020	Luca				Drawn	26.01.2005	Hellwig
		X.X	±0.3	① Update PN	17.11.2020	Luca				Approved	26.05.2021	Luca
		X.XX	±0.2	⑩ Update	31.10.2019	Carson				ASSMANN WSW-No. A-USB A-E-x-x A-USB/2-A-E-x-x ⑫		
		X.XXX	±0.1	⑨ Update dimension	14.03.2019	Winnie				Drawing-No.		
		DIM	TOL	⑧ Update Pin-number on recom. PCB	05.09.2017	S.Bölling				ASS 1413B CO	rev13	
H		ANG.	±5°						Customer-No.			
		Angle	TOL	Id.	Modification	Date	Name		SHEET			