

61083- AA B C D E G W V FF

AA	NO. OF POSITIONS
02	2X10
04	2X20
06	2X30
08	2X40
10	2X50
12	2X60
14	2X70
16	2X80
18	2X90
20	2X100

NOTE 10

E	PACKAGING
0	TUBE WITHOUT METAL CAP
2	T&R WITH METAL CAP
6	T&R WITH KAPTON TAPE
7	T&R WITH PLASTIC CAP
9	TUBE WITH METAL CAP
Q	T&R WITHOUT CAP
T	TRAY WITH METAL CAP

NOTE 10

NOTE 10

NOTE 10

NOTE 11

G	DATE CODE
/	STANDARD, NOT PRINT D/C
P	PRINT DATE CODE

W	TRANSPORT CODE
/	NOT MANDATORY
W	FOR OCEAN SHIPPING

V	MANDATORY CODE
/	STANDARD, NOT MANDATORY P/N
C	ONLY FOR DEDICATED CUSTOMER
H	ONLY FOR DEDICATED CUSTOMER
L	ONLY FOR DEDICATED CUSTOMER
V	ONLY FOR DEDICATED CUSTOMER

D	PEG
0	YES
2	NO

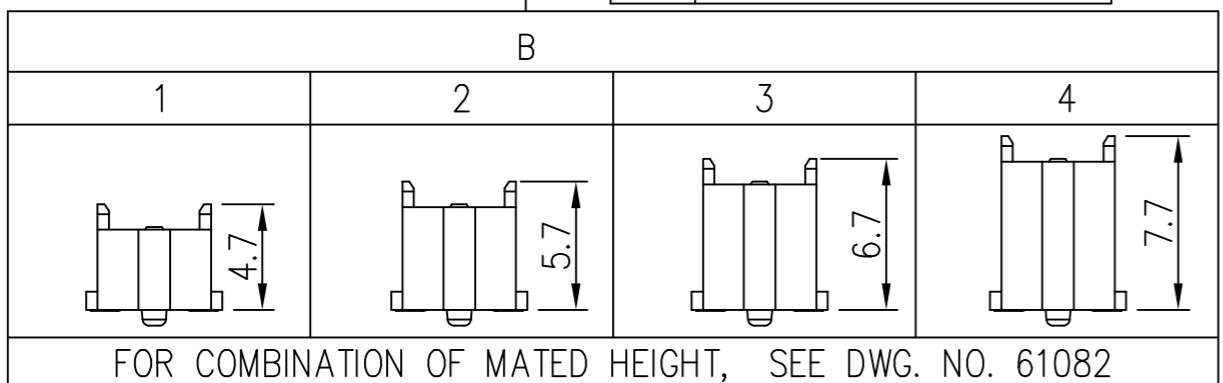

C	PLATING ON CONTACT AREA / ON SOLDER TAIL AREA	FF
0	GOLD 0.2μm MIN. ON CONTACT AREA / TIN LEAD 2.5μm MIN ON SOLDER TAIL	NONE
1	GOLD FLASH (0.065μm MIN) OVER PALLADIUM-NICKEL 0.69μm MIN ON CONTACT AREA / TIN LEAD 2.5μm MIN ON SOLDER TAIL	NONE
4	GOLD 0.2μm MIN ON CONTACT AREA / MATTE TIN 2.5μm MIN ON SOLDER TAIL	LF
5	GOLD 0.38μm MIN ON CONTACT AREA / MATTE TIN 2.5μm MIN ON SOLDER TAIL	LF
6	GOLD FLASH 0.065μm MIN OVER PALLADIUM-NICKEL 0.69μm MIN ON CONTACT AREA / MATTE TIN 2.5μm MIN ON SOLDER TAIL	LF
7	GOLD 0.76μm MIN ON CONTACT AREA / MATTE TIN 2.5μm MIN ON SOLDER TAIL	LF
9	GOLD 0.2μm MIN ON CONTACT AREA / GOLD 0.05μm MIN ON SOLDER TAIL	LF
B	GOLD 1.27μm MIN ON CONTACT AREA / GOLD 0.05~0.25μm ON SOLDER TAIL	LF
C	GOLD 1.27μm MIN ON CONTACT AREA / MATTE TIN 2.5μm MIN ON SOLDER TAIL	LF
D	GOLD 0.38μm MIN ON CONTACT AREA / GOLD FLASH ON SOLDER TAIL	LF

- NOTE:
- MATERIAL:
HOUSING: LCP, NATURAL, UL94-V0, MSL LEVEL 1
TERMINAL: COPPER ALLOY
 - PLATING: AS SHOWN IN TABLE. NICKEL UNDERPLATE OVERALL 1.27μm MIN.
 - SEE GS-12-547 FOR PRODUCT SPEC.
 - PACKAGING OPTION 2: NOT ALL SIZES ARE AVAILABLE. CHECK WITH FACTORY.
 - THIS PRODUCT MEETS THE EUROPEAN UNION DIRECTIVES AND OTHER COUNTRY REGULATIONS AS DESCRIBED IN GS-22-008.
 - THE HOUSING WILL WITHSTAND EXPOSURE UP TO 260°C PEAK TEMPERATURE FOR 30 SECONDS IN A CONVECTION, INFRA-RED OR VAPOR PHASE REFLOW OVEN.
 - PLATING OPTION "4" IS LEADFREE ALTERNATIVE FOR OPTION "0", AND OPTION "6" IS LEADFREE ALTERNATIVE FOR OPTION "1".
 - HIGH PRECISION COPLANARITY IS AVAILABLE FOR 2X80 TO 2X100 POS, ALL HEIGHTS. PLS REFER TO PRINT 10069525.
 - THE P/N 61083-***** OR 61083-*****LF NOT PRINT DATE CODE.
THE P/N 61083-*****P OR 61083-*****PLF NEED PRINT DATE CODE.
 - PACKAGING WITH METAL CAP AND PLASTIC CAP DOES NOT APPLY TO 2X10 POSITION.
 - PACKAGING OPTION "TRAY WITH METAL CAP" ONLY APPLY TO PLUG 1 200P.

mat'l. code		surface		tolerance		projection		product family											
ltr	ecn no	dr	date	ISO 1302	ISO 406	ISO 1101	specified	BERGSTAK HPL545											
AP	ELX-N-33922	Bob	2019-07-05	angles				title											
AR	ELX-N-34967	Bob	2019-09-26	linear	.0±.2		mm	PLUG ASSY											
AS	ELX-N-35593	Bob	2020-01-10	0°±3'	.00±.15		scale 1:1	BERGSTAK 0.8MM											
AT	ELX-N-37512	Bob	2020-06-28	dr	.000±.10			dwg no	sheet 1 of 6										
AU	ELX-N-49334	Alan	2023-12-18	engr				61083	size A3										
AV	ELX-N-54701	Alan	2025-02-18	chr				type Product Customer Drawing											
AW	ELX-N-55682	Alan	2025-06-26	appd															
sheet index	revision sheet	AL	AM	AN	AP	AR	AS	AT	AU	AV	AW								
		1~6	1~6	1~6	1	1	1	1	1	1	1~6								

PRODUCT NO.	NO. OF POSITION	DIMENSION		
		A	B	C
61083-021***	2X10	7.2	13.8	12.2
61083-041***	2X20	15.2	21.8	20.2
61083-061***	2X30	23.2	29.8	28.2
61083-081***	2X40	31.2	37.8	36.2
61083-101***	2X50	39.2	45.8	44.2
61083-121***	2X60	47.2	53.8	52.2
61083-141***	2X70	55.2	61.8	60.2
61083-161***	2X80	63.2	69.8	68.2
61083-181***	2X90	71.2	77.8	76.2
61083-201***	2X100	79.2	85.8	84.2

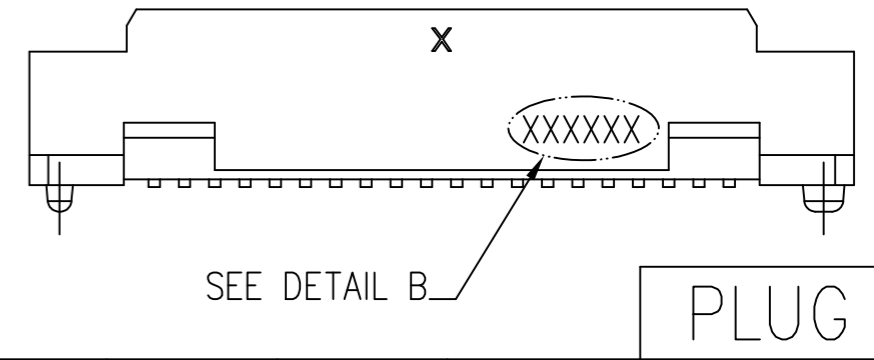
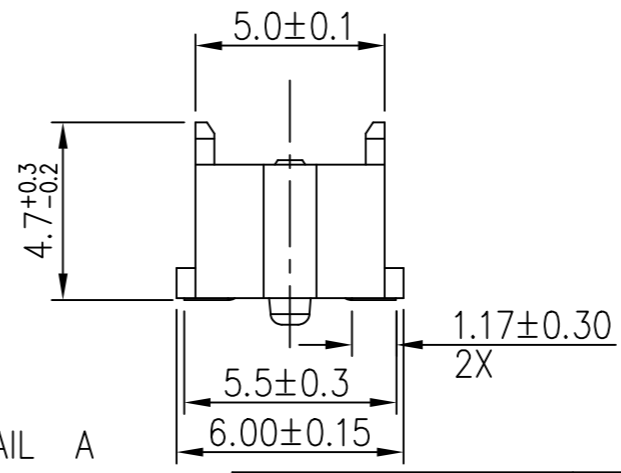
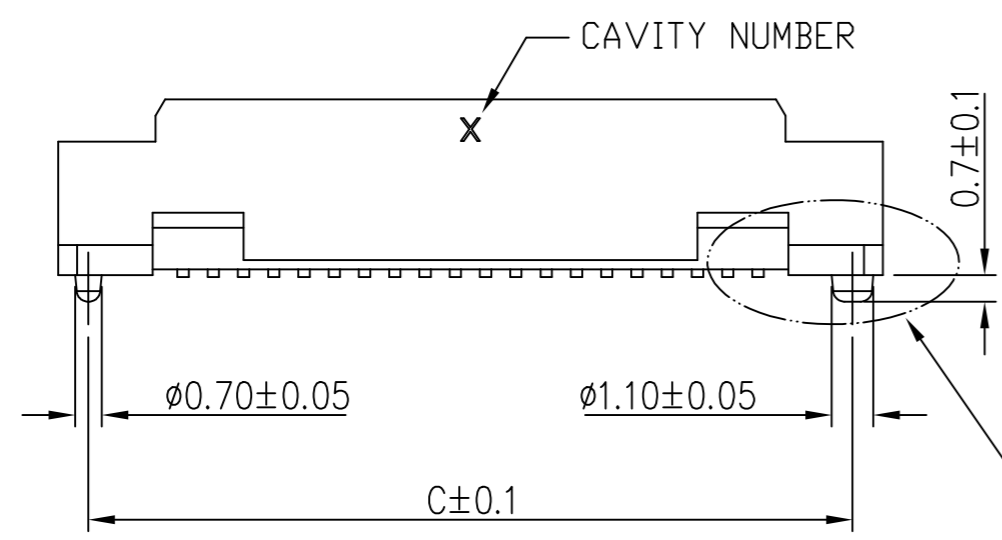
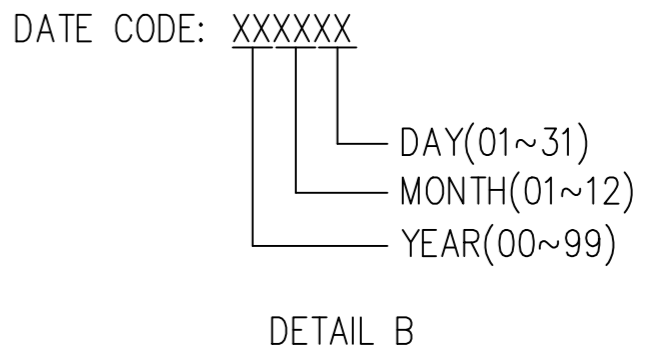
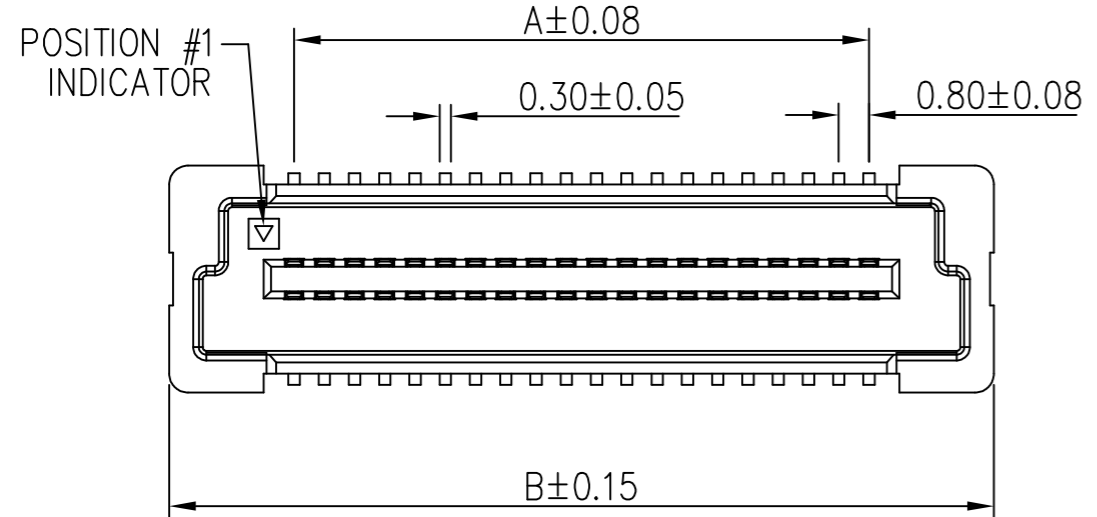
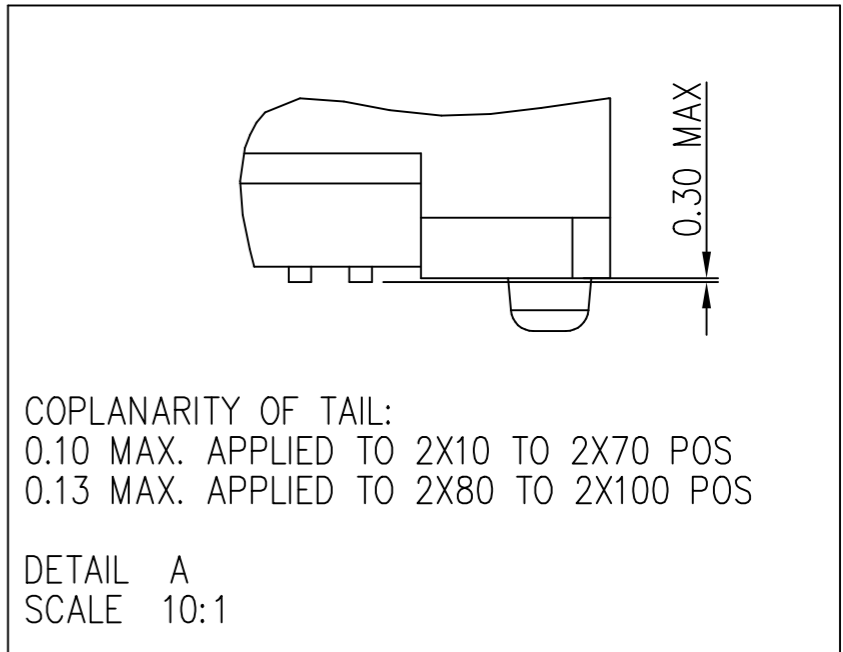
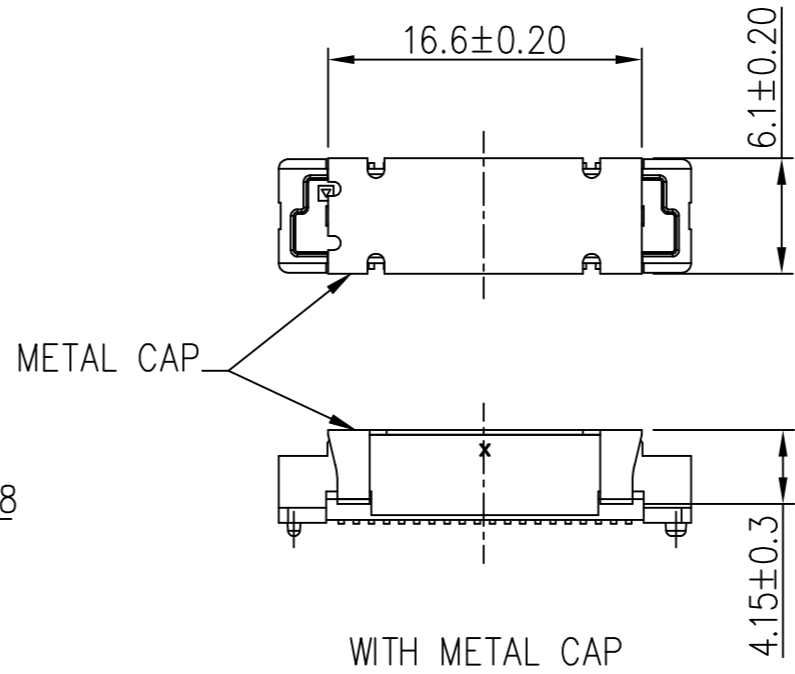

Amphenol FCI

© 2016 AFCI

mat'l. code		surface ISO 1302 ✓		tolerance ISO 406 ISO 1101		projection 1101		product family BERGSTAK HPL545	
ltr		ecn no		dr		date		title	
AW								PLUG ASSY BERGSTAK 0.8MM	
		angles 0°±3'		linear .0±.2		mm		dwg no 61083	
				.00±.15		scale 1:1		sheet 2 of 6 size A3	
				.000±.10				type Product Customer Drawing	
dr Alan Ni 2025-06-26		engr Alan Ni 2025-06-26		chr LQ Lei 2025-06-26		appd Tim Yao 2025-06-26		Amphenol FCI	
sheet index		revision sheet		AW 1~6					

PRODUCT NO.	NO. OF POSITION	DIMENSION		
		A	B	C
61083-022***	2X10	7.2	13.8	12.2
61083-042***	2X20	15.2	21.8	20.2
61083-062***	2X30	23.2	29.8	28.2
61083-082***	2X40	31.2	37.8	36.2
61083-102***	2X50	39.2	45.8	44.2
61083-122***	2X60	47.2	53.8	52.2
61083-142***	2X70	55.2	61.8	60.2
61083-162***	2X80	63.2	69.8	68.2
61083-182***	2X90	71.2	77.8	76.2
61083-202***	2X100	79.2	85.8	84.2

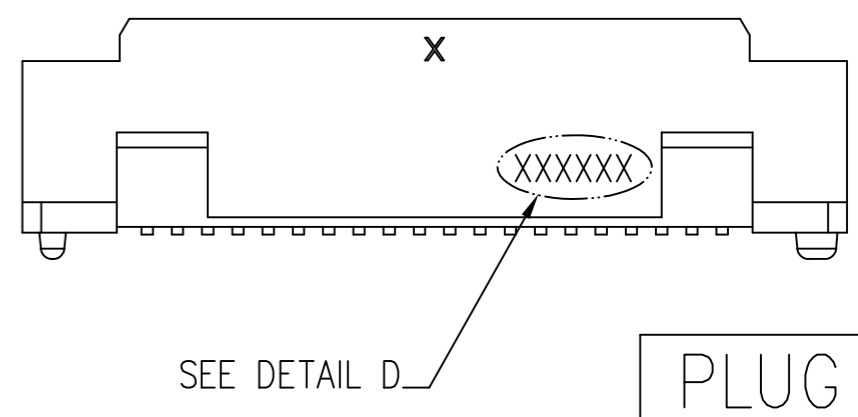
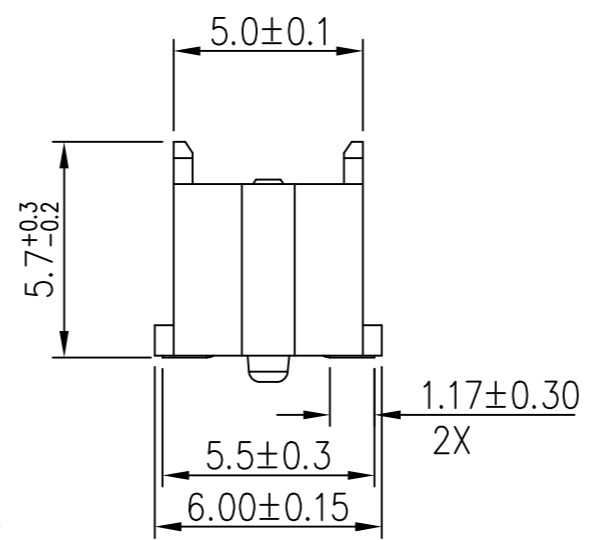
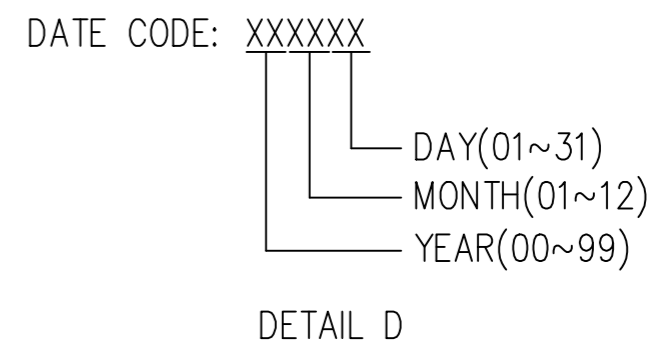
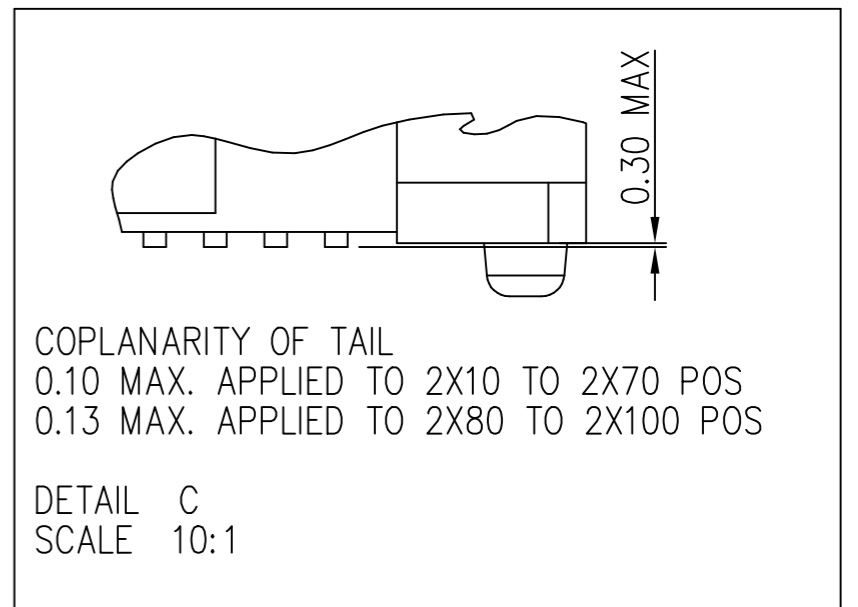
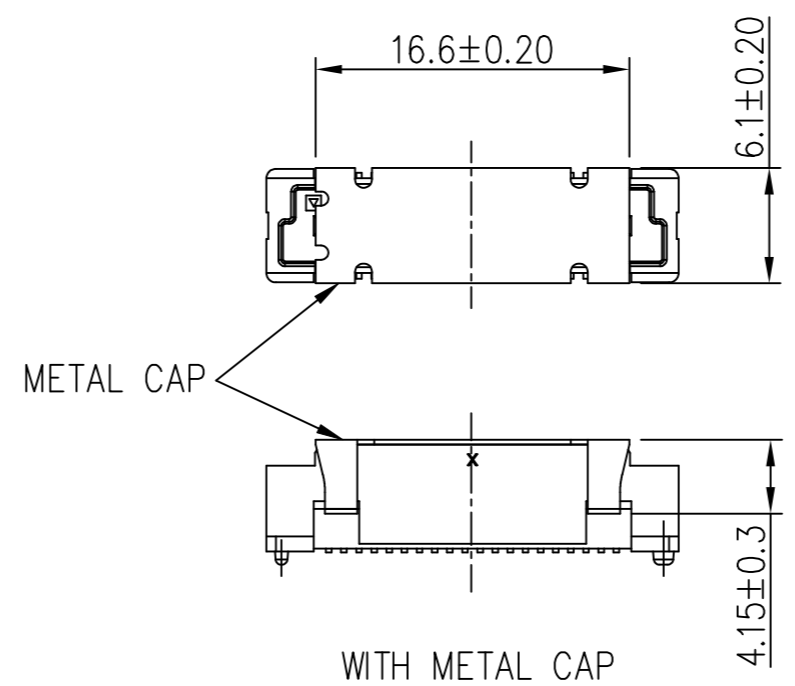
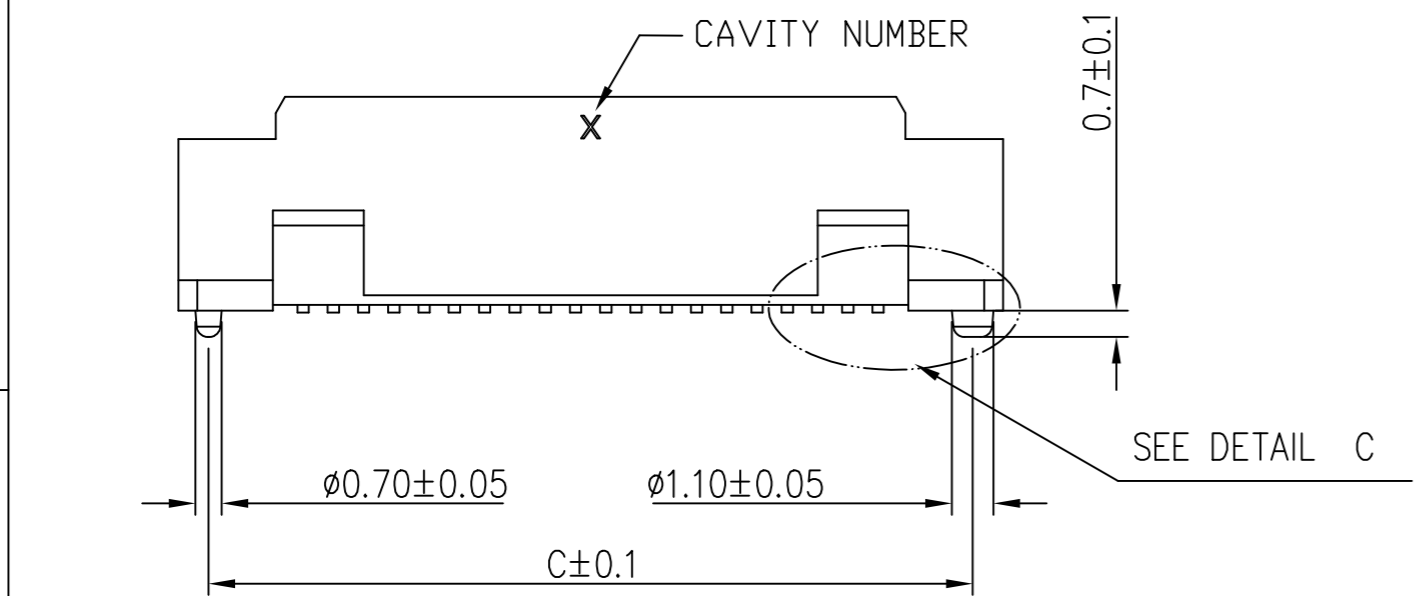
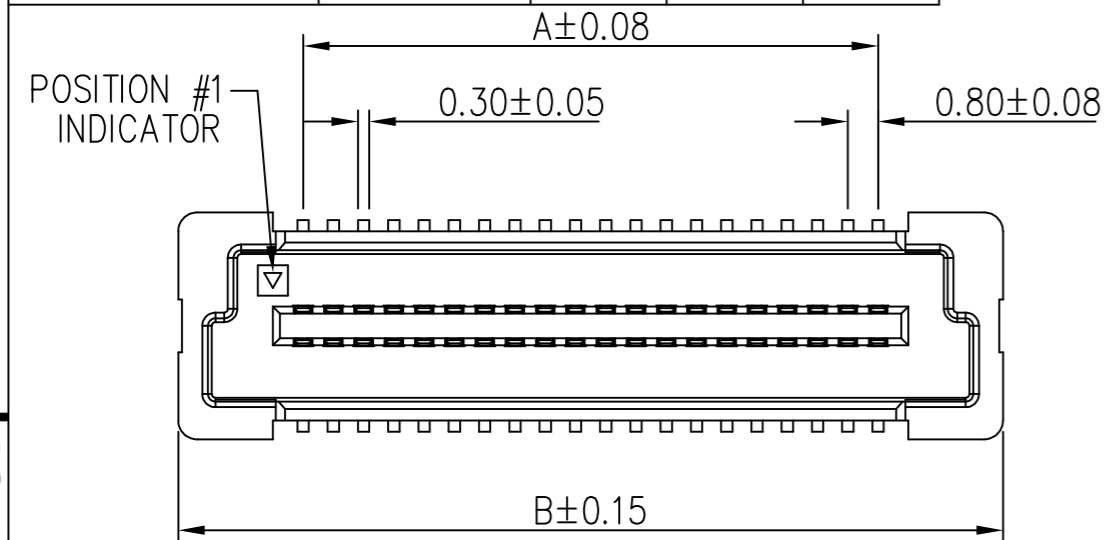

PLUG 2

mat'l. code		surface ISO 1302 ✓		tolerance ISO 406 ISO 1101		projection		product family BERGSTAK HPL545	
ltr		ecn no		dr		date		title	
AW								PLUG ASSY BERGSTAK 0.8MM	
		angles		linear		mm		dwg no 61083	
		0°±3'				scale 1:1		sheet 3 of 6 size A3	
		dr		Alan Ni		2025-06-26		type Product Customer Drawing	
		engr		Alan Ni		2025-06-26			
		chr		LQ Lei		2025-06-26			
		appd		Tim Yao		2025-06-26			
sheet index		revision sheet		AW 1~6					

Amphenol FCI



PRODUCT NO.	NO. OF POSITION	DIMENSION		
		A	B	C
61083-023***	2X10	7.2	13.8	12.2
61083-043***	2X20	15.2	21.8	20.2
61083-063***	2X30	23.2	29.8	28.2
61083-083***	2X40	31.2	37.8	36.2
61083-103***	2X50	39.2	45.8	44.2
61083-123***	2X60	47.2	53.8	52.2
61083-143***	2X70	55.2	61.8	60.2
61083-163***	2X80	63.2	69.8	68.2
61083-183***	2X90	71.2	77.8	76.2
61083-203***	2X100	79.2	85.8	84.2

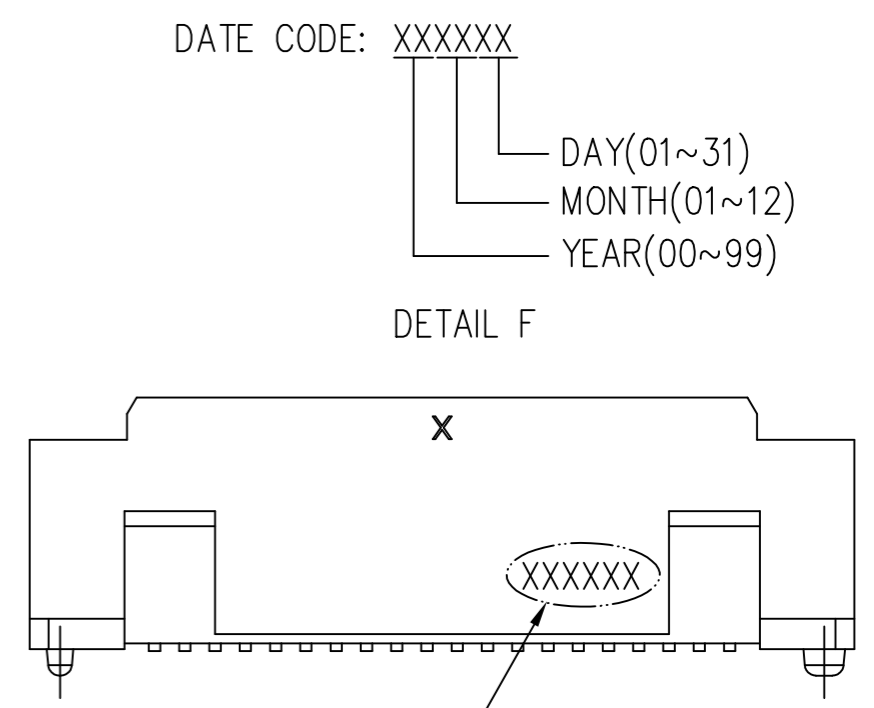
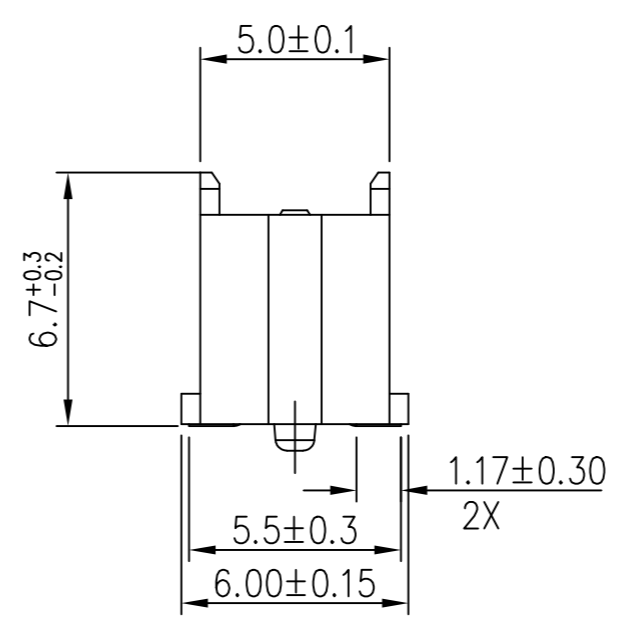
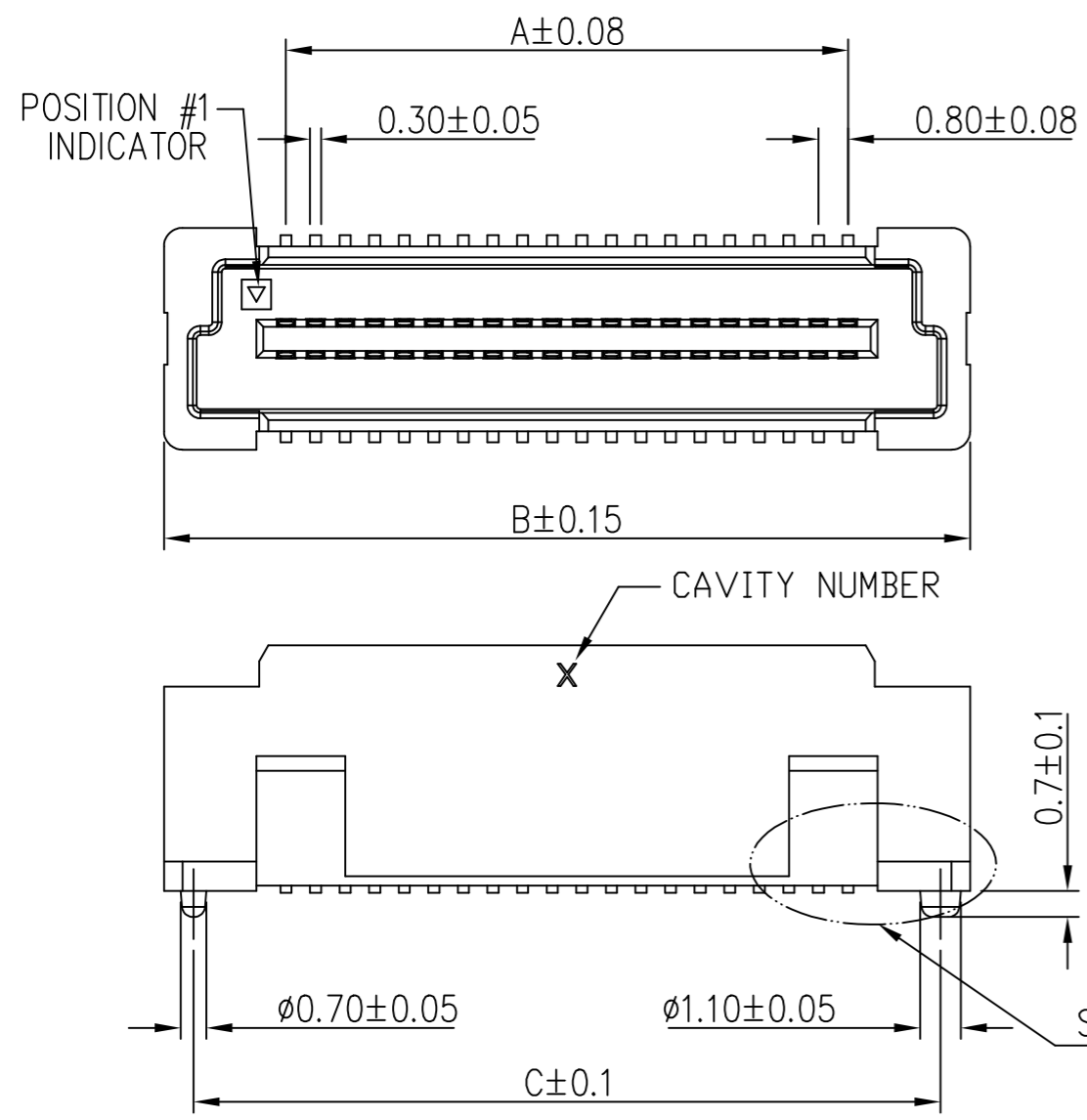
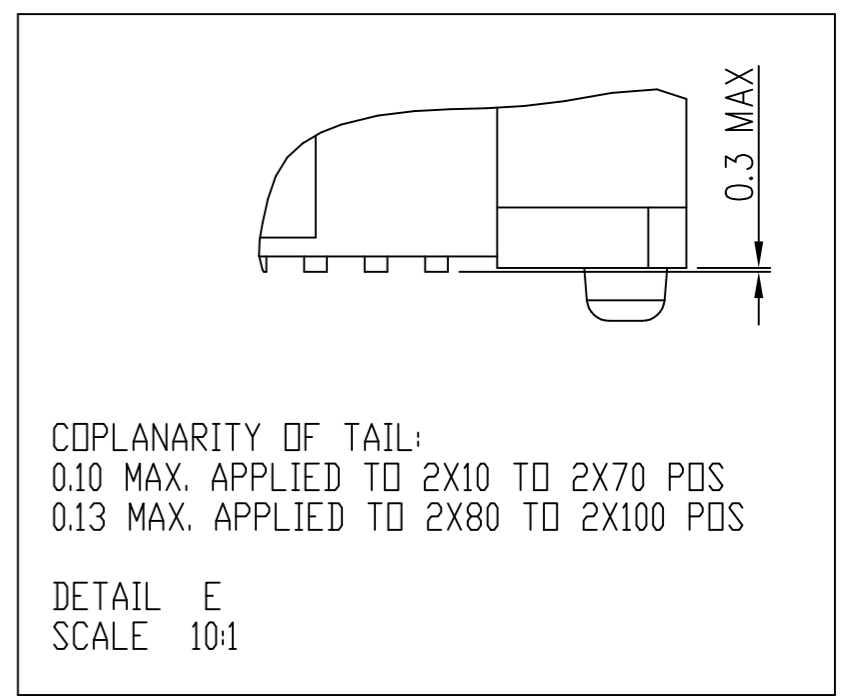
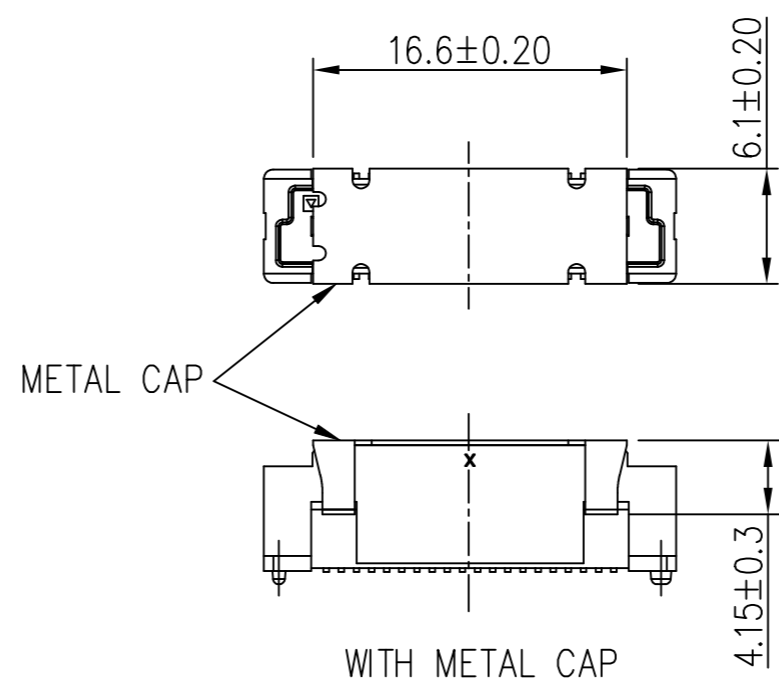

PLUG 3

mat'l. code		surface ISO 1302 ✓		tolerance ISO 406 ISO 1101		projection 1101		product family BERGSTAK HPL545		
ltr	ecn no	dr	date	tolerances unless otherwise specified		mm		title		
AW				angles	.0±.2	scale 1:1		PLUG ASSY BERGSTAK 0.8MM		
				linear	.00±.15			dwg no sheet 4 of 6 size		
				0°±3'	.000±.10			61083 A3		
				dr	Alan Ni	2025-06-26	Amphenol FCI		type Product Customer Drawing	
				engr	Alan Ni	2025-06-26				
				chr	LQ Lei	2025-06-26				
				appd	Tim Yao	2025-06-26				
sheet index	revision sheet	AW	1~6							

© 2016 AFCI
 Amphenol FCI
 © 2016 AFCI

PRODUCT NO.	NO. OF POSITION	DIMENSION		
		A	B	C
61083-024***	2X10	7.2	13.8	12.2
61083-044***	2X20	15.2	21.8	20.2
61083-064***	2X30	23.2	29.8	28.2
61083-084***	2X40	31.2	37.8	36.2
61083-104***	2X50	39.2	45.8	44.2
61083-124***	2X60	47.2	53.8	52.2
61083-144***	2X70	55.2	61.8	60.2
61083-164***	2X80	63.2	69.8	68.2
61083-184***	2X90	71.2	77.8	76.2
61083-204***	2X100	79.2	85.8	84.2

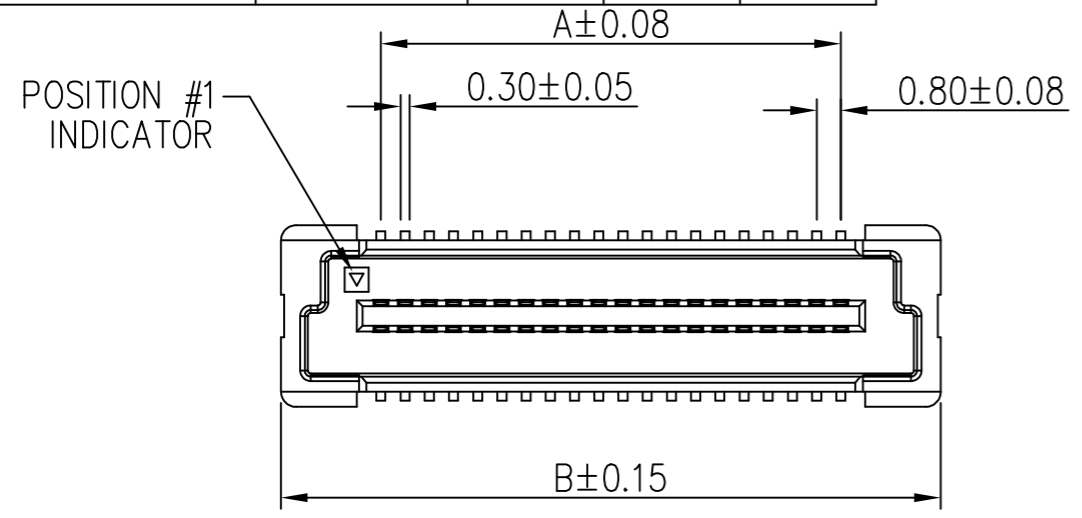
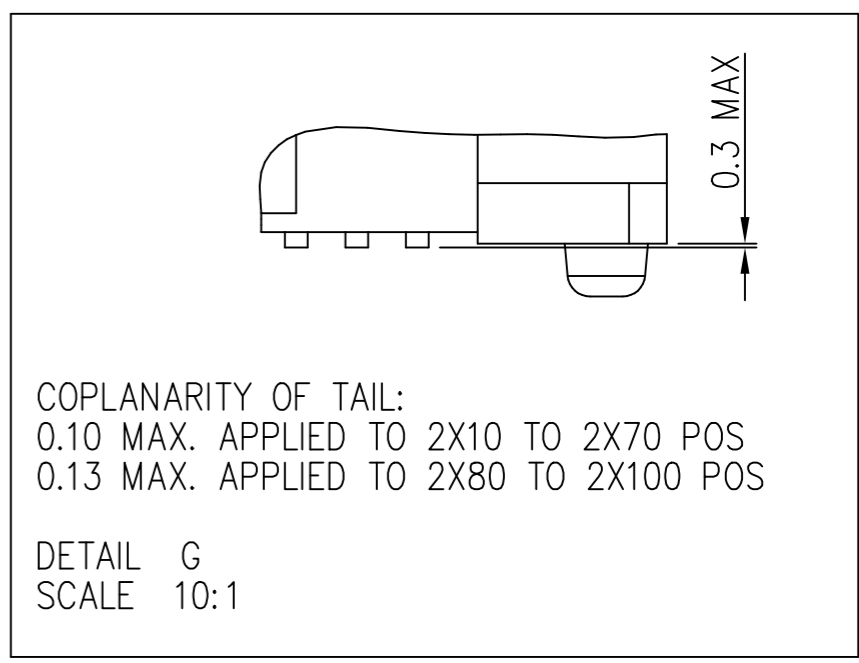
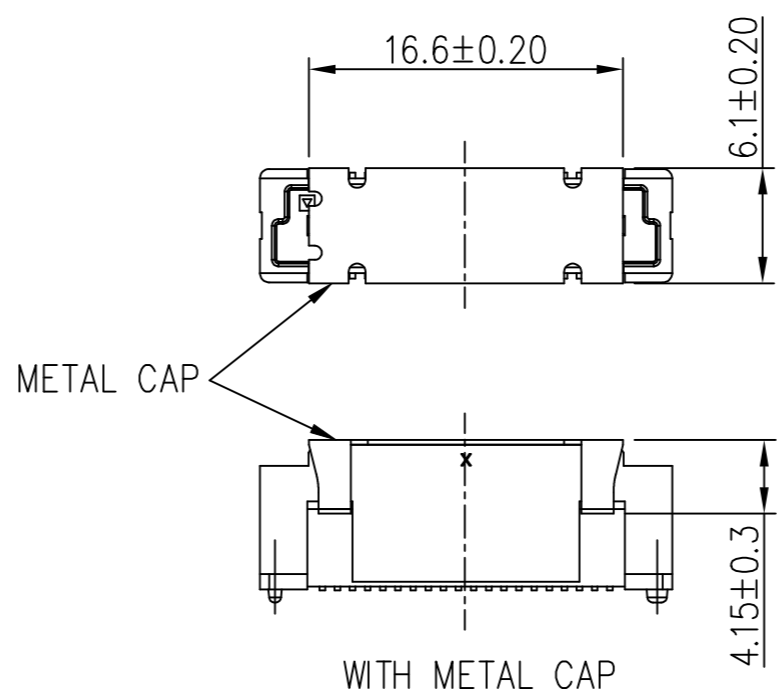

DATE CODE: XXXXXX
 DAY(01~31)
 MONTH(01~12)
 YEAR(00~99)

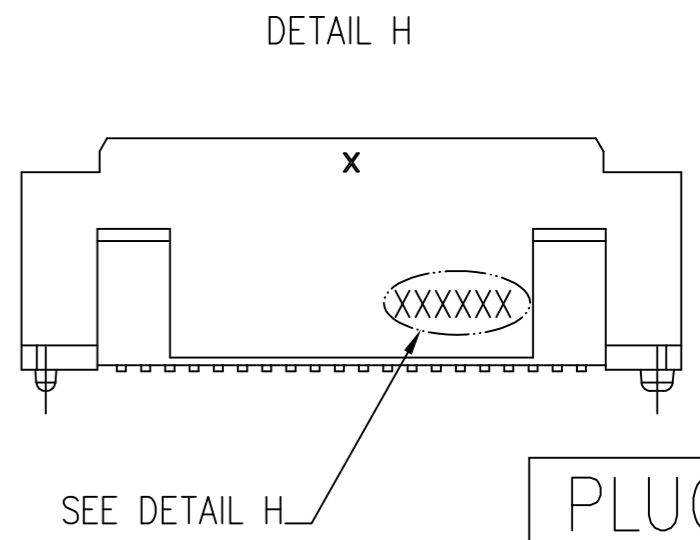
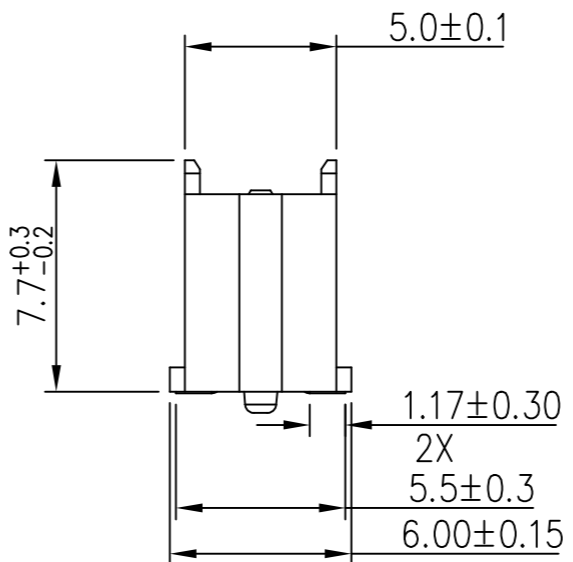
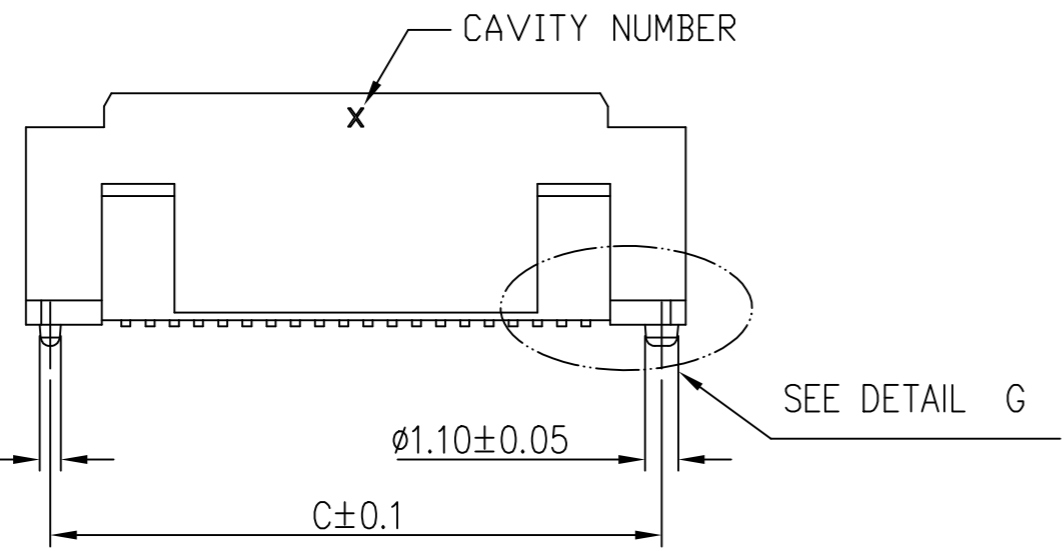

mat'l. code		surface ISO 1302 ✓		tolerance ISO 406 ISO 1101		projection 1101		product family BERGSTAK HPL545	
ltr		ecn no		dr		date		title	
AW								PLUG ASSY BERGSTAK 0.8MM	
		angles 0°±3'		linear .00±.15		mm		scale 1:1	
		dr Alan Ni		2025-06-26		Amphenol FCI		dwg no sheet 5 of 6 size	
		engr Alan Ni		2025-06-26				61083 A3	
		chr LQ Lei		2025-06-26					
		appd Tim Yao		2025-06-26				type Product Customer Drawing	
sheet index		revision sheet		AW 1~6					

Amphenol FCI
 © 2016 AFCI
 2016 AFCI

FOR PLUG 1/2/3/4

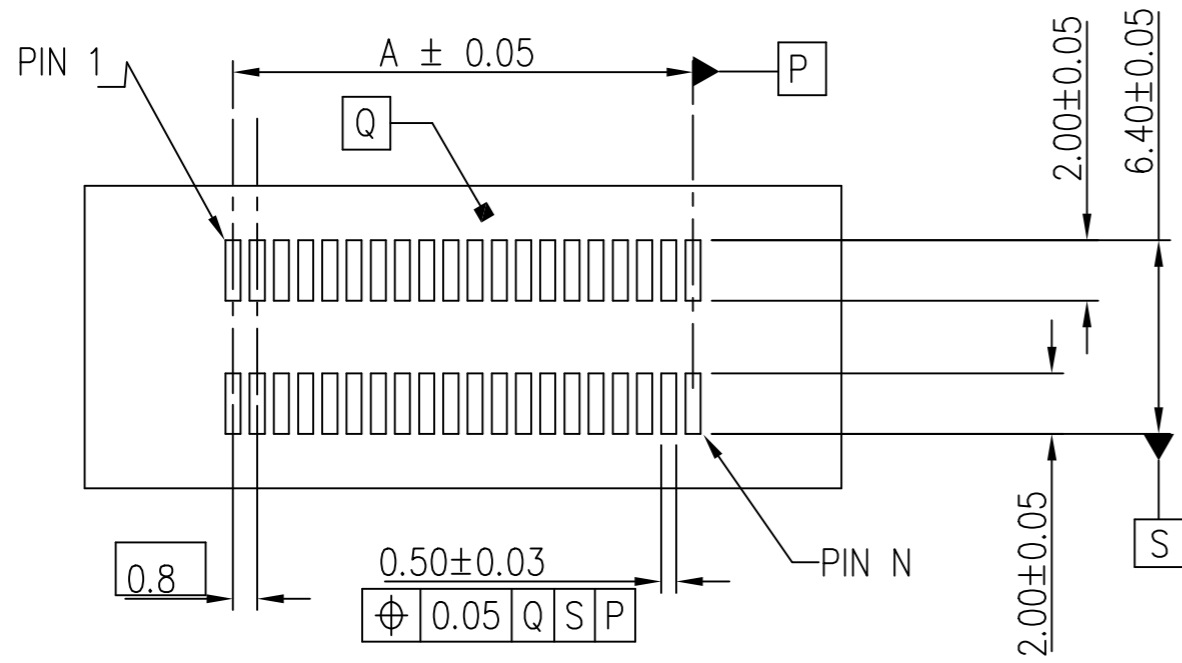

RECOMMENDED PCB LAYOUT WITHOUT PEG FOR NO. OF POS 2X10, 2X20, 2X30, 2X40, 2X50 2X60

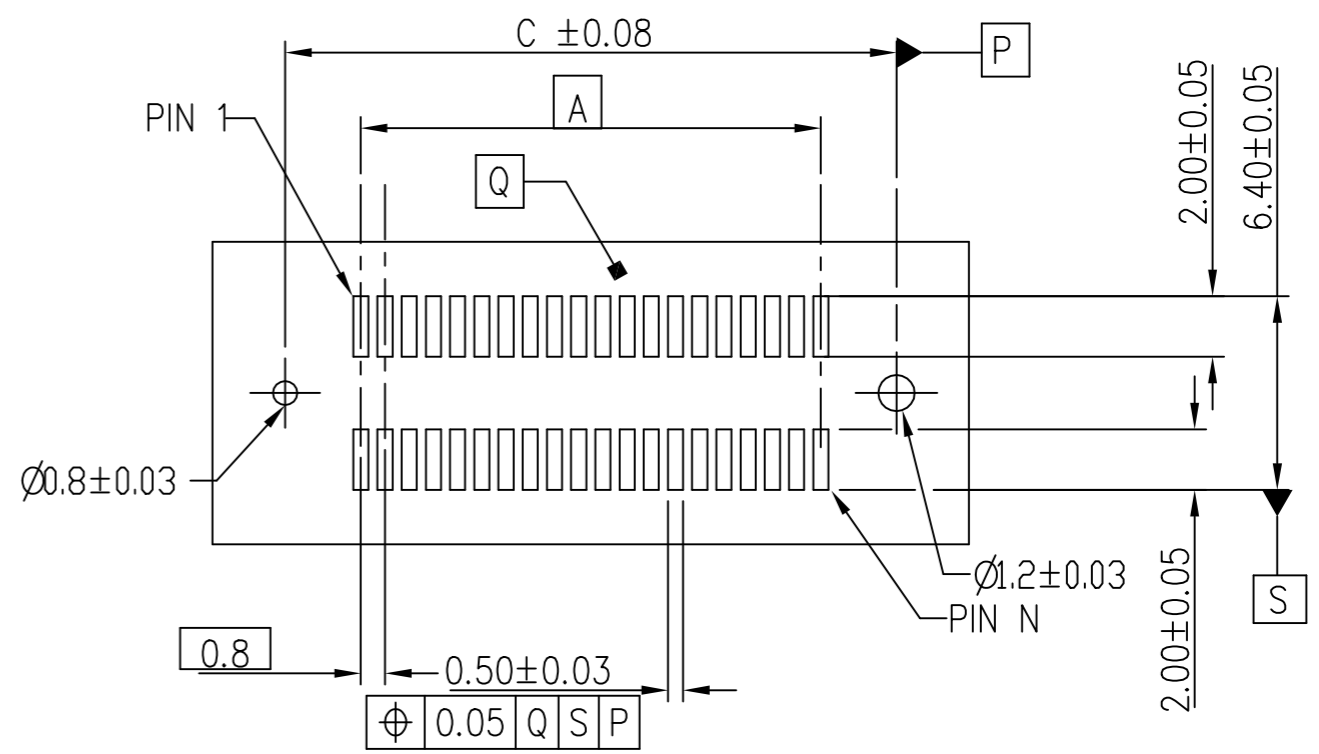

RECOMMENDED PCB LAYOUT WITH PEG FOR NO. OF POS 2X70, 2X80, 2X90, 2X100

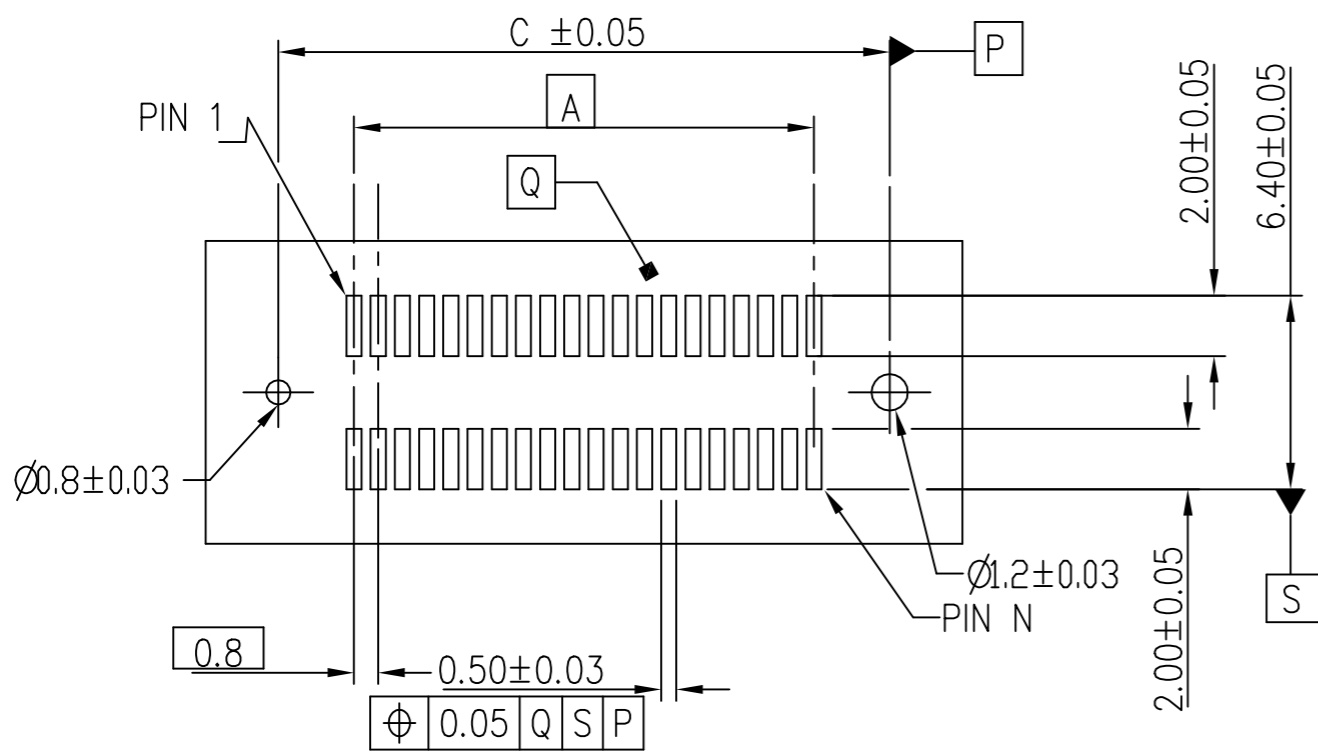

RECOMMENDED PCB LAYOUT WITH PEG FOR NO. OF POS 2X10, 2X20, 2X30, 2X40, 2X50 2X60

mat'l. code		surface		tolerance		projection		product family	
		ISO 1302 ✓		ISO 406 ISO 1101		mm		BERGSTAK HPL545	
ltr		ecn no		dr		date		title	
AW								PLUG ASSY BERGSTAK 0.8MM	
		angles		linear		scale 1:1		dwg no	
		0°±3'						sheet 6 of 6 size	
		dr		Alan Ni		2025-06-26		61083	
		engr		Alan Ni		2025-06-26		A3	
		chr		LQ Lei		2025-06-26		type	
		appd		Tim Yao		2025-06-26		Product Customer Drawing	
sheet index		revision sheet		AW 1~6					

Amphenol FCI

© 2016 AFCI