

PRODUCT NUMBER
SEE TABLE

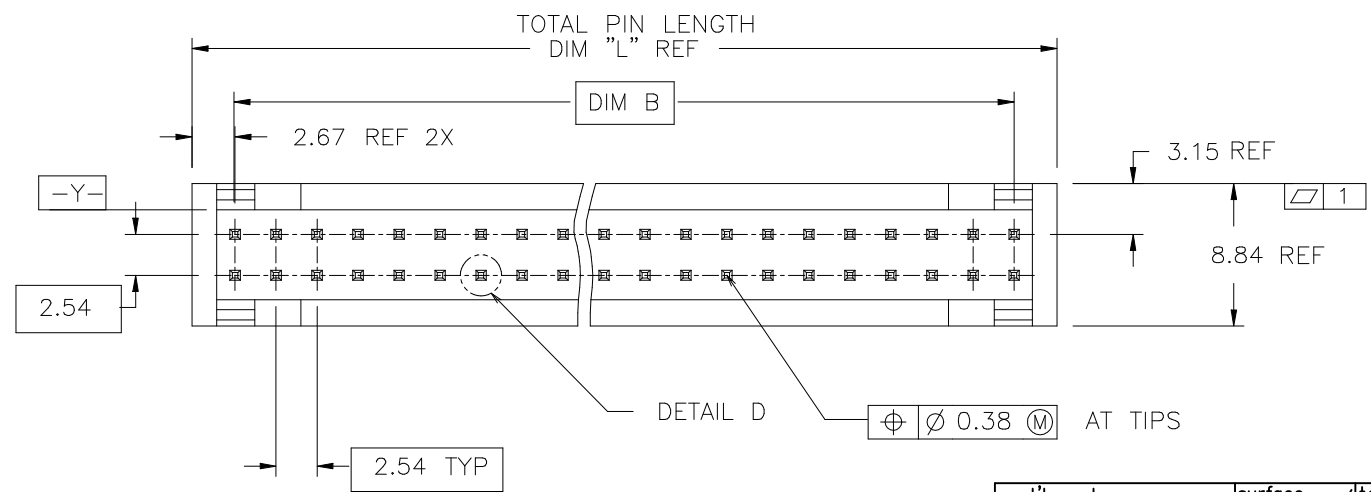
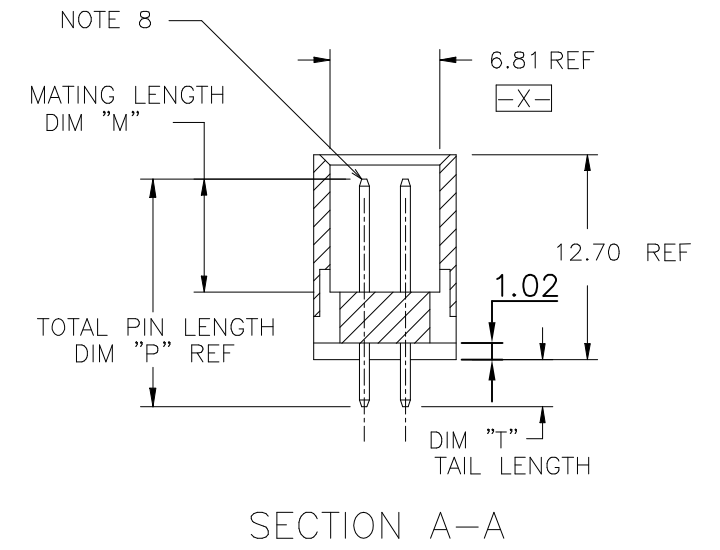
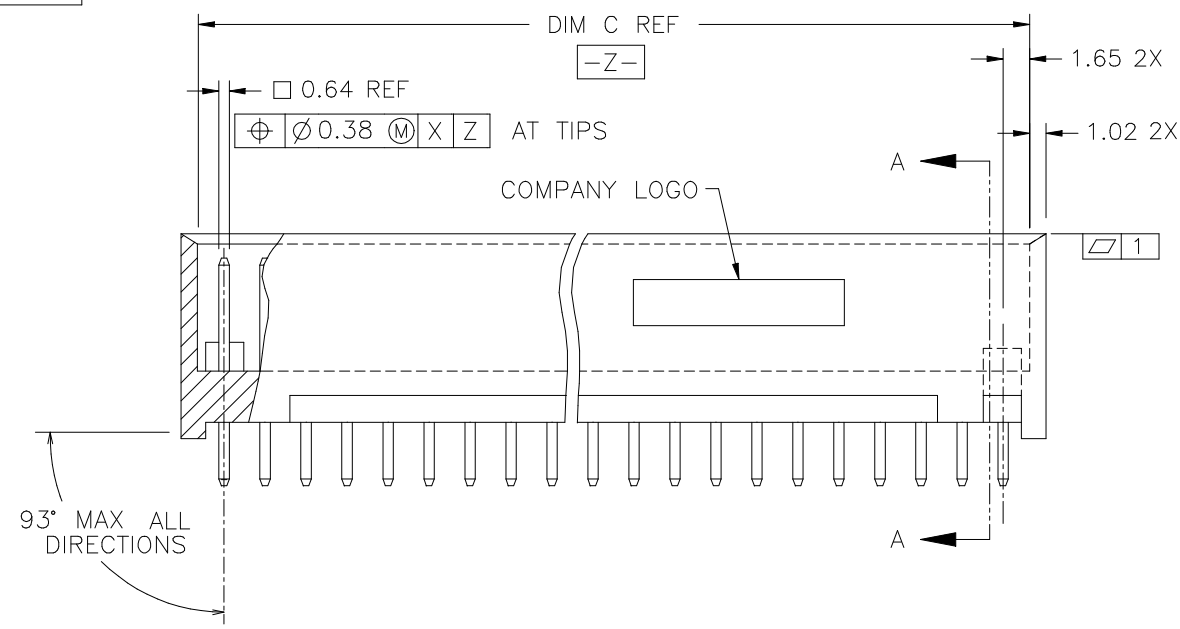

| | | | | | | | |
|----------------------------|----------------|-----|------------|---------------------------------------|----------------------------------|----------------|--|
| mat'l. code NOTES 2 & 3 | | | | surface ISO 1302 ✓ | tolerance ISO 406 ISO 1101 | projection | product family HEADER |
| ltr | ecn no | dr | date | tolerances unless otherwise specified | | MM | title VERTICAL STACKING 2-ROW HEADER .500/12.70 W/O MOUNTING HOLES |
| K | M05-0089 | ERE | 5/20/05 | angles | linear | | |
| L | M06-0289 | AGS | 7/29/06 | | | scale 1:1 | dwg no 69916 |
| M | ELX-N-52996 | MZ | 2024-09-25 | 0±2' | | | |
| | | | | dr | M. FETROW | 8/11/95 | sheet 1 of 4 size A3 |
| | | | | enr | L. FYE | 8/11/95 | |
| | | | | chr | T. BREWBAKER | 8/11/95 | |
| | | | | appd | L. FYE | 8/11/95 | type Product Customer Drawing |
| sheet index | revision sheet | M | M | M | | | |
| | | 1 | 2 | 3 | | | |

Amphenol FCI
 © 2016 AFCI

| POSITION TABLE | |
|----------------|------|
| PRODUCT NO | SIZE |
| XXXXX-001 | 2X5 |
| -002 | 2X6 |
| -003 | 2X7 |
| -004 | 2X8 |
| -005 | 2X9 |
| -006 | 2X10 |
| -007 | 2X11 |
| -008 | 2X12 |
| -009 | 2X13 |
| -010 | 2X14 |
| -011 | 2X15 |
| -012 | 2X16 |
| -013 | 2X17 |
| -014 | 2X18 |
| -015 | 2X19 |
| -016 | 2X20 |
| -017 | 2X21 |
| -018 | 2X22 |
| -019 | 2X23 |
| -020 | 2X24 |
| -021 | 2X25 |
| -022 | 2X26 |
| -023 | 2X27 |
| -024 | 2X28 |
| -025 | 2X29 |
| -026 | 2X30 |
| -027 | 2X31 |
| -028 | 2X32 |
| -029 | 2X33 |
| -030 | 2X34 |
| -031 | 2X35 |
| XXXXX-032 | 2X36 |

PART NUMBER INFORMATION

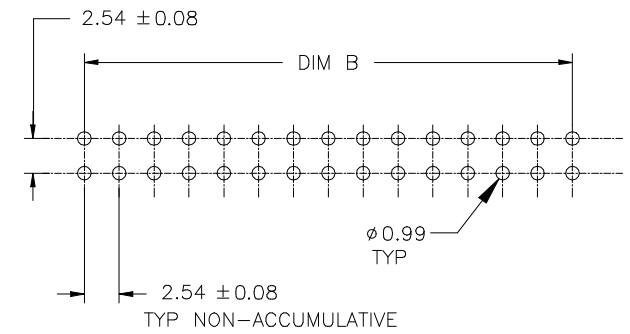
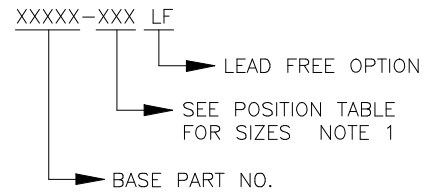

RECOMMENDED PC BOARD LAYOUT SCALE 2/1

NOTES

- SEE POSITION TABLE FOR PRODUCT NO AND SIZE TABULATION. HOUSING DASH NO IS SAME AS HEADER DASH NO.
- DIM B = (NO OF COLUMNS - 1) TIMES 2.54 (METRIC)
- MOLDING MATERIAL: 20% MIN GLASS FILLED NYLON PER UL 94V-0. COLOR: BLACK, OXYGEN INDEX 36.
- TERMINAL MATERIAL: 3/4 HARD PHOS BRONZE ALLOY UNS C51000.
- PIN RETENTION TO BE 3 LBS./1.4 KGS MINIMUM PER PIN IN EITHER DIRECTION.
- COMPANY LOGO TO BE MOLDED IN APPROX LOCATION SHOWN.
- UL/CSA APPROVED.
- ADD "LF" SUFFIX AT THE END OF PART NUMBER FOR LEAD FREE OPTION.
- THE HOUSING WILL WITHSTAND EXPOSURE TO 260°C PEAK TEMPERATURE FOR 15 SECONDS IN A WAVE SOLDER APPLICATION WITH A 1.5mm MINIMUM THICK CIRCUIT BOARD. SEE APPLICATION NOTES/PROCEDURES IF THEY ARE AVAILABLE.
- THIS PRODUCT MEETS EUROPEAN UNION DIRECTIVES AND OTHER COUNTRY REGULATION AS DESCRIBED IN GS-22-008.
- PLATING OPTIONS: MAY BE EITHER GOLD OR GXT PLATED AT MANUFACTURER'S OPTION.

Amphenol FCI

© 2016 AFCI

| | | | | | |
|----------------------------|----------------|---------------------|----------------------------------|--|-------------------------------|
| mat'l. code NOTES 2 & 3 | | surface ISO 1302 | tolerance ISO 406 ISO 1101 | projection INCH/MM | product family HEADER |
| ltr | ecn no | dr | date | title VERTICAL STACKING 2-ROW HEADER .500/12.70 W/O MOUNTING HOLES | |
| M | | | | scale 1:1 | dwg no 69916 |
| | | | | | sheet 2 of 4 size A3 |
| | | | | | type Product Customer Drawing |
| sheet index | revision sheet | | | | |

1

2 3

4

5

6

| PRODUCT NO NOTE 8 | TERMINAL PLATING NOTE 11 |
|----------------------|---------------------------------------|
| 69916-XXX | 30u"/0.76u MIN Au OVER 50u"/1.27u Ni. |
| 69916-033 | 30u"/0.76u MIN Au OVER 50u"/1.27u Ni. |
| 69916-034 | 30u"/0.76u MIN Au OVER 50u"/1.27u Ni. |
| 86363-XXX | 15u"/0.38u Pd Ni WITH GOLD FLASH |
| 88809-021 | 30u"/0.76u MIN Au OVER 50u"/1.27u Ni. |

Amphenol
FCI

© 2016 AFCI

| | | | | | |
|----------------------------|----------------|---------------------|----------------------------------|---|---|
| mat'l. code NOTES 2 & 3 | | surface ISO 1302 | tolerance ISO 406 ISO 1101 | projection | product family HEADER |
| ltr | ecn no | dr | date | tolerances unless otherwise specified | title |
| M | | | | angles linear .X0.3 .X0.013 .X0.0061 | VERTICAL STACKING 2-ROW HEADER .500/12.70 W/O MOUNTING HOLES |
| | | | | dr M. FETROW 8/11/95 | dwg no sheet 3 of 4 size |
| | | | | enr L. FYE 8/11/95 | 69916 A3 |
| | | | | chr T. BREWBAKER 8/11/95 | type Product Customer Drawing |
| | | | | appd L. FYE 8/11/95 | |
| sheet index | revision sheet | | | | |

| PRODUCT NO NOTE 8 | SIZE | DIM "B" | DIM "C" | DIM "L" | TAIL LENGTH DIM "T" | MATING LENGTH DIM "M" | TOTAL PIN LENGTH DIM "P" |
|----------------------|--------|---------|-----------------|-----------------|------------------------|-----------------------------|--------------------------------|
| 69916-XXX | NOTE 1 | NOTE 2 | DIM "B" 3.30 | DIM "B" 5.33 | 2.62 MIN 3.30 MAX | 6.99±0.25 | 14.10 |
| 69916-033 | 2 x 8 | 17.78 | 21.1 | 23.1 | 3.76±0.20 | 6.99±0.25 | 14.86 |
| 69916-034 | 2 x 15 | 35.56 | 38.9 | 41.0 | 3.76±0.20 | 6.99±0.25 | 14.86 |
| 86363-XXX | NOTE 1 | NOTE 2 | DIM "B" 3.30 | DIM "B" 5.33 | 2.62 MIN 3.30 MAX | 6.99±0.25 | 14.10 |
| 88809-021 | 2 x 25 | 60.96 | 64.3 | 66.3 | 3.30±0.38 | 7.37±0.25 | 14.86 |

Amphenol
FCI

© 2016 AFCI

| | | | | | |
|----------------------------|----------------|---------------------|----------------------------------|---|---|
| mat'l. code NOTES 2 & 3 | | surface ISO 1302 | tolerance ISO 406 ISO 1101 | projection | product family HEADER |
| ltr | ecr no | dr | date | tolerances unless otherwise specified | title |
| M | | | | angles linear XX13 XX13 XX13.051 | VERTICAL STACKING 2-ROW HEADER .500/12.70 W/O MOUNTING HOLES |
| | | | | dr | scale 1:1 |
| | | | | M. FETROW 8/11/95 | Amphenol FCI |
| | | | | enr L. FYE 8/11/95 | |
| | | | | chr T. BREWBAKER 8/11/95 | |
| | | | | appd L. FYE 8/11/95 | dwg no 69916 sheet 4 of 4 size A3 |
| sheet index | revision sheet | | | | type Product Customer Drawing |