

EXTENDED RANGE

- TOOLING FEASIBILITY CONFIRMED
- SAMPLES ON DEMAND
- AVAILABILITY ON DEMAND

PRODUCT NB	DIM"C" & DIM"D"
95264-YXX(H)LF	SEE SHEET 2/2

- RoHS COMPATIBLE, SEE NOTE 5
- HIGH TEMPERATURE HOUSING, SEE NOTE 4 (AS AVAILABLE)
- PIN STYLE, SEE SHEET 2 (AS AVAILABLE)
- PLATING, SEE SHEET 2 (AS AVAILABLE)

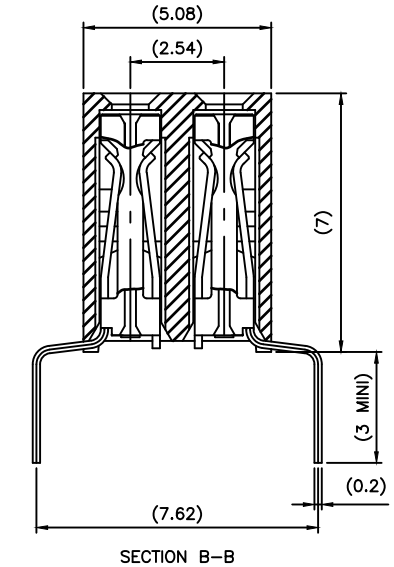
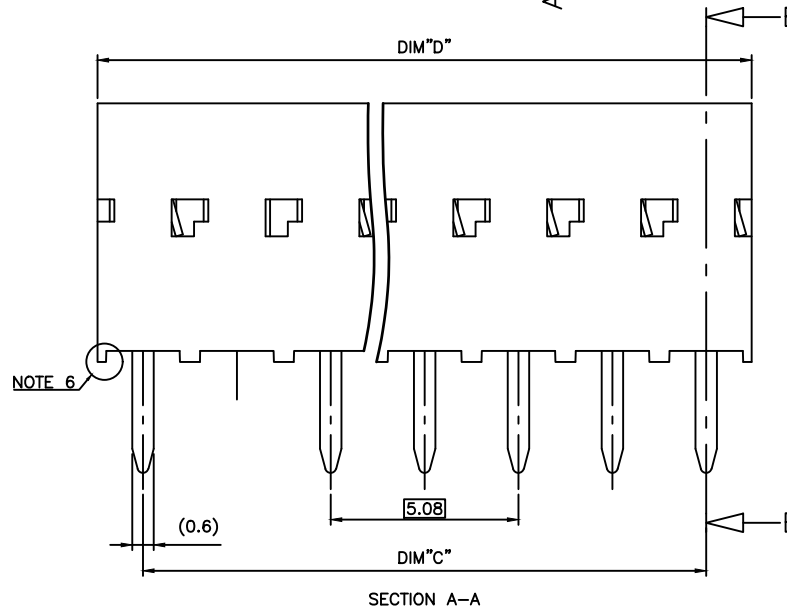
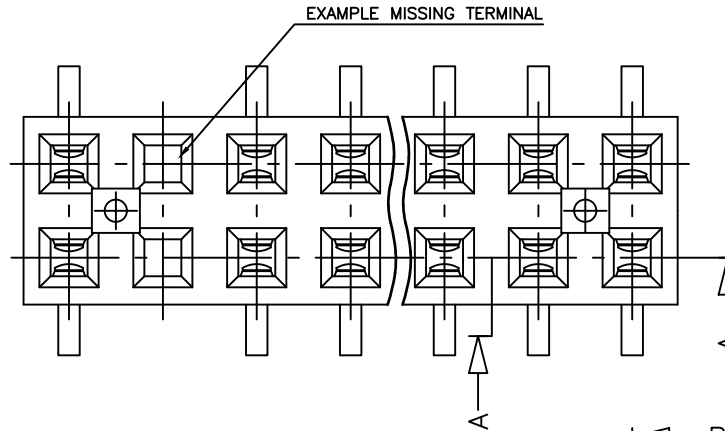

NOTES:

- MATERIAL HOUSING: THERMOPLASTIC POLYESTER, 30% GLASS FILLED, COLOUR BLUE. FLAME RETARDANT PER UL-94 CATEGORY V0.
- MATERIAL TERMINAL: PHOSPHOR BRONZE EXTRA HARD.
- MATERIAL HOUSING VERSION HIGH TEMPERATURE: PCT 30% GLASS FILLED, COLOUR GREY. FLAME RETARDANT PER UL-94 CATEGORY V0.
- THE DASH "H" AT THE END OF THE P/N TO INDICATE A HIGH TEMPERATURE HOUSING.
- RoHS COMPATIBLE PRODUCT SPECIFICATIONS
 - PLATING:
 - "LF" MEANS THE PRODUCT IS LEAD-FREE, 2µm MINIMUM MATTE TIN OVER 1.27µm MINIMUM NICKEL UNDERPLATE.
 - MANUFACTURING PROCESS COMPATIBILITY
 - THE HOUSING WILL WITHSTAND EXPOSURE TO 260°C ±5°C SOLDER BATH TEMPERATURE FOR 5 SECONDS IN A WAVE SOLDER APPLICATION WITH A 1.6mm MIN THICK CIRCUIT BOARD.
 - LABELING:
 - MEETS PACKAGING SPECS AS PER GS-14-920
 - LEGAL STATEMENT: SEE GS-47-0004
- END STAND-OFFS FOR 2x2 UP TO 2X4 POS
NO END STAND-OFFS FOR 2x5 UP TO 2x50 POS
- THIS PART SERIES IS NOT INITIALLY INTENDED FOR AUTOMOTIVE APPLICATIONS. ADDITIONAL FEES ARE CHARGEABLE FOR ANY ADDITIONAL QUALIFICATION AND TEST REPORTS PERFORMED OUTSIDE THE SCOPE OF THE STANDARD PRODUCT SPECIFICATIONS.
- UNLESS OTHERWISE APPROVED BY AMPHENOL, ALL PARTS AND COMPONENTS ARE DESIGNED & BUILT ACCORDING TO AMPHENOL'S SPECIFICATIONS WHICH ARE SUBJECT TO CHANGE WITHOUT NOTICE.

mat'l. code				surface		tolerance		projection		product family	
SEE NOTES				ISO 1302		ISO 406 ISO 1101				DUBOX VCC DR	
ltr	ecn no	dr	date	tolerances unless otherwise specified		±0.3		mm		title	
R	B-19124	LMU	14.10.21	angles	linear				SPREADED LEGS		
S	F-24429	AMA	16.07.01	±z'		scale 5:1				.300 SELECT. LOADED	
T	F-55262	DDE	25.04.03							dwg no	
				dr		O.MATHEVON 96.06.07				sheet 1 of 2	
				engr		JM.PHAMVAN 96.06.07				size	
				chr		P.NIZZI 96.06.07				A3	
				appd		JM.PHAMVAN 96.06.07				type	
				sheet		revision				CUSTOMER Drawing	
				index		sheet		1 2			

Amphenol FCI FCIconnect.com

Copyright FCI

PIN STYLE PRODUCT N°	NB of POS.	DIM"C"	DIM"D"	CONTACT PLACED IN CAVITY (SEE VIEW "A")																			
				1	2	3	4	5	6	7	8	9	10	11	12	13	14	15	16	17	18	19	20
95264-Y01(H)LF	2x10	22.86	25.32	X	X		X	X	X	X	X	X											
95264-Y02(H)LF	2x15	35.56	38.02	X	X		X		X		X		X	X	X	X	X						
95264-Y03(H)LF	2x11	35.56	38.02	X	X	X	X	X	X			X	X										
95264-Y04(H)LF	2x10	22.86	25.32	X	X	X	X	X	X	X	X	X											
95264-Y05(H)LF	2x4	7.62	10.08	X		X	X																
95264-Y06(H)LF	2x5	10.16	12.62	X	X		X	X															
95264-Y07(H)LF	2x3	5.08	7.54	X	X																		
95264-Y08(H)LF	2x7	15.24	17.7	X	X		X		X		X												
95264-Y09(H)LF	2x14	33.02	35.48	X	X	X	X	X	X	X	X	X	X					X	X				
95264-Y10(H)LF	2x20	48.26	50.72	X		X		X		X		X		X		X		X		X		X	

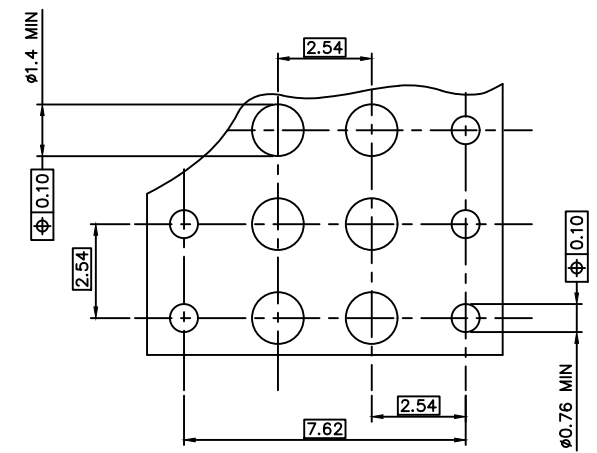
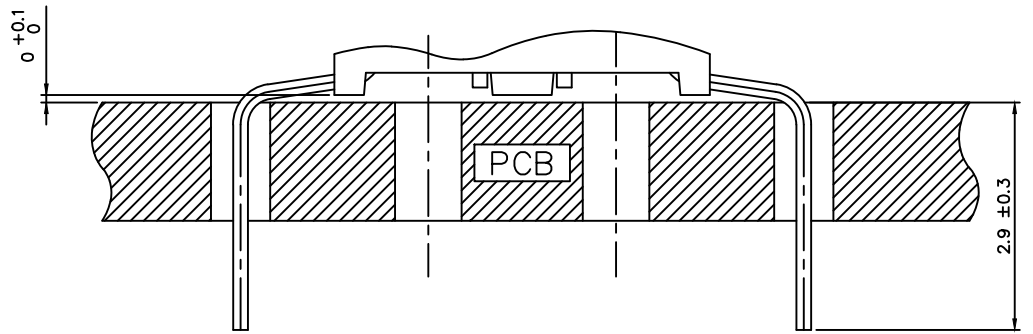

RECOMMENDED HOLE PATTERN

95264-6XX(H)LF	2µm Au MIN. OVER 1.3µm Ni MIN.	Sn OVER Ni
95264-8XX(H)LF	0.4µm Au MIN. OVER 1.3µm Ni MIN.	Sn OVER Ni
95264-4XX(H)LF	5µm Sn MIN. OVER 1.27µm Ni MIN.	Sn OVER Ni
95264-3XX(H)LF	0.75µm Au MIN. OVER 1.3µm Ni MIN.	Sn OVER Ni
PLATING CODE	CONTACT AREA	SOLDER TAIL
PLATING EXPLANATION		

mat'l. code		surface		tolerance		projection		product family	
SEE NOTES		ISO 1302		ISO 406 ISO 1101		mm		DUBOX VCC DR	
ltr	ecn no	dr	date	tolerances unless otherwise specified		mm		title	
H	F06-0204	DLE	06.06.28	±0.3		mm		SPREADED LEGS	
J	B-19124	LMU	14.10.21	linear		mm		.300 SELECT. LOADED	
K	F-55262	DDE	25.04.03	±Z		scale 5:1		dwg no	
		dr		P.NIZZI		96.10.23		sheet 2 of 2	
		engr		JM.PHAMVAN		96.10.23		size	
		chr		P.NIZZI		96.10.23		A3	
		appd		JM.PHAMVAN		96.10.23		type	
								CUSTOMER Drawing	
sheet		revision							
index		sheet							