

RECOMMENDED HOLES PATTERN  
 RECOMMENDED PC BOARD THICKNESS: 1.6 mm

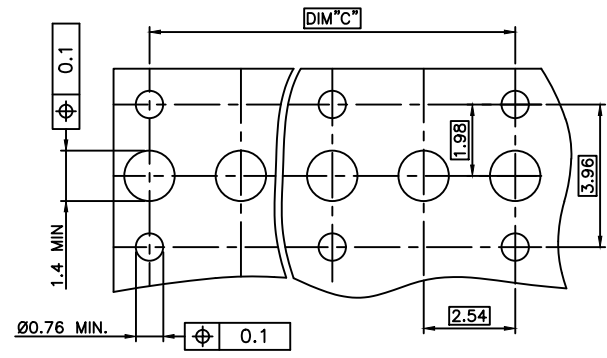

PRODUCT N°	HOUSING	DIM "C"	DIM "D"	NB. OF TER.	CONTACT PLACED IN CAVITY ( TABLE ACCORDING VIEW A )																											
					1	2	3	4	5	6	7	8	9	10	11	12	13	14	15	16	17	18	19	20	21	22	23	24	25	26	27	28
95234-Y01LF	1 X 28 pos.	68.58	71.04	14	X		X		X		X		X		X		X		X		X		X		X		X		X			
95234-Y02LF	1 X 13 pos.	30.48	32.94	10	X	X	X	X	X				X	X	X	X	X															
95234-Y03LF	1 X 3 pos.	5.08	7.54	2	X		X																									
95234-Y04LF	1 X 7 pos.	15.24	17.70	4	X		X		X		X																					
95234-Y05LF	1 X 4 pos.	7.62	10.08	2	X			X																								
95234-Y06LF	1 X 14 pos.	33.02	35.48	10	X	X			X	X			X	X	X	X	X	X	X	X	X	X	X	X	X	X	X	X	X			

RoHS COMPATIBLE,  
 SEE NOTE 4

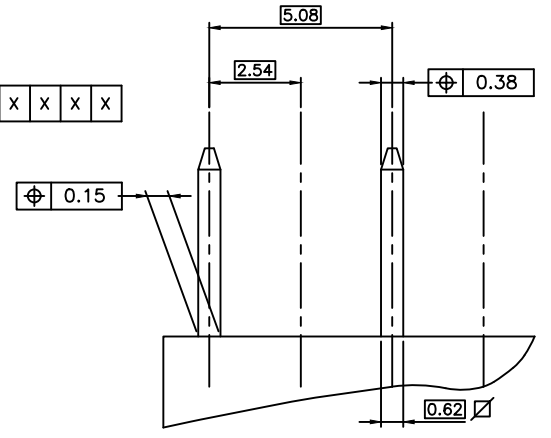

RECOMMENDED PINS PATTERN

NOTES:

- MATERIAL HOUSING: THERMOPLASTIC POLYESTER 30% GLASS FILLED, COLOUR BLUE. FLAME RETARDANT PER UL-94 CATEGORY V0.
- MATERIAL TERMINAL: PHOSPHOR BRONZE EXTRA HARD.
- CONNECTOR TO BE USED ON PC BOARD WITH NON PLATED THROUGH HOLES
- RoHS COMPATIBLE PRODUCT SPECIFICATIONS
  - PLATING:
    - "LF" MEANS THE PRODUCT IS LEAD-FREE, 2µm MINIMUM MATTE TIN OVER 1.27µm MINIMUM NICKEL UNDERPLATE.
  - MANUFACTURING PROCESS COMPATIBILITY
    - THE HOUSING WILL WITHSTAND EXPOSURE TO 260°C ±5°C SOLDER BATH TEMPERATURE FOR 5 SECONDS IN A WAVE SOLDER APPLICATION WITH A 1.6mm MIN THICK CIRCUIT BOARD.
  - LABELING:
    - MEETS PACKAGING SPECS AS PER GS-14-920
  - LEGAL STATEMENT: SEE GS-47-0004
- THIS PART SERIES IS NOT INITIALLY INTENDED FOR AUTOMOTIVE APPLICATIONS. ADDITIONAL FEES ARE CHARGEABLE FOR ANY ADDITIONAL QUALIFICATION AND TEST REPORTS PERFORMED OUTSIDE THE SCOPE OF THE STANDARD PRODUCT SPECIFICATIONS.
- UNLESS OTHERWISE APPROVED BY AMPHENOL, ALL PARTS AND COMPONENTS ARE DESIGNED & BUILT ACCORDING TO AMPHENOL'S SPECIFICATIONS WHICH ARE SUBJECT TO CHANGE WITHOUT NOTICE.

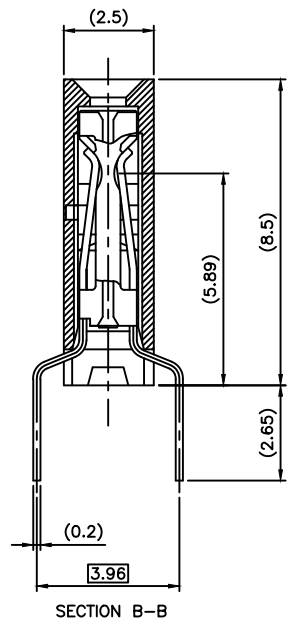
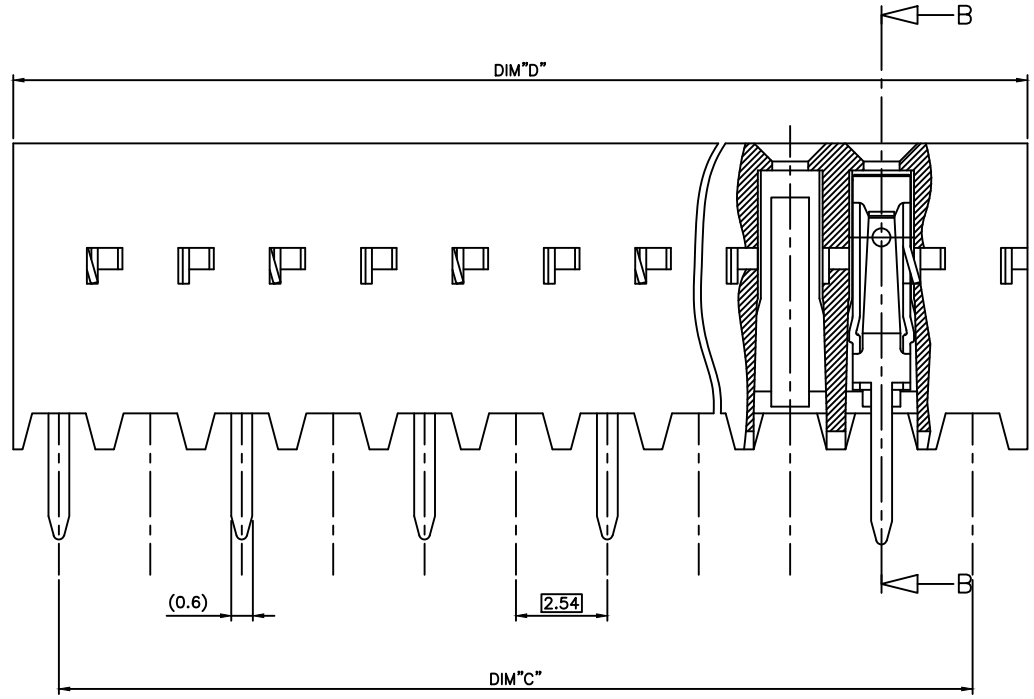

95234-4XXLF	5 µm Sn	Sn
95234-3XXLF	0.76 µm GOLD	Sn
PLATING CODE	CONTACT AREA	SOLDER TAIL
	PLATING THICKNESS OVER 1.27µm Ni	

mat'l. code		surface	tolerance	projection	product family
SEE NOTES		ISO 1302	ISO 446 ISO 1101	mm	DUBOX VCC SR
ltr	ecn no	dr	date	tolerances unless otherwise specified	file
H	F07-027	LMU	07.12.06	±0.3	DUAL ENTRY S.L
J	B-16001	LMU	13.10.04	linear	OFFSET LEGS
K	B-18504	LMU	14.09.08	scale 1:1	
L	B-19123	LMU	14.10.21	dr	
M	F-59221	DDE	26.01.28	engr	
G	F06-0204	DLE	06.06.28	appd	
sheet	revision				
index	sheet				

Amphenol FCI FCIconnect.com

Copyright FCI