

Recommended PCB Layout  
 ▨ Solder Area

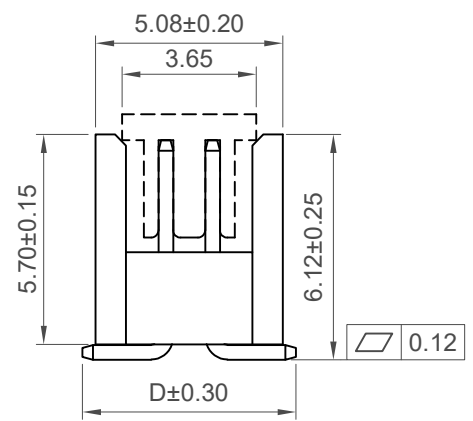
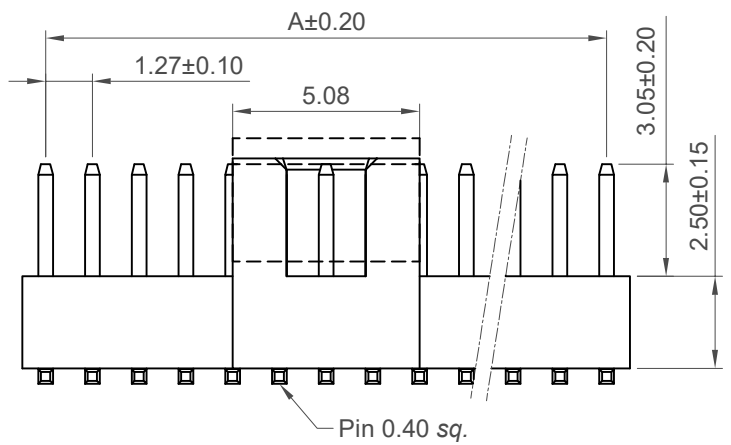
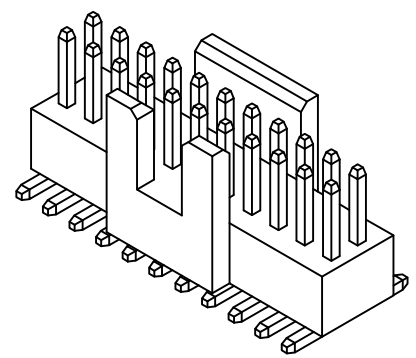

Specifications

Material  
 Insulator: Polymer LCP, UL 94V-0, Black  
 Contact: Brass

Plating  
 See Ordering Grid

Electrical  
 Current Rating: 1Amp Per Pin  
 Contact Resistance: 20 mΩ max.  
 Insulation Resistance: 1000 MΩ min.  
 Dielectric Withstand Voltage: 500V AC

Mechanical & Environmental  
 Operating Temperature: -40°C to +125°C  
 Soldering Process:  
 IR Reflow: 260°C for 10 sec.  
 Manual Solder: 350°C for 3-5 sec.

Mates with (Subject to pin length)  
 BD050 BD055 BD060 BD064

No. of Contacts	Dimensions	
	A	B
8	3.81	5.08
* 10	5.08	6.35
12	6.35	7.62
14	7.62	8.89
* 16	8.89	10.16
18	10.16	11.43
* 20	11.43	12.70
22	12.70	13.97
24	13.97	15.24
* 26	15.24	16.51
28	16.51	17.78
* 30	17.78	19.05
32	19.05	20.32
* 34	20.32	21.59
36	21.59	22.86
38	22.86	24.13
* 40	24.13	25.40
42	25.40	26.67
44	26.67	27.94
46	27.94	29.21
48	29.21	30.48
* 50	30.48	31.75

\* = Tooled Parts  
 Please contact GCT  
 for non-tooled parts

Ordering Grid

BD125	XX	X	0305	XXXX	L	X
-------	----	---	------	------	---	---

No. of Contacts: 08 to 50  
 Contact Plating:  
 A = Gold Flash All Over (Standard)  
 C = Tin All Over  
 G = 10µ" Gold Contact Area/Tin On Tail

Request Samples and Quotation

Packing Options:  
 B = Tape & Reel with Cap (Standard)  
 D = Tube  
 E = Tube with Cap

Insulator Material:  
 L = LCP

Dimension D (1/100mm) (Width of Footprint)  
**0580 = 5.80mm (Standard)**  
 or specify Custom Footprint Width  
 e.g. 5.50mm = 0550

Part Number		Product Description	
BD125		1.27mm Pitch Pin Header, Dual Row, Surface Mount, Vertical	
Drawing Date		18th November 2022	
By	MW	Tolerances (Except as Noted)	Units: Metric (mm)
Detail	Drawing Release	Length: X.X ± 0.30	  This drawing is confidential and copyright of Global Connector Technology, Ltd (GCT). This drawing must not be copied or disclosed without written consent. E & OE
Revision	A1	Angle: X.XX ± 0.20	
Date	09/03/26		

**GCT**  
 www.gct.co

Not to Scale | Drawn By CC | Sheet No. 1/1