

May.1.2026 Copyright 2026 HIROSE ELECTRIC CO., LTD. All Rights Reserved.
In case of consideration for using Automotive equipment / device which demand high reliability, kindly contact our sales window correspondents.

ELV, RoHS COMPLIANT

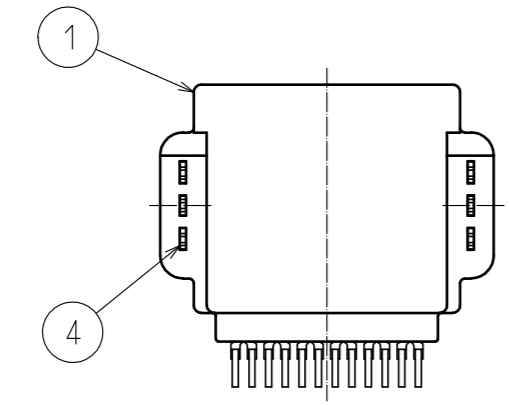
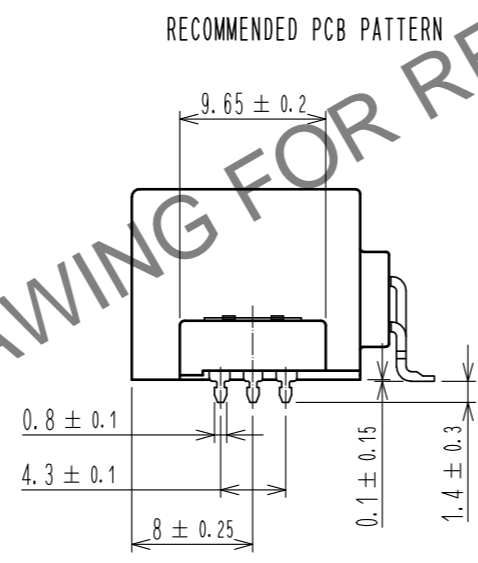
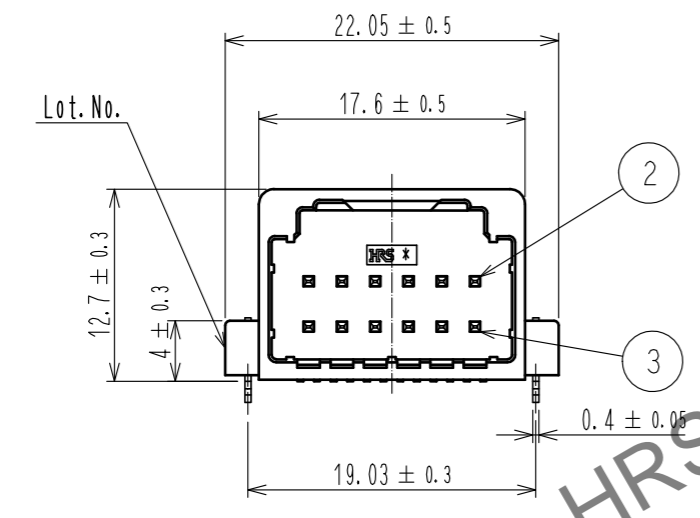
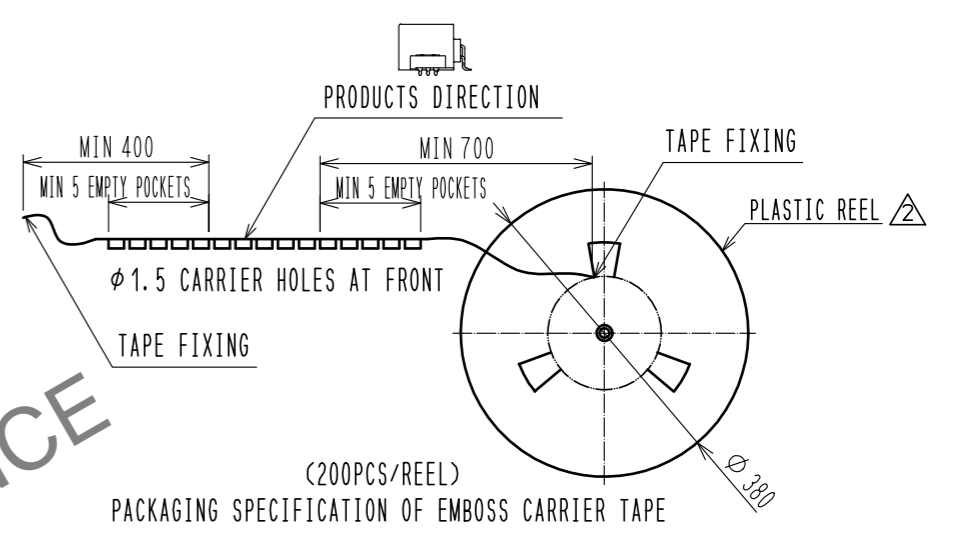
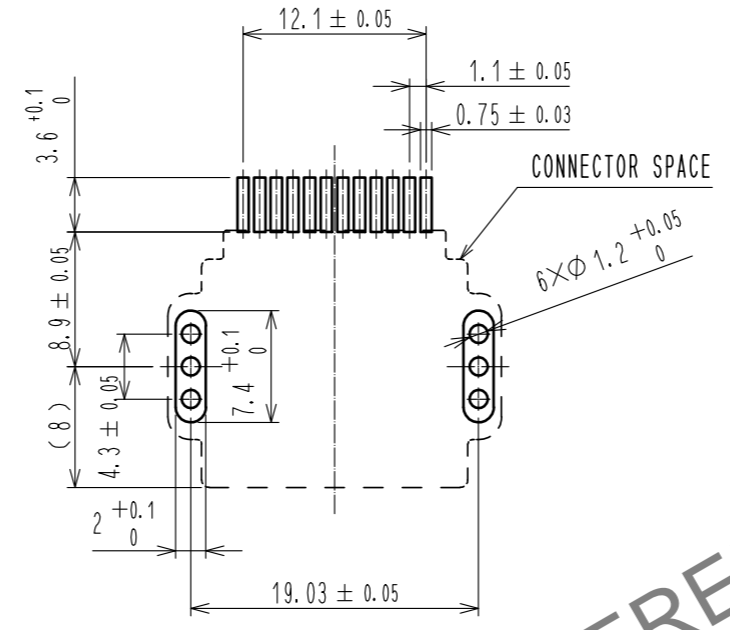
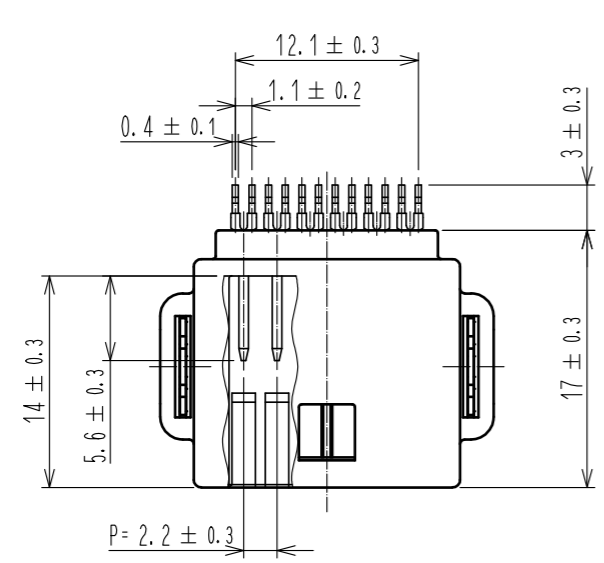

HRS DRAWING FOR REFERENCE

- NOTE 1. RECOMMENDED TEMPERATURE PROFILE FOR REFLOW
(REFER TO RIGHT FIG.)
REFLOW HEATING METHOD : IR IN THE AIR OR NITROGEN
NO. OF CYCLES : 2 MAX
PEAK : 250°C
OVER 230°C : 20~40s
PREHEAT : 150~180°C
60~120s
2. TEMPERATURE FOR SOLDERING IRON : 280~300°C MAX WITHIN 2s
3. CO-PLANARITY SHALL BE 0.1mm MAX.
4. PC BOARD THICKNESS = 1.6mm
5. RECOMMENDED SOLDER THICKNESS = 0.15mm

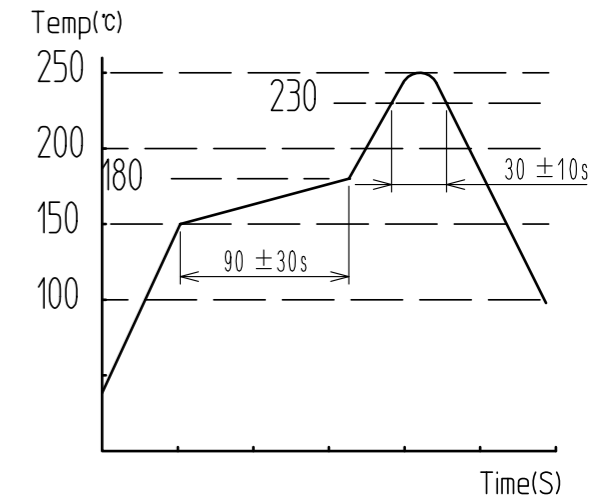

2	BRASS	TIN PLATED T=0.64	4	BRASS	TIN PLATED T=0.4
1	PPS	LIGHT GRAY	3	BRASS	TIN PLATED T=0.64
NO.	MATERIAL	FINISH . REMARKS	NO.	MATERIAL	FINISH . REMARKS
UNITS	mm	SCALE	2 : 1	COUNT	1
DESCRIPTION OF REVISIONS		DESIGNED	DONGCHAN KIM		
CHECKED		APPROVED		DATE	
DESIGNED		20070305		20200722	
DRAWN		20070301		DRAWING NO. EDC-166407-00-00	
HRS HIROSE ELECTRIC CO., LTD.		20070301		PART NO. GT25-12DP-2.2H	
		20070301		CODE NO. CL775-0005-4-00	
		20070301		1/1	