

PC card drilling dimensions(after plating)
(thickness 1.60±0.20mm)

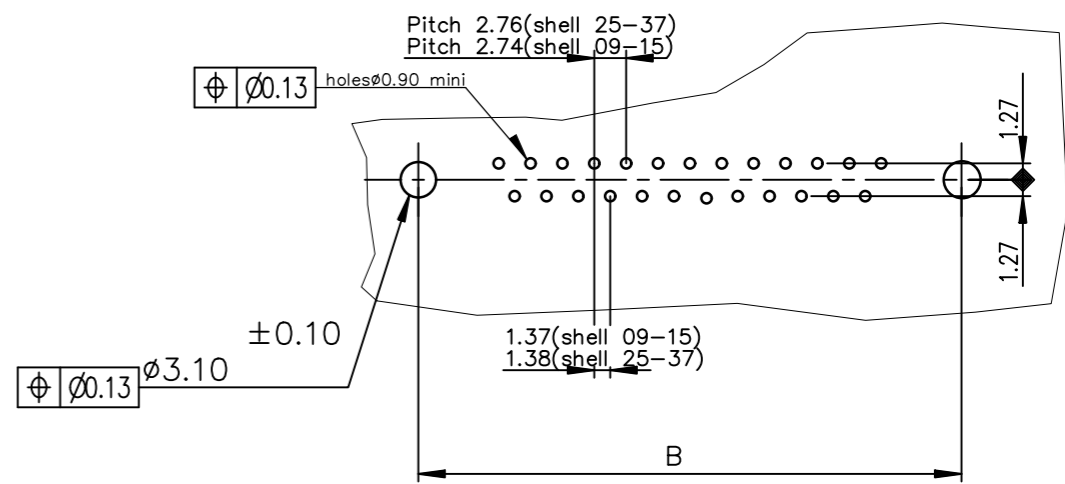

LF FOR LEAD FREE

SHELL	A±0.38	B±0.12	C±0.10	D±0.25	PART NUMBER	PART NUMBER
09	30.81	24.99	16.96	16.21	D09S13B4G*00**	D09S13B6G*00**
15	39.14	33.32	25.18	24.54	D15S13B4G*00**	D15S13B6G*00**
25	53.03	47.04	39.12	38.25	D25S13B4G*00**	D25S13B6G*00**
37	69.32	63.50	55.68	54.71	D37S13B4G*00**	D37S13B6G*00**
					200 MATING CYCLES	500 MATING CYCLES

Threaded ØT M3 = I
Threaded ØT 4.40 = V

GENERAL CHARACTERISTICS AND ROHS DETAILS REFER DWG.NO:C01-8646-0000

mat'l. code SEE NOTES		surface ISO 1302 ✓		tolerance ISO 406 ISO 1101		projection mm		product family D-SUB		
ltr	ecn no	dr	date	tolerances unless otherwise specified		mm		title		
F	ELX-I-279201	GM	2026-02-23	angles	linear	scale -		DELTA-D RIGHT ANGLE FEMALE CNR SCREWLOCK, HARPONN & METAL PLATE		
				0°±x2	.0±.3 .00 .000±.005			dwg no sheet 1 of 1 size		
				dr	JOHN SLEEBA	1994-08-01	Amphenol FCI		C01-8646-0292 A3	
				enr	GREGAR M	2026-02-23			type Product Customer Drawing	
				chr	GREGAR M	2026-02-23				
				appd	ALEX BABU	2026-02-23				
sheet index	revision sheet	F	1							