



SPLICE

TE Internal #: 61021-1

Pigtail Splice / Thru Splice, 18 – 16 AWG Wire Size, .823 – 1 mm² Wire Size, Serrated, 975 – 2700 CMA Wire Size, Steel, 4 Serration, SPLICE, Splices

[View on TE.com >](#)

Terminals & Splices > Splices



Splice Type: **Pigtail Splice, Thru Splice**

Wire Size: **.823 – 1 mm²**

Sealable: **No**

Splice Features: **Serrated**

Features

Packaging Features

Packaging Quantity	4000
Packaging Method	Reel

Body Features

Product Weight	.147 g
Splice Features	Serrated

Product Type Features

Splice Type	Pigtail Splice, Thru Splice
Sealable	No
Compatible With Discrete Wire Type	Solid, Stranded
Wire Insulation Support Retention Type	Non-Insulation Support

Configuration Features

Number of Serrations	4
Compatible With Wire & Cable Type	Discrete Wire

Contact Features

--	--



Contact Base Material	Steel
-----------------------	-------

Barrel Type	Open
-------------	------

Mechanical Attachment

Wire Insulation Support	Without
-------------------------	---------

Dimensions

Wire Size	975 – 2700 CMA
-----------	----------------

Terminal Material Thickness	.3 mm[.012 in]
-----------------------------	----------------

Product Length	9.52 mm[.375 in]
----------------	------------------

Usage Conditions

Insulation Option	Uninsulated
-------------------	-------------

Operating Temperature Range	-40 – 250 °C[-40 – 482 °F]
-----------------------------	----------------------------

Operation/Application

Compatible With Wire Base Material	Copper
------------------------------------	--------

Industry Standards

Government Qualified Splice	No
-----------------------------	----

Other

EU RoHS Compliance	Compliant
--------------------	-----------

EU ELV Compliance	Compliant
-------------------	-----------

Product Compliance

[For compliance documentation, visit the product page on TE.com>](#)

EU RoHS Directive 2011/65/EU	Compliant
------------------------------	-----------

EU ELV Directive 2000/53/EC	Compliant
-----------------------------	-----------

China RoHS 2 Directive MIIT Order No 32, 2016	No Restricted Materials Above Threshold
---	---

EU REACH Regulation (EC) No. 1907/2006	Current ECHA Candidate List: JUNE 2024 (241) Candidate List Declared Against: JUNE 2024 (241) Does not contain REACH SVHC
--	---

Halogen Content	Low Halogen - Br, Cl, F, I < 900 ppm per homogenous material. Also BFR/CFR/PVC Free
-----------------	---

Solder Process Capability	Not applicable for solder process capability
---------------------------	--

This information is provided based on reasonable inquiry of our suppliers and represents our current actual knowledge based on the information they provided. This information is subject to change. The part numbers that TE has identified as EU RoHS compliant have a maximum concentration of 0.1% by weight in homogenous materials for lead, hexavalent chromium, mercury, PBB, PBDE, DBP, BBP, DEHP, DIBP, and 0.01% for cadmium, or qualify for an exemption to these limits as defined in the Annexes of Directive 2011/65/EU (RoHS2). Finished electrical and electronic equipment products will be CE marked as required by Directive 2011/65/EU. Components may not be CE marked. Additionally, the part numbers that TE has identified as EU ELV compliant have a maximum concentration of 0.1% by weight in homogenous materials for lead, hexavalent chromium, and mercury, and 0.01% for cadmium, or qualify for an exemption to these limits as defined in the Annexes of Directive 2000/53/EC (ELV). Regarding the REACH Regulation, the information TE provides on SVHC in articles for this part number is based on the latest European Chemicals Agency (ECHA) 'Guidance on requirements for substances in articles' posted at this URL: <https://echa.europa.eu/guidance-documents/guidance-on-reach>

Compatible Parts



TE Part # 61299-1
SPLICE 7000-12500 .031 TPST



TE Part # 485043-4
SPLICE 4000-9000 .020 NPST



TE Part # 42329-1
SPLICE 1200-2600 .012 NPST



TE Part # 485020-1
SPLICE 6000-8000 .020 TPST



TE Part # 61769-2
SPLICE 1200-2600 .020 NPST



TE Part # 60933-2
SPLICE 2200-2900 .012 TPST



TE Part # 41215
SPLICE 2200-4500 CMA NPSTL



TE Part # 60470-1
SPLICE 3300-9000 .020 ST BLK



TE Part # 61008-1
SPLICE 18-16 AWG .0158 TPST



TE Part # 566436-2
THRU SPLICE 5K CE SAPR081F116O



TE Part # 7-566436-7
SPARE PARTS KIT



TE Part # 160659-2
SPLICE 800-2500 .016 NPST

Also in the Series | **SPLICE**

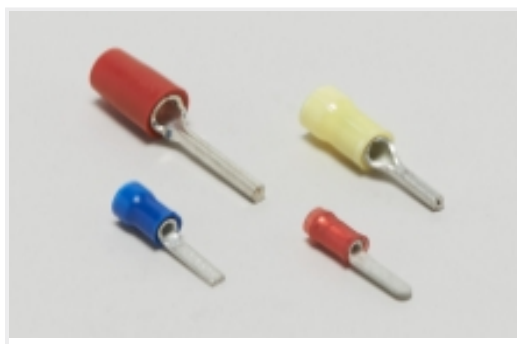

Crimp Wire Pins, Tabs & Ferrules(1)



Splices(63)

Customers Also Bought

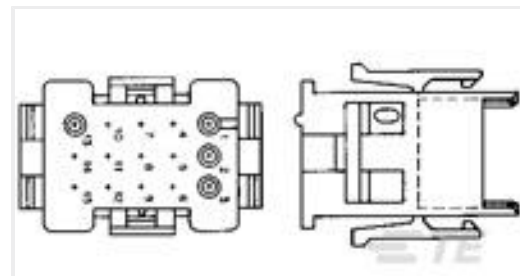
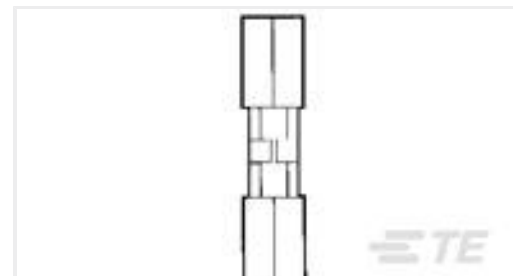
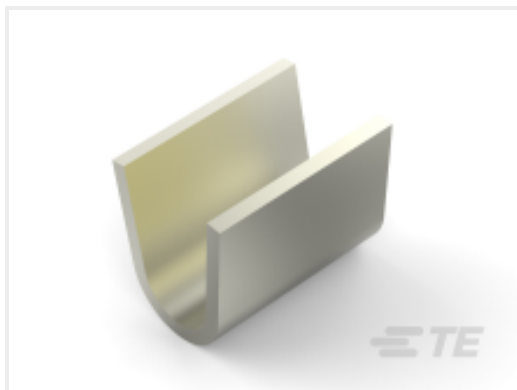
TE Part #1658642-2
PLUG ASSY,9P,HDP-20,CNTE Part #1-640509-0
04P MR II CAP HSG V0TE Part #324001
SPLICE,SOLIS BUTT STRAP 24-20TE Part #42579-1
250 FASTON REC 16-12 AWG NPSTTE Part #485043-4
SPLICE 4000-9000 .020 NPSTTE Part #350557-1
MNL SOK SPECIAL .0126PTPBRTE Part #1-480698-1
02P UMNL PLUG HSG BRNTE Part #2-36150-1
TERM, RING, PIDG, 22-16, 6, T&RTE Part #32958
TERMINAL,PG R 16-14 6TE Part #5-2151112-1
OCEAN_2.0_Applicator-S-070F140F-RSM

Documents

Product Drawings

[SPLICE 18-16 AWG .0126 NPST](#)

English

CAD Files

[3D PDF](#)

3D

[Customer View Model](#)

[ENG_CVM_CVM_61021-1_H.2d_dxf.zip](#)



English

Customer View Model

[ENG_CVM_CVM_61021-1_H.3d_igs.zip](#)

English

Customer View Model

[ENG_CVM_CVM_61021-1_H.3d_stp.zip](#)

English

By downloading the CAD file I accept and agree to the [Terms and Conditions](#) of use.

Product Specifications

[Application Specification](#)

English