

REVISIONS					
P	LTR	DESCRIPTION	DATE	DN	APVD
G6		ECR-25-261431	28NOV2025	ABS	PS

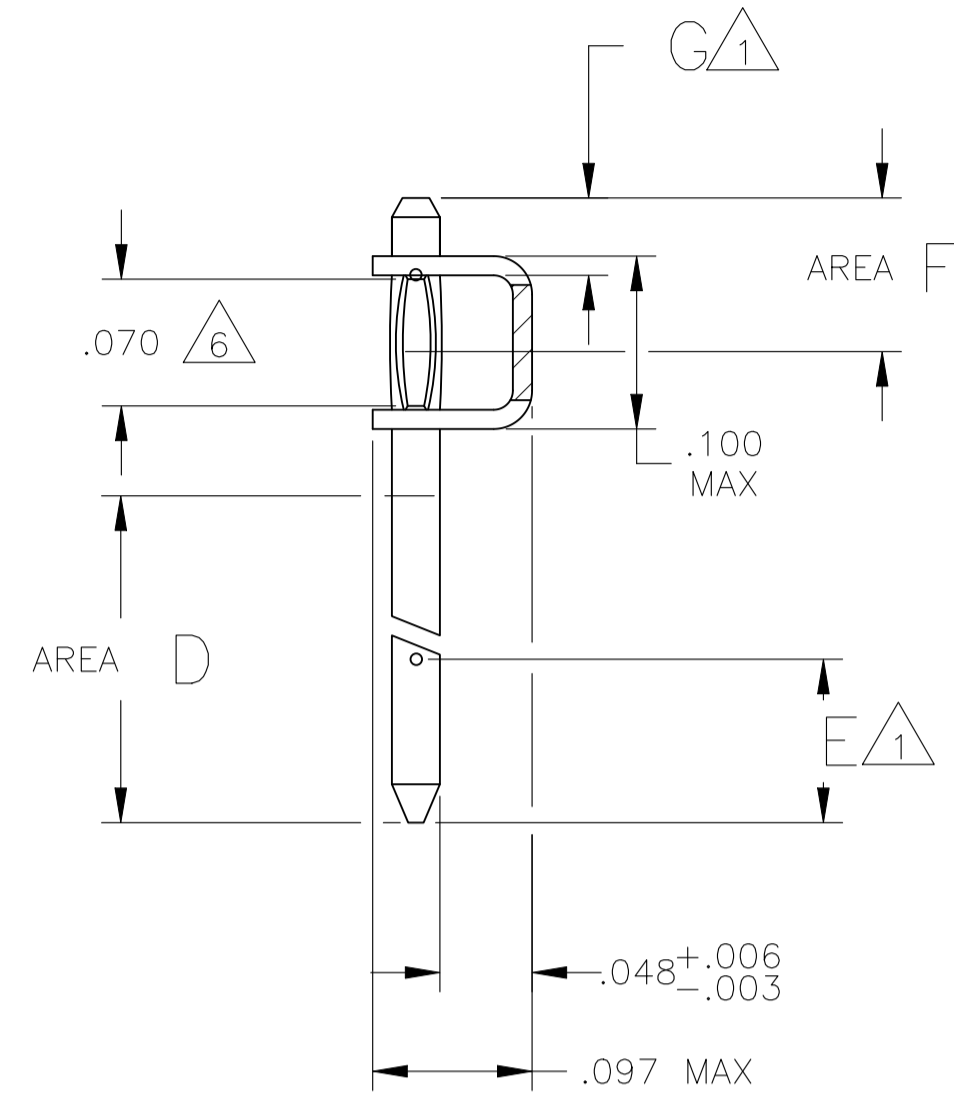
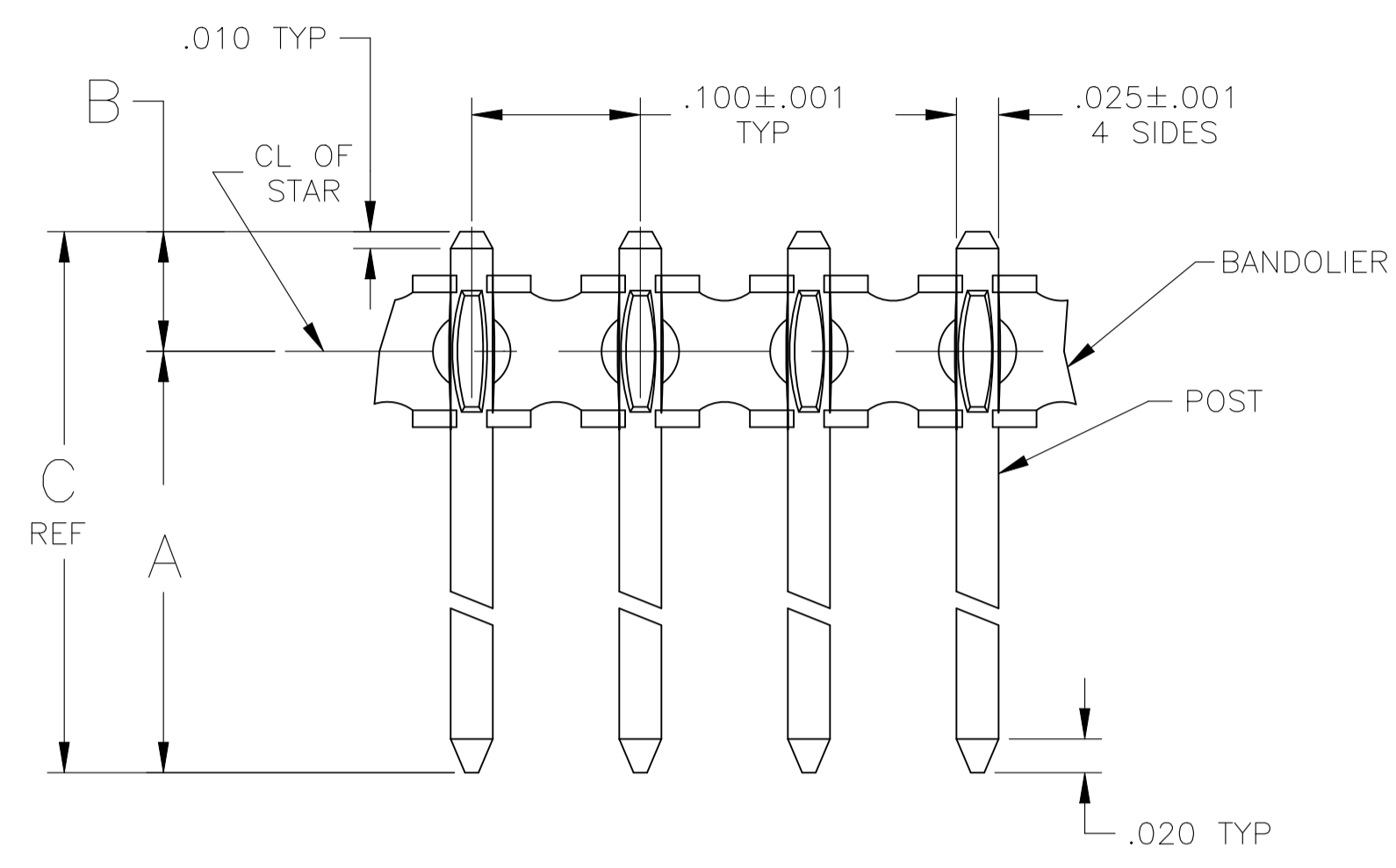

NOTES:

- 1 POINT OF MEASUREMENT FOR PLATING THICKNESS
- 2 .000030 GOLD ON AREA D, .000100 - .000200 MATTE TIN-LEAD ON AREA F, ALL OVER .000050 - .000100 NICKEL ENTIRE POST
- 3 .000100 - .000200 BRIGHT TIN-LEAD OVER .000050 - .000100 NICKEL ENTIRE POST
- 4. RECOMMENDED P.C.BOARD HOLE SIZE:
 

P C BOARD THICKNESS	PLATED HOLE SIZE	UNPLATED HOLE SIZE
.062	.034±.002	.036±.002
.093	.034±.002	.036±.002
.125	.034±.002	.036±.002
- 5 .000015 GOLD ON AREA D, .000100 - .000200 MATTE TIN-LEAD ON AREA F, ALL OVER .000050 - .000100 NICKEL ENTIRE POST.
- 6 DIMENSION PERTAINS TO THE LENGTH OF THE INTERFERENCE AREA OF THE STAR.
- 7 PRELIMINARY PART - NOT RELEASED FOR PRODUCTION.
- 8 .000030 GOLD ON AREA D, .000100-.000200 MATTE TIN ON AREA F, ALL OVER .000050 - .000100 NICKEL ENTIRE POST.
- 9 .000100-.000200 MATTE TIN OVER .000050 - .000100 NICKEL ENTIRE POST.
- 10 .000015 GOLD ON AREA D, .000100-.000200 MATTE TIN ON AREA F, ALL OVER .000050 - .000100 NICKEL ENTIRE POST.
- 11 ROHS 2002/95/EC COMPLIANT.
- 12 OBSOLETE PARTS: OBSOLETE CIS STREAMLINING PER D.RENAUD/D.SINISI

12	OBSOLETE	.245	10	.015	.080	.080	.230	.451	.071	.380	11	6-103577-9	
12	OBSOLETE	.235	10	.015	.080	.100	.185	.341	.071	.270	11	6-103577-7	
		.283	10	.015	.080	.100	.185	.389	.071	.318	11	6-103577-5	
12	OBSOLETE	.318	10	.015	.080	.100	.200	.424	.071	.353	11	6-103577-3	
		.235	9	-	-	-	-	.341	.071	.270	11	6-103577-1	
12	OBSOLETE	.283	9	-	-	-	-	.389	.071	.318	11	5-103577-9	
12	OBSOLETE	.318	9	-	-	-	-	.424	.071	.353	11	5-103577-7	
	OBSOLETE	.235	8	.015	.080	.100	.185	.341	.071	.270	11	5-103577-5	
		.283	8	.015	.080	.100	.185	.389	.071	.318	11	5-103577-3	
		.318	8	.015	.080	.100	.200	.424	.071	.353	11	5-103577-1	
12	OBSOLETE	.245	5	.015	.080	.080	.230	.451	.071	.380		1-103577-9	
	OBSOLETE	.235	5	.015	.080	.100	.185	.341	.071	.270		1-103577-7	
	SUPERSEDED BY 6-103577-5			.283	5	.015	.080	.100	.185	.389	.071	.318	1-103577-5
		OBSOLETE		.318	5	.015	.080	.100	.200	.424	.071	.353	1-103577-3
	SUPERSEDED BY 6-103577-1			.235	3	-	-	-	.341	.071	.270	1-103577-1	
12	OBSOLETE	.283	3	-	-	-	-	.389	.071	.318		103577-9	
		OBSOLETE		.318	3	-	-	-	.424	.071	.353	103577-7	
		OBSOLETE		.235	2	.015	.080	.100	.185	.341	.071	.270	103577-5
	SUPERSEDED BY 5-103577-3			.283	2	.015	.080	.100	.185	.389	.071	.318	103577-3
				.318	2	.015	.080	.100	.200	.424	.071	.353	103577-1
	MATING HEIGHT ABOVE BOARD (REF)	FINISH	G	F	E	D	C	B	A	ASSEMBLY PART NUMBER			

THIS DRAWING IS A CONTROLLED DOCUMENT.

DIMENSIONS: INCHES	TOLERANCES UNLESS OTHERWISE SPECIFIED:	DIN G DOUTY 12AUG87	12SEP87				
0. PLC ± -	1. PLC ± -	APVD R.FEIDT	NAME				
2. PLC ± -	3. PLC ± .005	APVD R.FELICKER	PRODUCT SPEC	ASSEMBLY, BANDOLIER, .100 CL, .025 SQUARE POSTS			
4. PLC ANGLES ± -	FINISH BANDOLIER - NONE	APVD	APPLICATION SPEC				
MATERIAL BANDOLIER - BRASS	POST - PHOS BRONZE	WEIGHT	SIZE A1	00779	SCALE 10:1	SHEET 1 of 1	REV G6