

NOTES:

- 梱包数量 : 380/リール
NUMBER OF CONNECTORS : 380PIECES/REEL
- リードテープ長さ
LEAD TAPE LENGTH
- 材料
MATERIALS
キャリアテープ : ポリスチレン(PS)
CARRIER TAPE : POLYSTYRENE(PS)
トップテープ : ポリエステル(PET)、その他
TOP TAPE : POLYESTER(PET)、OTHER
リール : ポリスチレン(PS) リサイクル材を含む
REEL : POLYSTYRENE(PS) RECYCLE MATERIAL CONTAINED
- 製品詳細寸法については製品単体図面を参照して下さい。
FOR THE DETAIL OF CONNECTOR DIMENSIONS,
PLEASE REFER TO THE DRAWING OF CONNECTOR.

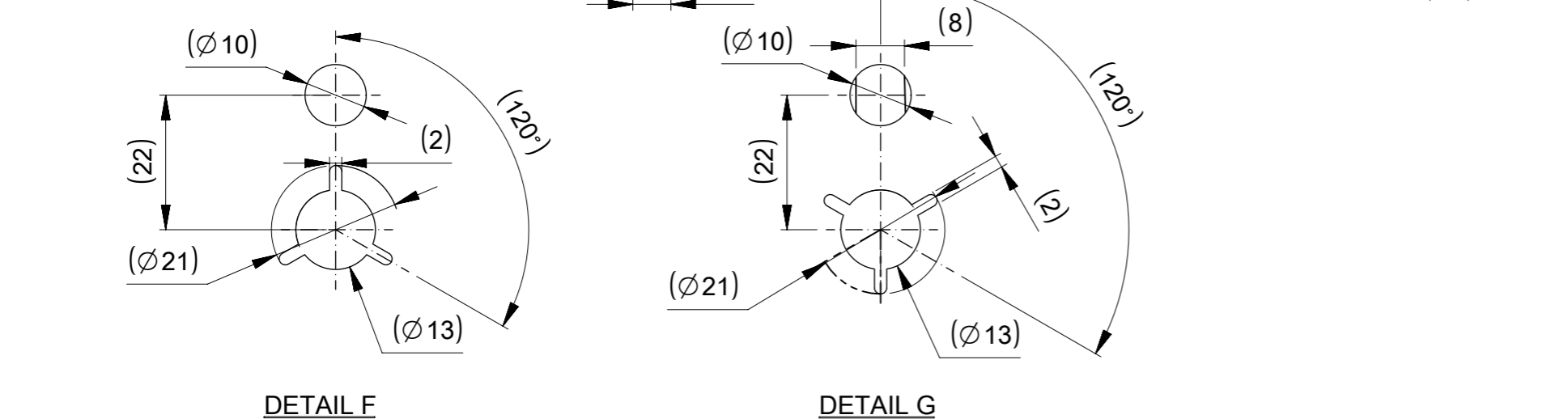
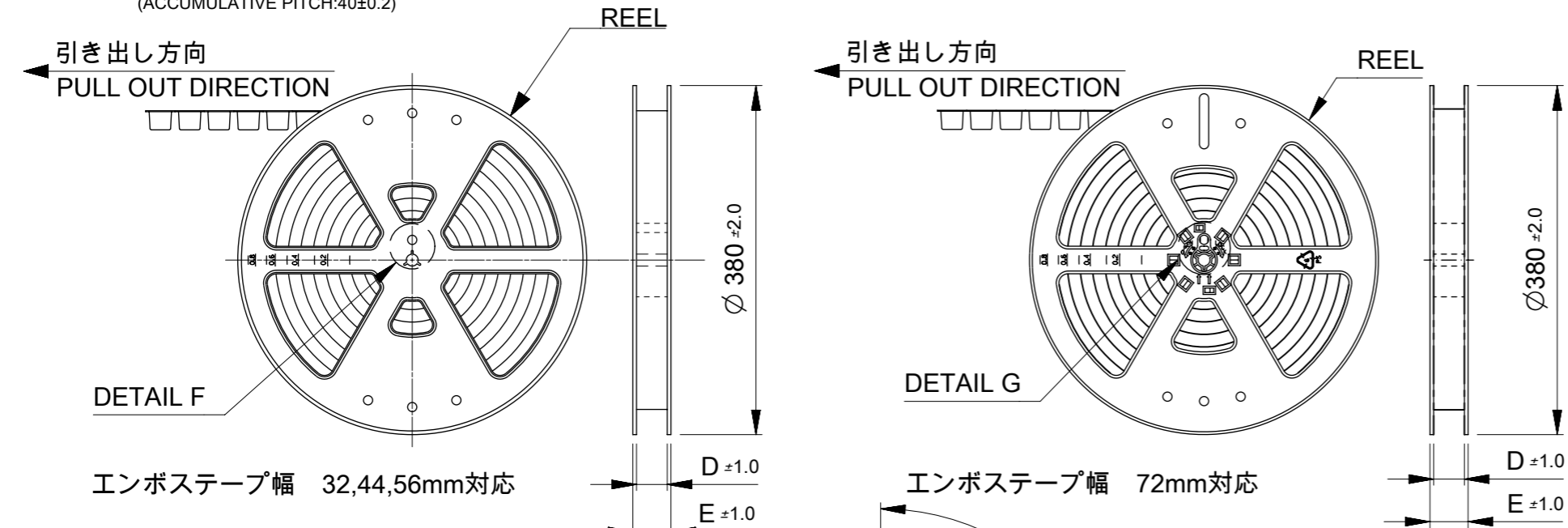
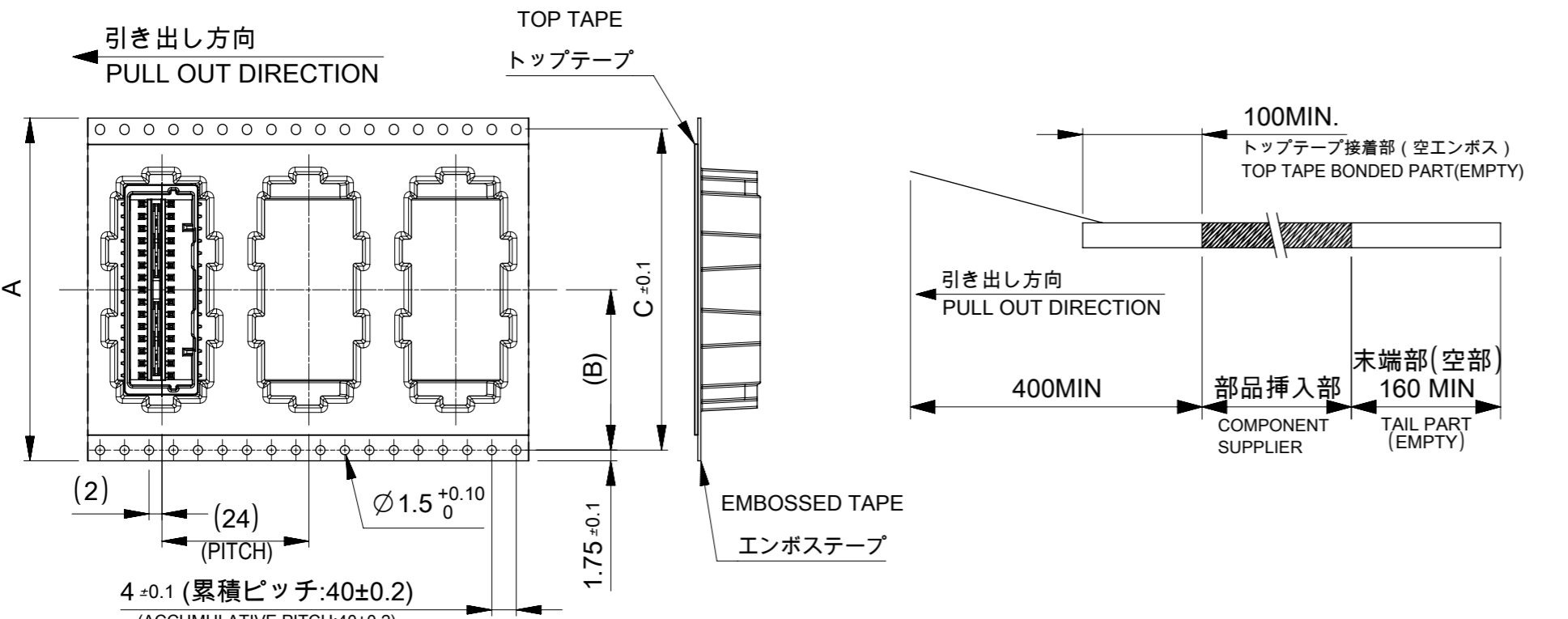

78.1	73.5	68.4	34.2	72 ^{+0.4} _{-0.3}	2011972400	40
					201197 040*	40
					201197 038*	38
					201197 036*	36
					201197 034*	34
61.4	57.4	52.4	26.2	56 ± 0.3	201197 032*	32
					201197 030*	30
					201197 028*	28
					201197 026*	26
					201197 024*	24
49.4	45.4	40.4	20.2	44 ± 0.3	201197 022*	22
					201197 020*	20
					201197 018*	18
					201197 016*	16
					201197 014*	14
37.4	33.4	28.4	14.2	32 ± 0.3	201197 012*	12
					201197 010*	10
E	D	C	B	A エンボステープ幅 WIDTH OF TAPE	オーダー番号 ORDER NO.	極数 CKT NO.

THIS DRAWING CONTAINS INFORMATION THAT IS PROPRIETARY TO MOLEX ELECTRONIC TECHNOLOGIES, LLC AND SHOULD NOT BE USED WITHOUT WRITTEN PERMISSION

DIMENSION UNITS mm	SCALE NTS	CURRENT REV DESC: RETRACTED AS PER PCN#517165	molex	
GENERAL TOLERANCES (UNLESS SPECIFIED)				
ANGULAR TOL	± 3.0 °	EC NO: 831181	PRODUCT CUSTOMER DRAWING	
4 PLACES	± 0.2	DRWN: PONNAM	2025/08/08	
3 PLACES	± 0.2	CHK'D: GGA	2025/08/22	
2 PLACES	± 0.2	APPR: GGA	2025/08/22	
1 PLACE	± 0.2	INITIAL REVISION:	DOCUMENT NUMBER	
0 PLACES	± 0.2	DRWN: MHAYASHI	2017/08/15	2017/08/24
		APPR: TKANEKO	2017/08/15	2017/08/24
DRAFT WHERE APPLICABLE MUST REMAIN WITHIN DIMENSIONS		THIRD ANGLE PROJECTION	DRAWING	SERIES
		⊕	A3-SIZE	201197
		MATERIAL NUMBER	CUSTOMER	SHEET NUMBER
		SEE CHART		1 OF 2

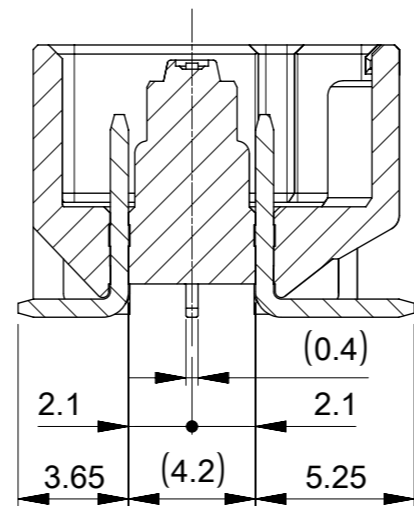
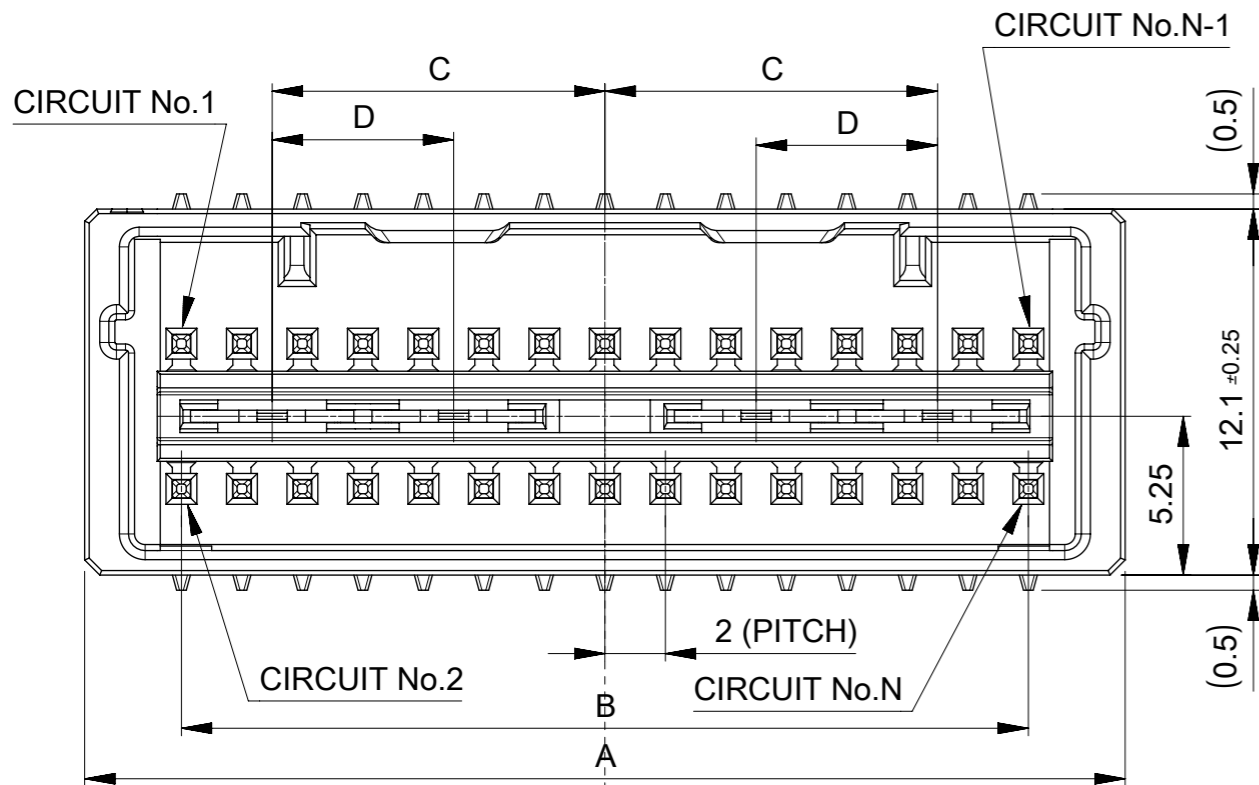

SECTION A-A

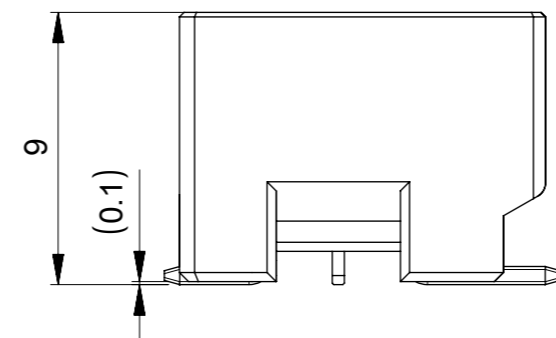
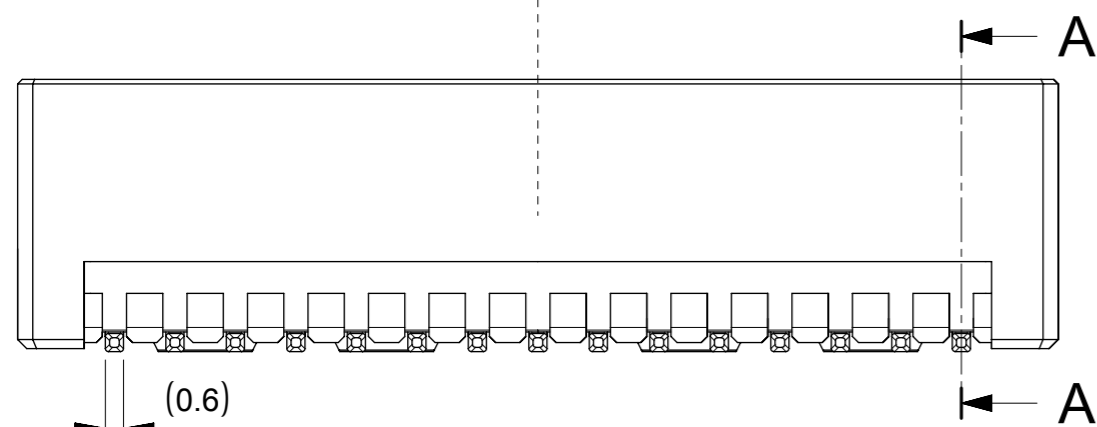

- NOTE**
- 1.嵌合相手 : 201196 2***
MATE WITH:201196 2***
 - 2.ターミナル及びネイルの平坦度 : 0.1MAX.
TERMINAL AND NAIL COPLANARITY TO BE 0.1MAX.
 - 3.製品番号 MATERIAL NO.
201197 * ** *

色 キータイプ
COLOR KEY TYPE

極数
CIRCUIT SIZE

0: WITHOUT KAPTON TAPE
2: WITH KAPTON TAPE

NO.	COLOR	KEY TYPE
0	NATURAL	1
1	BLACK	2
2	RED	3
3	YELLOW	4
4	BLUE	5

5	6	16	38	44.4	201197*40*	40
5	6	15	36	42.4	201197038*	38
5	6	14	34	40.4	201197036*	36
5	6	13	32	38.4	201197034*	34
5	6	12	30	36.4	201197032*	32
4	6	11	28	34.4	201197030*	30
4	6	10	26	32.4	201197028*	28
4	6	9	24	30.4	201197026*	26
3	---	8	22	28.4	201197024*	24
3	---	7	20	26.4	201197022*	22
3	---	6	18	24.4	201197020*	20
2	---	5	16	22.4	201197018*	18
2	---	4	14	20.4	201197016*	16
2	---	3	12	18.4	201197014*	14
1	---	---	10	16.4	201197*12*	12
1	---	---	8	14.4	201197010*	10
NAIL QTY	D	C	B	A	エンボス梱包 EMBOSSED PKG	極数 CKT NO.
					オーダー番号 ORDER NO.	

部品 PART	材質 MATERIAL
ハウジング HOUSING	ポリアミド(PA)、ガラス充填、UL94 V-0 POLYAMIDE(PA),GLASS FILLED, UL94 V-0
ターミナル TERMINAL	黄銅 BRASS
	錫めっき、リフロー処理(前めっき) : 1.0µm以上 PRE-TIN PLATED (HEAT TREATED MATTE TIN) : 1.0 micro-meter MIN.
	銅めっき(下地) : 0.5µm以上 COPPER (UNDER PLATING) : 0.5 micro-meter MIN.
ネイル NAIL	黄銅 BRASS
	錫めっき : 1.0µm以上 MATTE TIN : 1.0 micro-meter MIN.
	ニッケルめっき(下地) : 1.0µm以上 NICKEL (UNDER PLATING) : 1.0 micro-meter MIN.

THIS DRAWING CONTAINS INFORMATION THAT IS PROPRIETARY TO MOLEX ELECTRONIC TECHNOLOGIES, LLC AND SHOULD NOT BE USED WITHOUT WRITTEN PERMISSION

DIMENSION UNITS mm	SCALE 4:1	CURRENT REV DESC:		molex	
GENERAL TOLERANCES (UNLESS SPECIFIED)		EC NO: 850622			
ANGULAR TOL ± 3.0°	4 PLACES ±	DRWN: VKAMAK	2025/10/10	SPOT-ON 2.0 W/B DUAL ROW SMT PLUG ASSY	
3 PLACES ±	2 PLACES ± 0.2	CHK'D: SMURUGESAN	2026/03/17	PRODUCT CUSTOMER DRAWING	
1 PLACE ± 0.2	0 PLACES ± 0.2	APPR: SMURUGESAN	2026/03/17	DOCUMENT NUMBER	
DRAFT WHERE APPLICABLE MUST REMAIN WITHIN DIMENSIONS		INITIAL REVISION: DRWN: MHAYASHI	2017/08/15	2011971300-SD	
THIRD ANGLE PROJECTION		APPR: TKANEKO	2017/08/24	DOC TYPE	DOC PART
DRAWING A3-SIZE		SERIES 201197	MATERIAL NUMBER SEE CHART	CUSTOMER	REVISION A4
SHEET NUMBER 1 OF 3					

MATING
KEY TYPE & COLOR

KEY TYPE:1
MAT No.:201197***0
COLOR:NATURAL

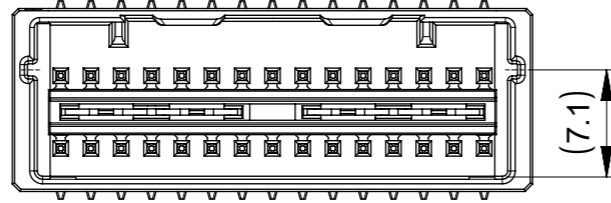

KEY TYPE:2
MAT No.:2011970**1
COLOR:BLACK

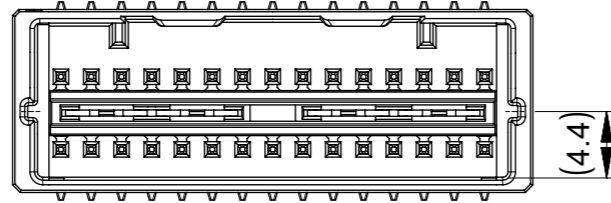

KEY TYPE:3
MAT No.:2011970**2
COLOR:RED

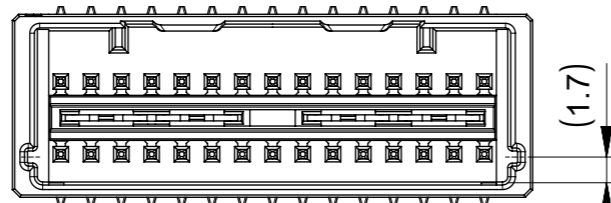

KEY TYPE:4
MAT No.:2011970**3
COLOR:YELLOW

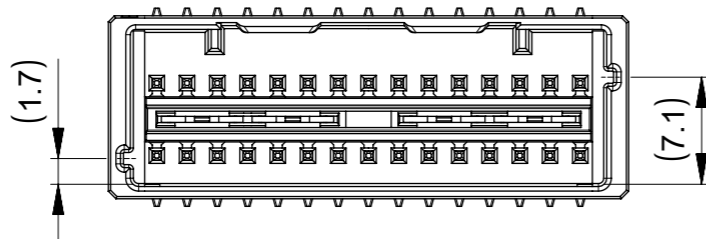

嵌合寸法
MATED DIMENSION

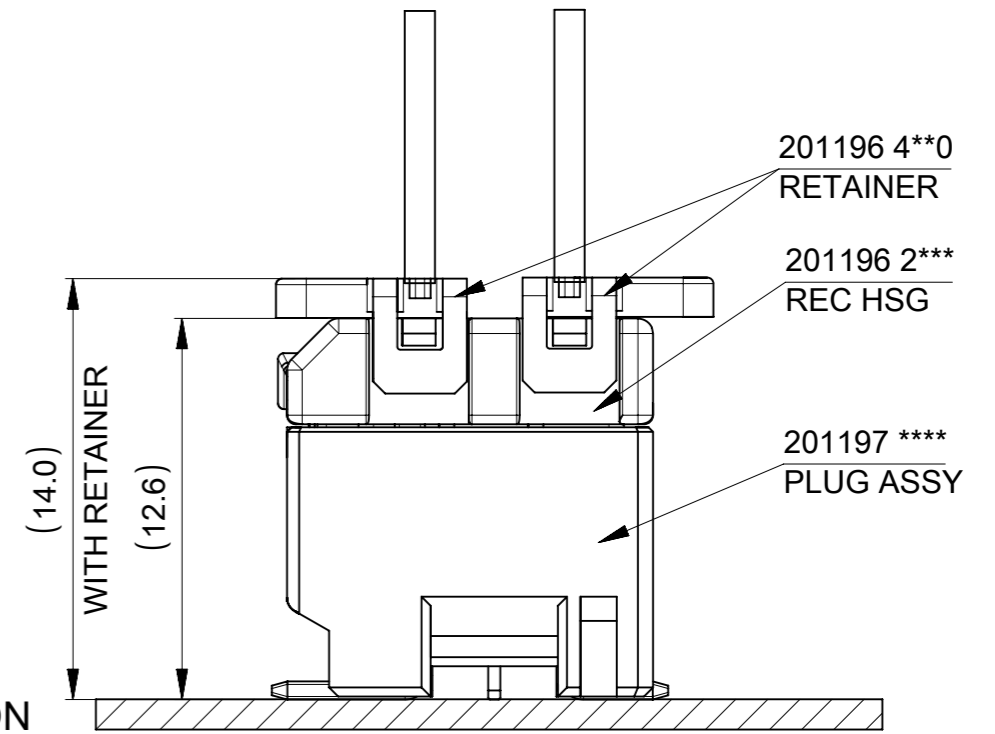

YELLOW	RED	BLACK	NATURAL		HSG COLOR
		201197 0401	201197 2400	201197 0400	40
				201197 0380	38
				201197 0360	36
				201197 0340	34
				201197 0320	32
201197 0303	201197 0302	201197 0301		201197 0300	30
				201197 0280	28
		201197 0261			26
		201197 0241			24
		201197 0221		201197 0220	22
		201197 0201			20
		201197 0181		201197 0180	18
		201197 0161		201197 0160	16
		201197 0141		201197 0140	14
		201197 0121	201197 2120	201197 0120	12
		201197 0101		2011970100	10

エンボス梱包 EMBOSSED PKG
オーダー番号 ORDER NO.

極数
CKT NO.

THIS DRAWING CONTAINS INFORMATION THAT IS PROPRIETARY TO MOLEX ELECTRONIC TECHNOLOGIES, LLC AND SHOULD NOT BE USED WITHOUT WRITTEN PERMISSION

DIMENSION UNITS mm	SCALE NTS 2:1	CURRENT REV DESC:	molex		
GENERAL TOLERANCES (UNLESS SPECIFIED)		EC NO: 850622			
ANGULAR TOL ± 3.0 °	4 PLACES ±	DRWN: VKAMAK 2025/10/10	PRODUCT CUSTOMER DRAWING		
3 PLACES ±	2 PLACES ± 0.2	CHK'D: SMURUGESAN 2026/03/17	DOCUMENT NUMBER		
2 PLACES ± 0.2	1 PLACE ± 0.2	APPR: SMURUGESAN 2026/03/17	2011971300-SD		DOC TYPE DOC PART REVISION
1 PLACE ± 0.2	0 PLACES ± 0.2	INITIAL REVISION:	PSD 000 A4		
DRAFT WHERE APPLICABLE MUST REMAIN WITHIN DIMENSIONS	THIRD ANGLE PROJECTION	DRWN: MHAYASHI 2017/08/15	MATERIAL NUMBER		SHEET NUMBER
		APPR: TKANEKO 2017/08/24	CUSTOMER		2 OF 3
			A3-SIZE	SERIES 201197	SEE CHART

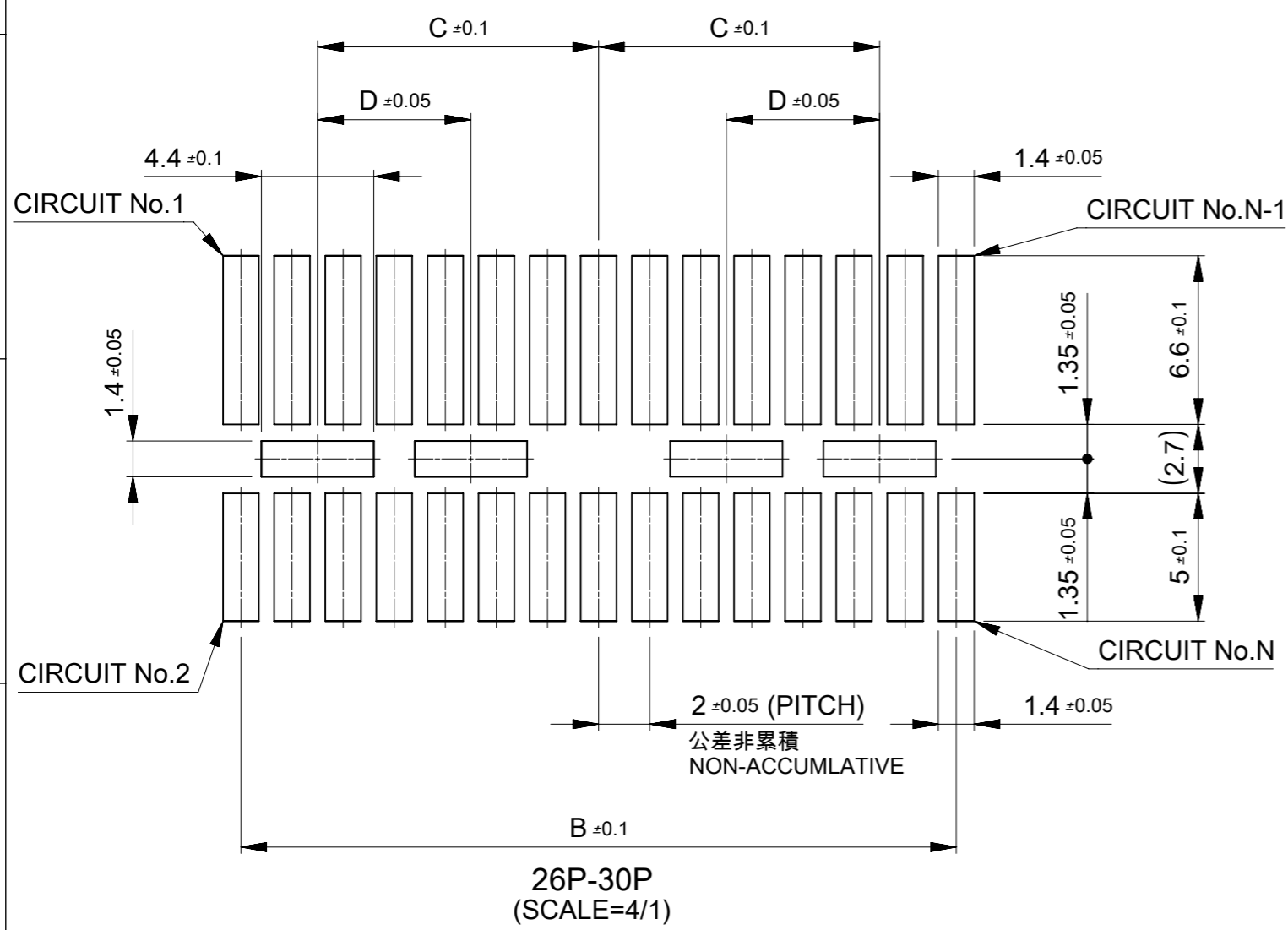

26P-30P
(SCALE=4/1)

推奨基板レイアウト

RECOMMENDED PWB PATTERN LAYOUT

(参考 : メタルマスク厚さ : 120μm, マスク開口率100%)

(REFERENCE : STENCIL THICKNESS : 120μm, APERTURE RATIO : 100%)

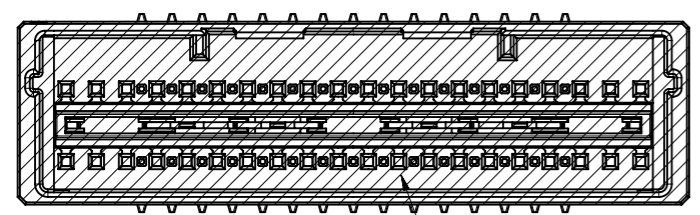

KAPTON TAPE

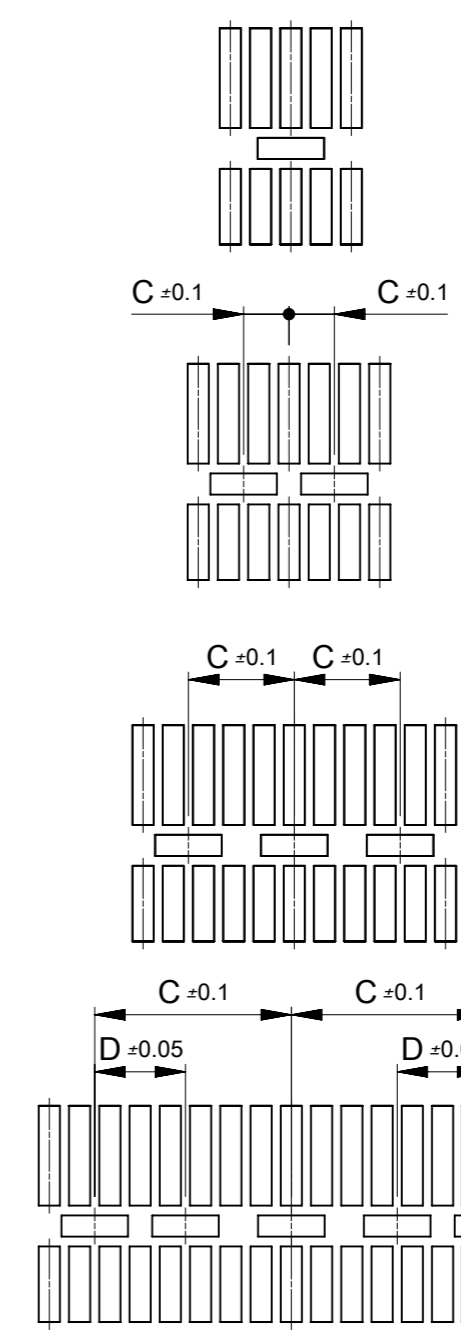
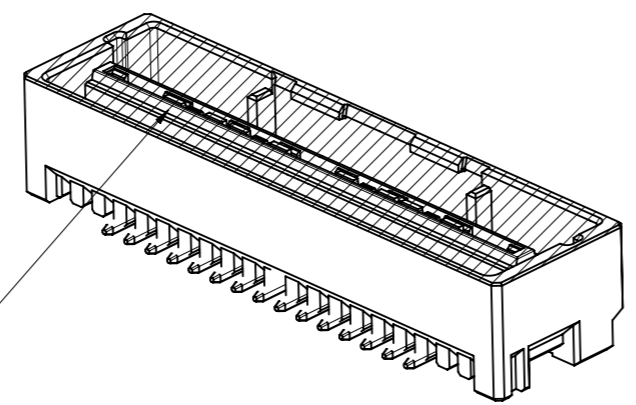

10P-12P

14P-18P

20P-24P

32P-40P

THIS DRAWING CONTAINS INFORMATION THAT IS PROPRIETARY TO MOLEX ELECTRONIC TECHNOLOGIES, LLC AND SHOULD NOT BE USED WITHOUT WRITTEN PERMISSION									
DIMENSION UNITS mm		SCALE NTS 2:1		CURRENT REV DESC:				molex	
GENERAL TOLERANCES (UNLESS SPECIFIED)				EC NO: 850622					
ANGULAR TOL ± 3.0°				DRWN: VKAMAK 2025/10/10				SPOT-ON 2.0 W/B DUAL ROW SMT PLUG ASSY	
4 PLACES ±				CHK'D: SMURUGESAN 2026/03/17				PRODUCT CUSTOMER DRAWING	
3 PLACES ±				APPR: SMURUGESAN 2026/03/17				DOCUMENT NUMBER	
2 PLACES ± 0.2				INITIAL REVISION:				2011971300-SD	
1 PLACE ± 0.2				DRWN: MHAYASHI 2017/08/15				DOC TYPE	
0 PLACES ± 0.2				APPR: TKANEKO 2017/08/24				PSD 000	
DRAFT WHERE APPLICABLE MUST REMAIN WITHIN DIMENSIONS				THIRD ANGLE PROJECTION		DRAWING		SERIES	
				A3-SIZE		201197		MATERIAL NUMBER	
				SEE CHART		CUSTOMER		REVISION	
								A4	
								SHEET NUMBER	
								3 OF 3	

DOCUMENT STATUS	P1	RELEASE DATE	2026/03/17	11:09:51
-----------------	----	--------------	------------	----------