

()

()

Amphenol
FCi

()

© 2016 AFCI

()

A

B

C

D

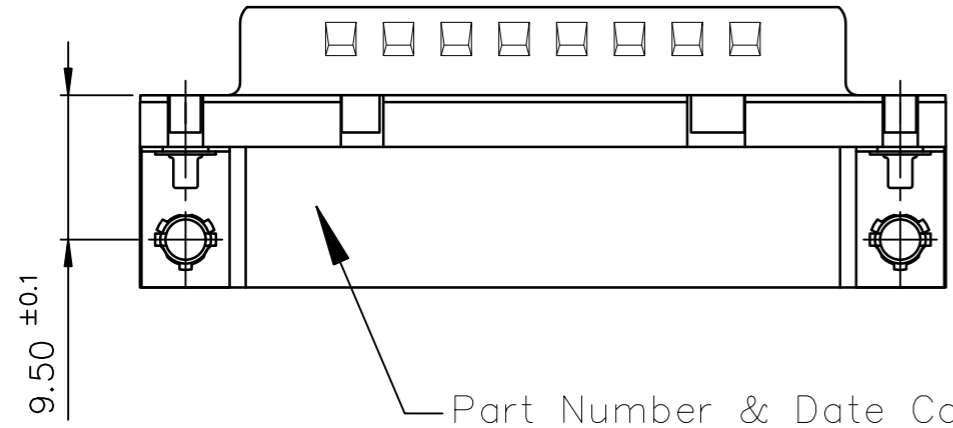
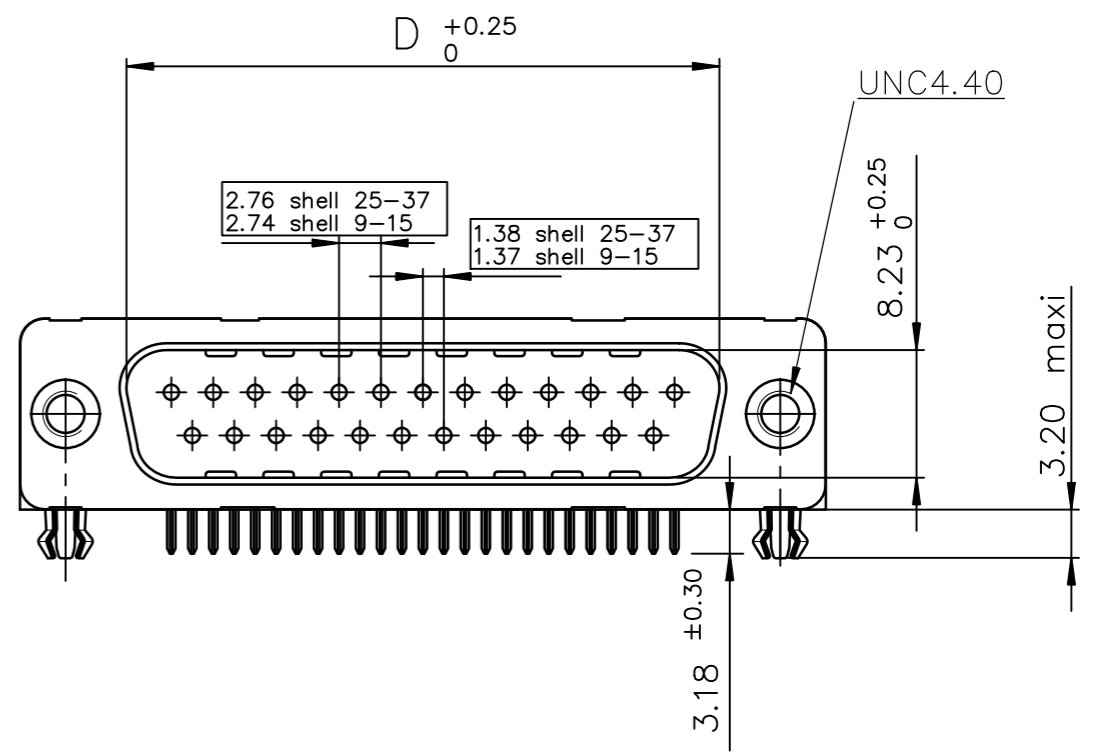
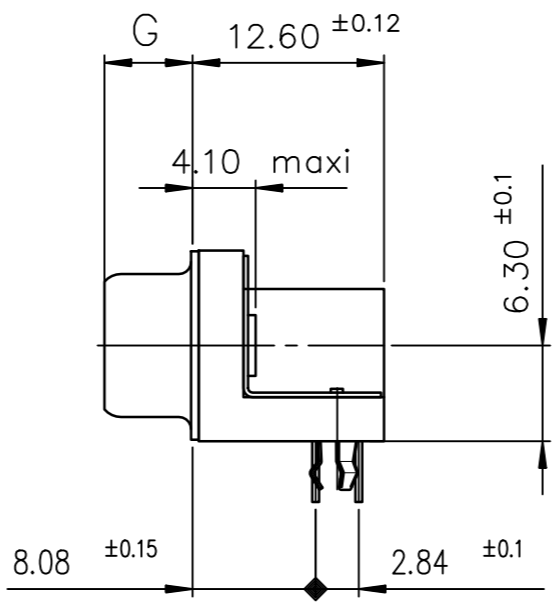
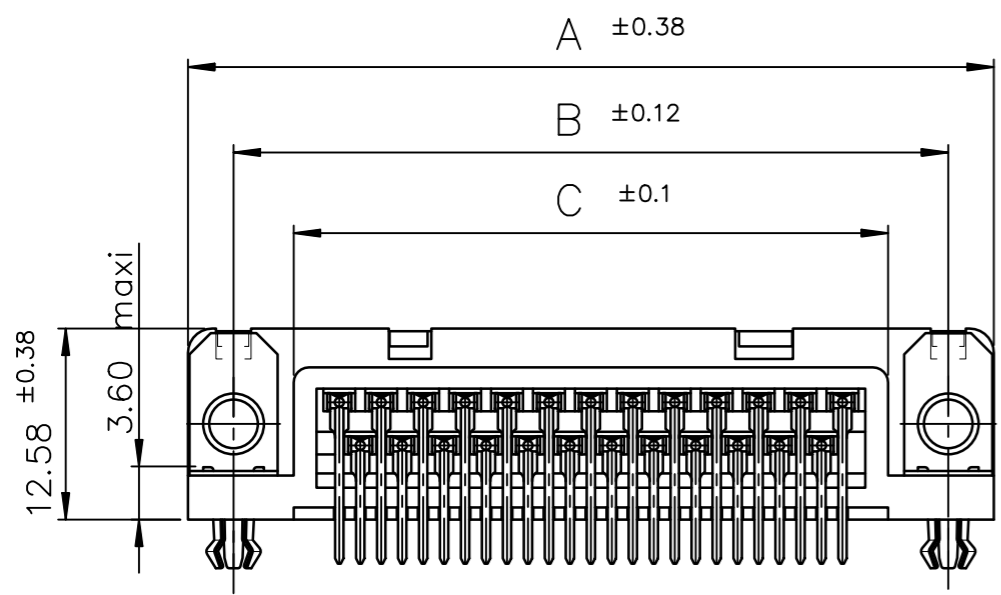

PC card drilling dimensions(after plating)
(thickness 1.60±0.20mm)

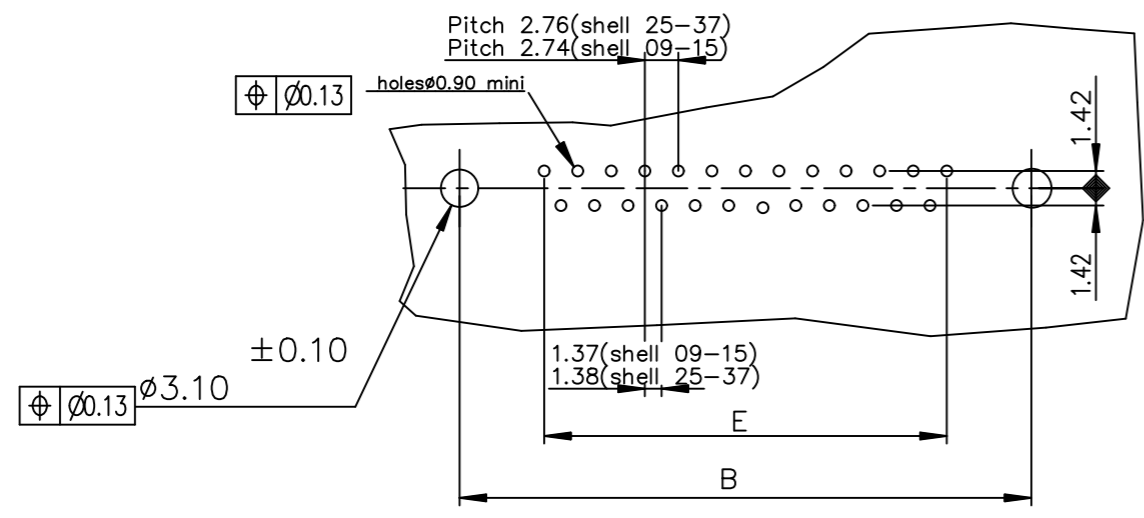

SHELL	A±0.38	B±0.12	C±0.10	D±0.25	E±0.07	G±0.25	PART NUMBER	
09	30.81	24.99	16.96	16.79	10.96	5.90	D09P33E4GX00LF	D09P33E6GX00LF
15	39.14	33.32	25.18	25.12	19.18	5.90	D15P33E4GX00LF	D15P33E6GX00LF
25	53.03	47.04	39.12	38.84	33.12	5.70	D25P33E4GX00LF	D25P33E6GX00LF
37	69.32	63.50	55.68	55.30	49.68	5.70	D37P33E4GX00LF	D37P33E6GX00LF
							200 Mating Cycles	500 Mating Cycles

GENERAL CHARACTERISTICS : SEE DRAWING C01-8646-0000

mat'l. code		surface		tolerance		projection		product family	
-		ISO 1302		ISO 406 ISO 1101		MM		D-SUB	
ltr		ecn no		dr		date		title	
D		ELX-I-18691		AB		2014-07-29		MALE CONNECTOR DD RIGHT ANGLED	
E		ELX-I-30554		GM		2018-06-27		with nut, harpoon and metal plate	
F		ELX-I-56519		GM		2025-07-15		dwg no	
								sheet 1 of 1	
								size	
								A3	
								type	
								Product Customer Drawing	

sheet index	revision	E							
	sheet	1							