

31899 ✓ ACTIVE

PIDG

TE Internal #: 31899

Closed Ring Tongue Terminal, 16 – 14 AWG, #8 Stud Size, 4.34 mm [.171 in] Stud Diameter, Closed Barrel, Straight, Tin, Partially Insulated, PIDG

[View on TE.com >](#)



Terminals & Splices > Ring Terminals

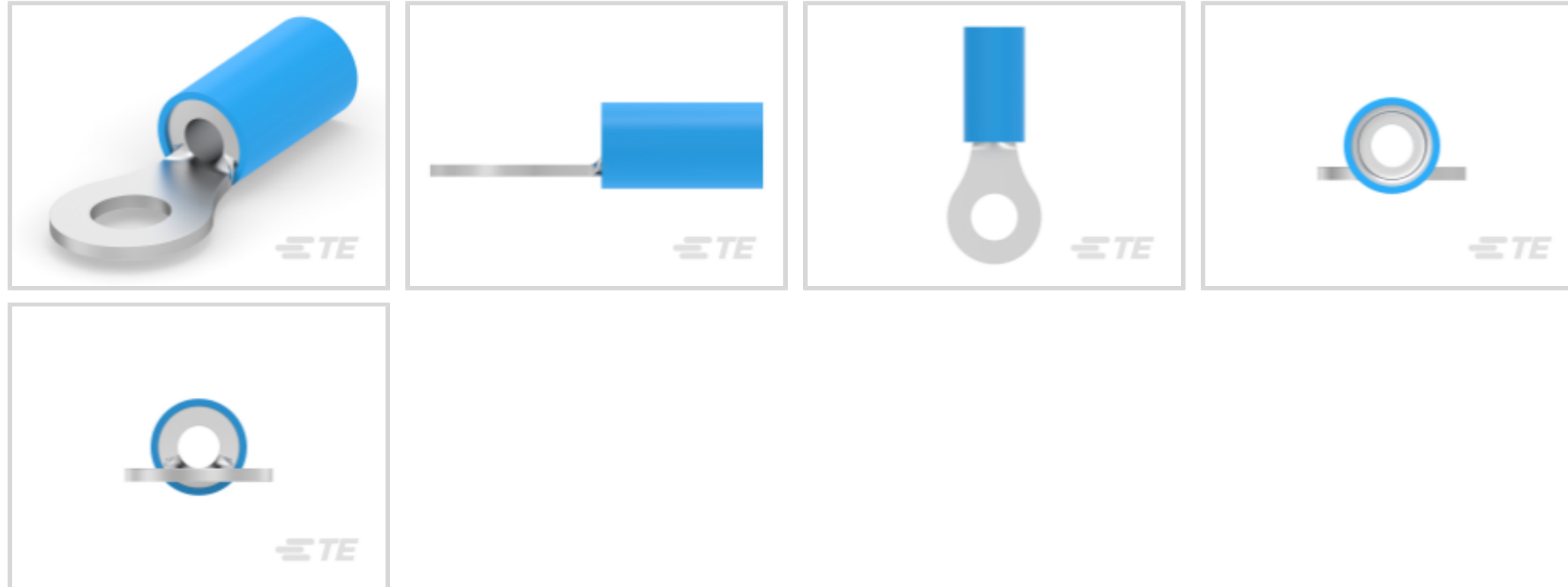

Ring Terminal Product Type: Closed Ring Tongue Terminal

Wire Size: 2050 – 5180 CMA

Stud Size: #8

Features

Product Type Features

Ring Terminal Product Type	Closed Ring Tongue Terminal
Stud Size	#8
Sealable	No
Wire Insulation Support Retention Type	Insulation Support

Dimensions

Wire Size	2050 – 5180 CMA
Stud Diameter	4.34 mm [.171 in]
Tongue Thickness	.79 mm [.03 in]
Product Length	22.83 mm [.899 in]
Compatible Insulation Diameter (Max)	3.81 mm [.15 in]
Compatible Insulation Diameter Range	2.67 – 3.81 mm [.105 – .15 in]
Compatible Insulation Diameter (Min)	2.68 mm [.105 in]

Contact Features

Barrel Type	Closed
Terminal Orientation	Straight



Terminal Plating Material	Tin
---------------------------	-----

Usage Conditions

Insulation Option	Partially Insulated
Operating Temperature Range	170 °C[338 °F]

Operation/Application

Compatible With Wire Base Material	Copper
Compatible With Wire Plating Material	Tin

Packaging Features

Packaging Method	Loose Piece
Packaging Quantity	100

Other

EU RoHS Compliance	Compliant
EU ELV Compliance	Compliant

Configuration Features

Number of Holes	1
-----------------	---

Body Features

Insulation Sleeve Color	Blue
Stripe Color	Blue

Mechanical Attachment

Wire Insulation Support	With
-------------------------	------

Industry Standards

Government Qualified Terminal	No
-------------------------------	----

Product Compliance

[For compliance documentation, visit the product page on TE.com>](#)

EU RoHS Directive 2011/65/EU	Compliant
EU ELV Directive 2000/53/EC	Compliant
China RoHS 2 Directive MIIT Order No 32, 2016	No Restricted Materials Above Threshold
EU REACH Regulation (EC) No. 1907/2006	Current ECHA Candidate List: JUNE 2024 (241) Candidate List Declared Against: JUNE 2024 (241) Does not contain REACH SVHC

Halogen Content	Not Low Halogen - contains Br or Cl > 900 ppm.
-----------------	--

Solder Process Capability	Not applicable for solder process capability
---------------------------	--

Product Compliance Disclaimer

This information is provided based on reasonable inquiry of our suppliers and represents our current actual knowledge based on the information they provided. This information is subject to change. The part numbers that TE has identified as EU RoHS compliant have a maximum concentration of 0.1% by weight in homogenous materials for lead, hexavalent chromium, mercury, PBB, PBDE, DBP, BBP, DEHP, DIBP, and 0.01% for cadmium, or qualify for an exemption to these limits as defined in the Annexes of Directive 2011/65/EU (RoHS2). Finished electrical and electronic equipment products will be CE marked as required by Directive 2011/65/EU. Components may not be CE marked. Additionally, the part numbers that TE has identified as EU ELV compliant have a maximum concentration of 0.1% by weight in homogenous materials for lead, hexavalent chromium, and mercury, and 0.01% for cadmium, or qualify for an exemption to these limits as defined in the Annexes of Directive 2000/53/EC (ELV). Regarding the REACH Regulation, the information TE provides on SVHC in articles for this part number is based on the latest European Chemicals Agency (ECHA) 'Guidance on requirements for substances in articles' posted at this URL: <https://echa.europa.eu/guidance-documents/guidance-on-reach>

Compatible Parts

<p>TE Part # 59250 T-HEAD PIDG 26-14 ASSY</p>	<p>TE Part # 59824-1 TETRA-CRIMP PIDG PG FASTON 22-10 ASSY</p>	<p>TE Part # 58433-3 PRO CR ASSY, RBY IS9252</p>	<p>TE Part # 47387 DAHT PG PIDG 20-14 ASSY</p>
<p>TE Part # 525691 DAHT PG PIDG 16-14 ASSY</p>	<p>TE Part # 539691-2 ERGO DIE R.B.Y</p>	<p>TE Part # 58423-1 DIE, RBY IS9252</p>	<p>TE Part # 2063030-1 SDE DIESET, RBY, UL</p>
<p>TE Part # 47807-1 DIES PIDG 16-14 DIE SET</p>	<p>TE Part # 169400 CERTI-LOK FRAME W/O DIES</p>	<p>TE Part # 169404 CERTI-LOK DIE</p>	

Also in the Series | PIDG



Compression Connectors(17)

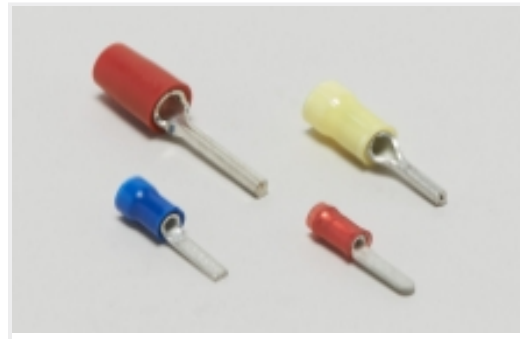

Crimp Wire Pins, Tabs & Ferrules(41)



Hand Crimping Tools(2)

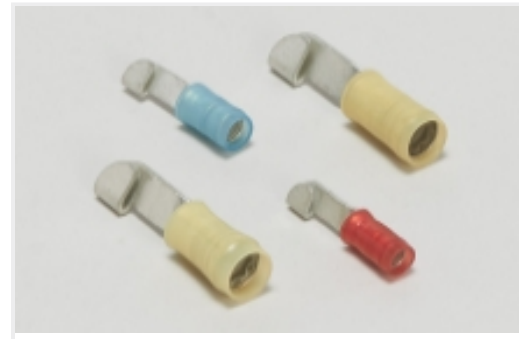

Knife Disconnects(11)



Quick Disconnects(32)



Ring Terminals(588)

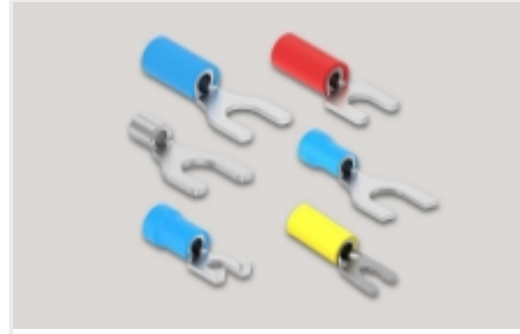

Spade Terminals(228)



Special Purpose Terminals(1)



Splices(39)

Customers Also Bought



TE Part #32836
PIDG Ring Tongue Terminals



TE Part #640915-1
RECEPT, PIDG FASTON 16-14 205

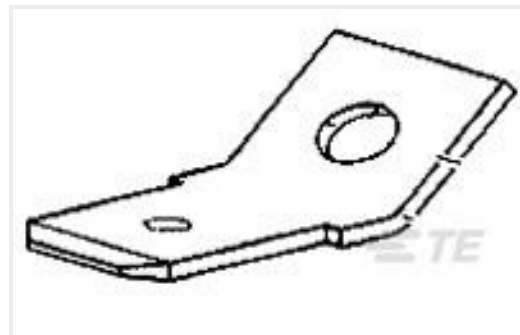

TE Part #60465-2
250 FASTON TAB TPBR

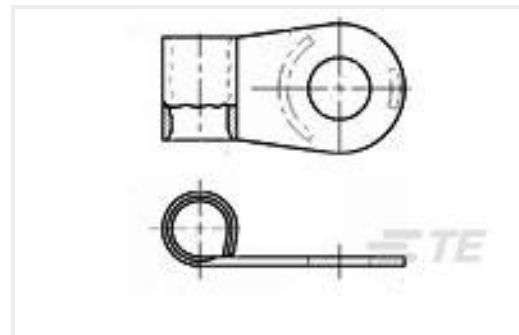

TE Part #36272
TERM, FLAG, SOLIS, 12-10, M6 (1/4)



TE Part #324955
TERMINAL, SOLIS R 16-14 8



TE Part #ZPF000000000004748
901-20 R 61-0 SX



TE Part #ZPF000000000004749
901-20 R 61-0 SY



TE Part #ZPF000000000005904
941-92 A 7-93 PN

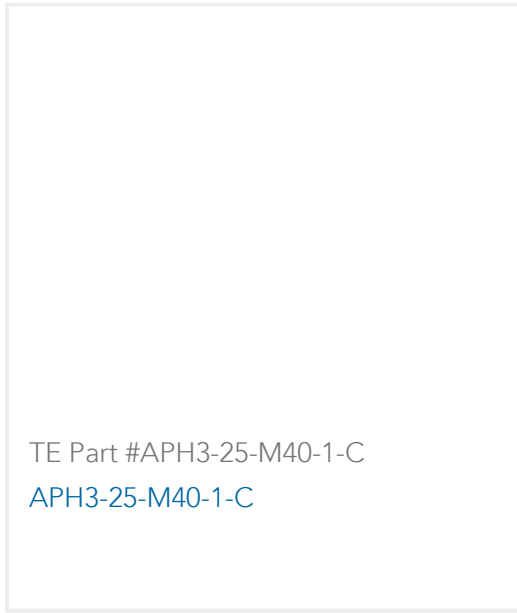

Documents

Product Drawings

[TERMINAL,PIDG R 16-14 8](#)

English

CAD Files

Customer View Model

[ENG_CVM_CVM_31899_AF1.2d_dxf.zip](#)

English

Customer View Model

[ENG_CVM_CVM_31899_AF1.3d_stp.zip](#)

English

[3D PDF](#)

3D

Customer View Model

[ENG_CVM_CVM_31899_AF1.3d_igs.zip](#)

English

By downloading the CAD file I accept and agree to the [Terms and Conditions](#) of use.

Instruction Sheets

[Instruction Sheet \(U.S.\)](#)

English

Agency Approvals

[UL Report](#)

English