

5-177912-1 ✓ ACTIVE



Power Double Lock

TE Internal #: 5-177912-1

Housing, Cap, Wire-to-Wire, 10 Position, 3.96 mm [.156 in]

Centerline, Wire & Cable, UL 94V-0, Power Double Lock,

Rectangular Power Connectors

[View on TE.com >](#)

Connectors > Power Connectors > Rectangular Power > Rectangular Power Connectors



EU RoHS Compliance: **Compliant**

EU ELV Compliance: **Compliant**

Rectangular Power Connector Type: **Housing**

Connector & Housing Type: **Cap**

Connector System: **Wire-to-Wire**

Features

Other

EU RoHS Compliance	Compliant
EU ELV Compliance	Compliant

Product Type Features

Rectangular Power Connector Type	Housing
Connector & Housing Type	Cap
Connector System	Wire-to-Wire
Sealable	No
Connector & Contact Terminates To	Wire & Cable

Configuration Features

Number of Positions	10
Number of Power Positions	10
Number of Signal Positions	0
Number of Rows	2

Electrical Characteristics

Operating Voltage	300 VAC
-------------------	---------

Contact Features

Contact Retention Within Housing	Without
Contact Type	Tab

Termination Features

Termination Method to Wire & Cable	Crimp
------------------------------------	-------

Mechanical Attachment

Connector Mounting Type	Panel Mount
-------------------------	-------------

Housing Features

Centerline (Pitch)	3.96 mm [.156 in]
Housing Color	Natural
Housing Material	Nylon 6/6

Dimensions

Row-to-Row Spacing	4.6 mm [.181 in]
--------------------	------------------

Usage Conditions

Operating Temperature Range	-30 – 105 °C [-22 – 221 °F]
-----------------------------	-----------------------------

Operation/Application

Circuit Application	Power
---------------------	-------

Industry Standards

UL Flammability Rating	UL 94V-0
Glow Wire Rating	GWT 750°C (Without Flame)

Packaging Features

Packaging Quantity	100
Packaging Method	Bag

Product Compliance

[For compliance documentation, visit the product page on TE.com>](#)

EU RoHS Directive 2011/65/EU	Compliant
EU ELV Directive 2000/53/EC	Compliant
China RoHS 2 Directive MIIT Order No 32, 2016	No Restricted Materials Above Threshold
EU REACH Regulation (EC) No. 1907/2006	



Current ECHA Candidate List: JUNE 2024 (241)
 Candidate List Declared Against: JUNE 2024 (241)
 Does not contain REACH SVHC

Halogen Content	Not Low Halogen - contains Br or Cl > 900 ppm.
-----------------	--

Solder Process Capability	Not reviewed for solder process capability
---------------------------	--

Product Compliance Disclaimer

This information is provided based on reasonable inquiry of our suppliers and represents our current actual knowledge based on the information they provided. This information is subject to change. The part numbers that TE has identified as EU RoHS compliant have a maximum concentration of 0.1% by weight in homogenous materials for lead, hexavalent chromium, mercury, PBB, PBDE, DBP, BBP, DEHP, DIBP, and 0.01% for cadmium, or qualify for an exemption to these limits as defined in the Annexes of Directive 2011/65/EU (RoHS2). Finished electrical and electronic equipment products will be CE marked as required by Directive 2011/65/EU. Components may not be CE marked. Additionally, the part numbers that TE has identified as EU ELV compliant have a maximum concentration of 0.1% by weight in homogenous materials for lead, hexavalent chromium, and mercury, and 0.01% for cadmium, or qualify for an exemption to these limits as defined in the Annexes of Directive 2000/53/EC (ELV). Regarding the REACH Regulation, the information TE provides on SVHC in articles for this part number is based on the latest European Chemicals Agency (ECHA) 'Guidance on requirements for substances in articles' posted at this URL: <https://echa.europa.eu/guidance-documents/guidance-on-reach>

Compatible Parts



TE Part # 177904-1
POWER D/LOCK PLUG HSG 10P



TE Part # CAT-P87024-R2435
Power Double Lock Receptacle



TE Part # CAT-P87024-T111
Power Double Lock Tab



TE Part # 177921-1
POWER D/LOCK PLATE 5P NATURAL

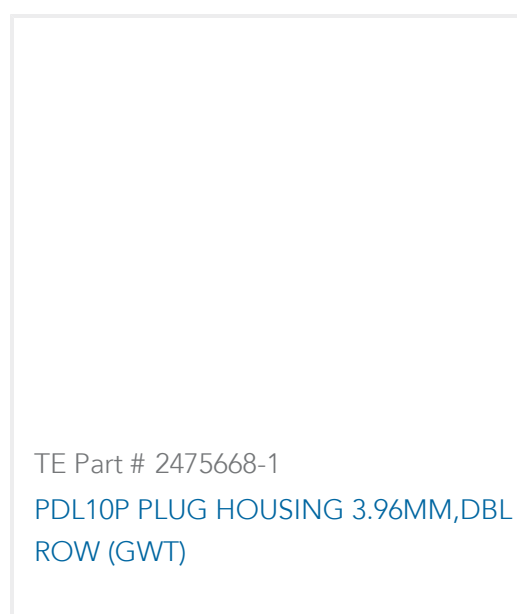

TE Part # 2475668-1
PDL10P PLUG HOUSING 3.96MM,DBL ROW (GWT)

Also in the Series | [Power Double Lock](#)



Connector Contacts(24)

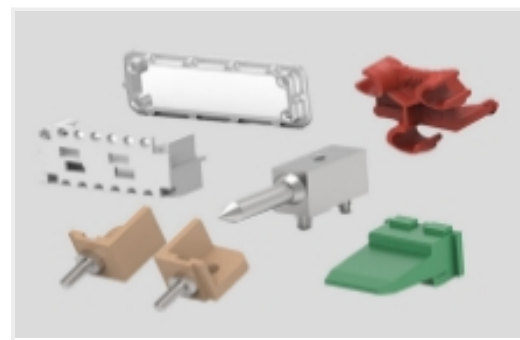

Connector Hardware(14)



Insertion & Extraction Tools(2)

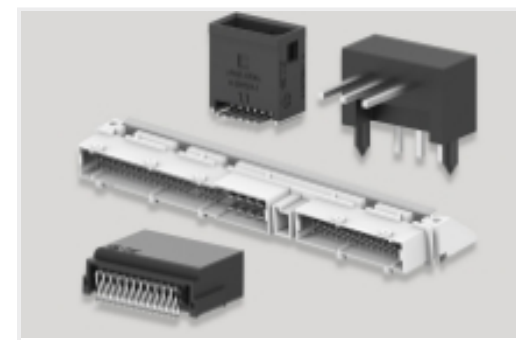

PCB Headers & Receptacles(43)



Rectangular Power Connectors(240)

Customers Also Bought



TE Part #179938-1
AMP POWER DBL LOCK PLUG HSG 3P



TE Part #177917-1
AMP POWER DBL LOCK TAB (L)



TE Part #175057-1
250 PL EX FLAG REC. 18-12AWG PTBR



TE Part #2-2372858-4
4P, RAST5 P-LOCK HEADER ASSY, OPPOSITE



TE Part #2232532-2
2P, PL RAST 5 Tab Header, TH, Vertical



TE Part #2292458-3
3P, RAST 5 HEADER, PL, SHROUDED SL



TE Part #2372858-5
5P, RAST5 P-LOCK HEADER ASSY, OPPOSITE



TE Part #2391828-4
ECONOMY POWER 2.5 PLUG HOUSING, 4P

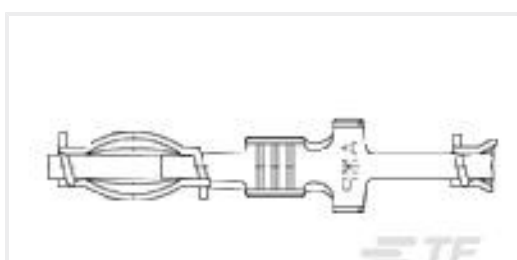

TE Part #170063-2
CLUSTER PIN REC

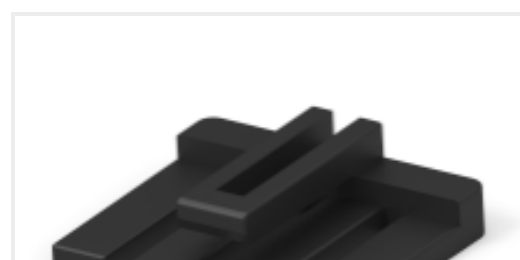

TE Part #2391827-4
ECONOMY POWER 2.5 TPA RETAINER, 4P

Documents



Product Drawings

POWER D/LOCK CAP HSG 10P NAT(GWT)

English

CAD Files

3D PDF

3D

Customer View Model

[ENG_CVM_CVM_5-177912-1_J.2d_dxf.zip](#)

English

Customer View Model

[ENG_CVM_CVM_5-177912-1_J.3d_igs.zip](#)

English

Customer View Model

[ENG_CVM_CVM_5-177912-1_J.3d_stp.zip](#)

English

By downloading the CAD file I accept and agree to the [Terms and Conditions](#) of use.

Product Specifications

Application Specification

English

Instruction Sheets

Instruction Sheet (non U.S.)

English

AMP POWER DOUBLELOCK CONNECTOR SERIES

English