

Contacts	Dimensions		
	A	B	C
4	2.0	4.6	/
6	4.0	6.6	2.0
8	6.0	8.6	4.0
10	8.0	10.6	6.0
12	10.0	12.6	8.0
14	12.0	14.6	10.0
16	14.0	16.6	12.0
18	16.0	18.6	14.0
20	18.0	20.6	16.0
22	20.0	22.6	18.0
24	22.0	24.6	20.0
26	24.0	26.6	22.0
28	26.0	28.6	24.0
30	28.0	30.6	26.0
32	30.0	32.6	28.0
34	32.0	34.6	30.0
36	34.0	36.6	32.0
38	36.0	38.6	34.0
40	38.0	40.6	36.0
42	40.0	42.6	38.0
44	42.0	44.6	40.0
46	44.0	46.6	42.0
48	46.0	48.6	44.0
50	48.0	50.6	46.0
52	50.0	52.6	48.0
54	52.0	54.6	50.0
56	54.0	56.6	52.0
58	56.0	58.6	54.0
60	58.0	60.6	56.0
62	60.0	62.6	58.0
64	62.0	64.6	60.0
66	64.0	66.6	62.0
68	66.0	68.6	64.0
70	68.0	70.6	66.0
72	70.0	72.6	68.0
74	72.0	74.6	70.0
76	74.0	76.6	72.0
78	76.0	78.6	74.0
80	78.0	80.6	76.0

Min. Insertion Depth 1.67 ref.
Max. Insertion Depth See Table

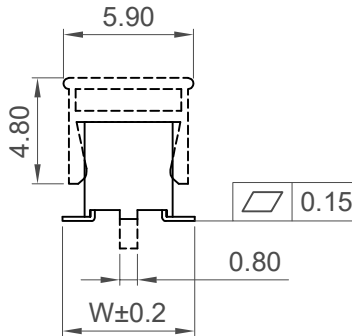

Insulator Height H	No. of Contacts	Dimension D	Max. Insertion Depth
4.30	04 ~ 16	4	4.50
	18 ~ 80	8.05	
4.00	04 ~ 16	4	4.30
	18 ~ 80	8.05	

Specifications

Material

Contact: Phosphor Bronze
Insulator:
Standard: Polyamide, High Temperature Nylon, UL 94V-0
Option: Polymer, LCP, UL 94V-0

Plating

See Ordering Grid

Electrical

Current Rating: 2 Amp Per Pin
Insulation Resistance: 1000 MΩ min
Contact Resistance: 20 mΩ max.
Dielectric Withstand Voltage: 500V AC

Mechanical & Environmental

Operating Temperature:
-40°C to +105°C (High Temperature Nylon)
-40°C to +125°C (LCP)

Soldering Process:

(High Temperature Nylon & LCP)
IR Reflow: 260°C for 10 sec.
Manual Solder: 350°C for 3-5 sec.

Mates with (Subject to pin length):

BF030 BF045 BF050 BF055
BF060 BF135 BF140 BF145

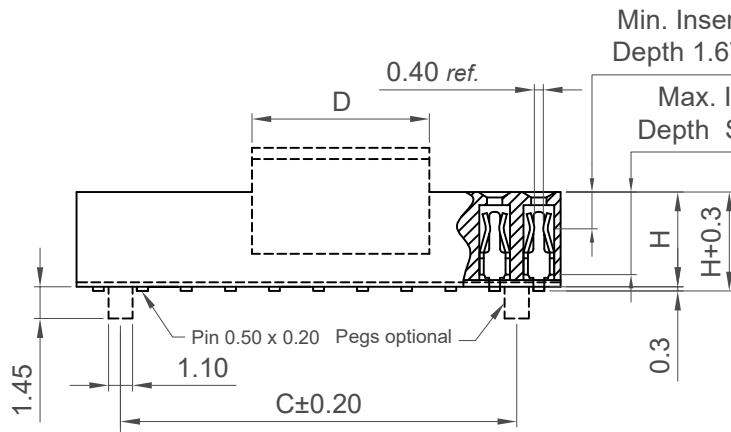

Ordering Grid

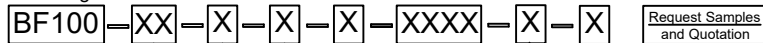

No. of Contacts
04 to 80

Contact Plating

A = Gold Flash All Over (Standard)
B = Selective Gold Flash Contact Area/
Tin On Tail
C = Tin All Over
G = 10µ" Gold Contact Area/Tin On Tail
I = 30µ" Gold Contact Area/Tin On Tail

Insulator Height 'H'

C = 4.00mm (Standard)
D = 4.30mm

Locating Peg
0 = No Peg
1 = With Peg

Packing Options

C = Tape and Reel with Film (Standard)
B = Tape and Reel with Cap
D = Tube (available from 6 contacts)
E = Tube with Cap (available from 6 contacts)
F = Tube with Film (available from 6 contacts)

Insulator Material

N = High Temperature Nylon (Standard)
L = LCP

Dimension W - Footprint Width (1/100mm)

'H' = 4.00mm: Standard - 6.25mm = 0625
Alternative - 5.00mm = 0500
'H' = 4.30mm: Standard - 6.40mm = 0640
Alternative - 5.60mm = 0560
- 6.25mm = 0625

Part Number		Product Description	
BF100		2.00mm Pitch Socket, Dual Row, Surface Mount,	
Drawing Date		4.3mm or 4.6mm Profile, Dual Entry	
31st October 2007			
By	MW	Tolerances (Except as Noted)	Units:
Detail	BF100 H PCN	Length X. ± 0.30 XX ± 0.25 XXX ± 0.15 XXXX ± 0.10	Metric (mm)
Revision	H4	Angle X° ± 5° XX° ± 3° XXX° ± 2° XXXX° ± 1°	3rd Angle Projection
Date	24/12/25		

Halogen Free

©

This drawing is confidential and copyright of Global Connector Technology, Ltd (GCT). This drawing must not be copied or disclosed without written consent. E & OE



Not to Scale
Drawn By LYH
Sheet No. 1/1