

PRODUCT NUMBER

91269-XXXXLF

- RoHS COMPATIBLE, SEE NOTE 6
- PACKAGING, SEE NOTE 3 (MAY BE SUBJECT TO TOOLING FEES)
- TOTAL NB OF POSITIONS, 3 TO 17

PLATING (AS AVAILABLE)

- 0 = 0.20µm GOLD/GXT ON CONTACT AREA
2.0µm MIN MATTE TIN ON TAILS
- 1 = 0.76µm GOLD/GXT ON CONTACT AREA
2.0µm MIN MATTE TIN ON TAILS
- 3 = 0.38µm GOLD/GXT ON CONTACT AREA
2.0µm MIN MATTE TIN ON TAILS
- T = FULL MATTE TIN 2µm-5µm
- 1.27µm Ni MIN UNDERPLATING ON ALL VERSIONS

EXTENDED RANGE

- TOOLING FEASIBILITY CONFIRMED
- SAMPLES ON DEMAND
- AVAILABILITY ON DEMAND

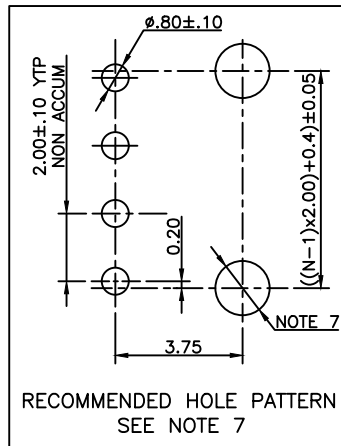
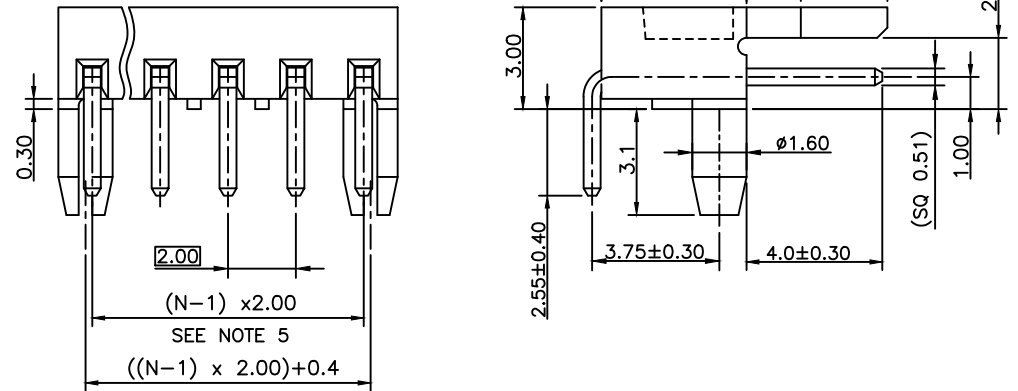
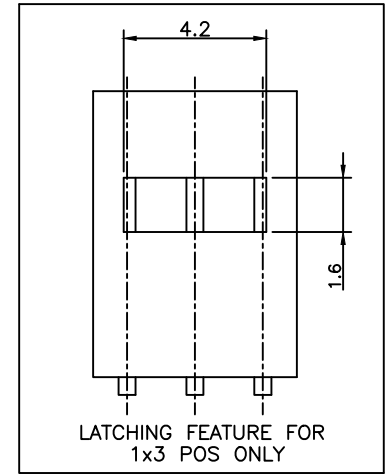
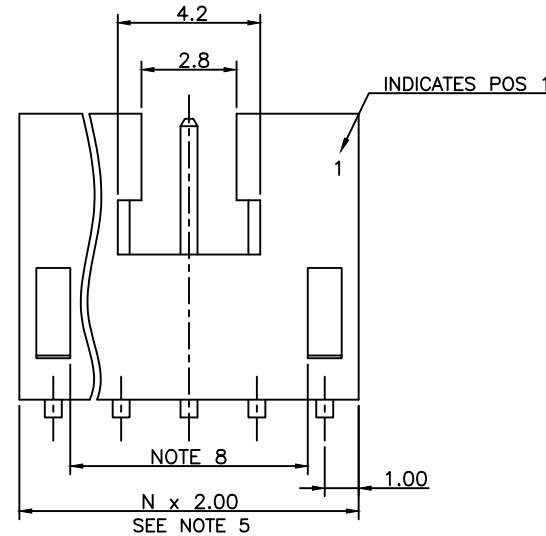

NOTES:

- HOUSING MATERIAL : HIGH TEMPERATURE THERMOPLASTIC. UL94V-0 COLOR: CREAM
- PIN MATERIAL : COPPER ALLOY
- PACKAGING = POLYBAGS TR = TAPE & REEL AS AVAILABLE.
- 7N MIN RETENTION IN EITHER DIRECTION
- TO DETERMINE DIMENSIONS : N = NUMBER OF POSITIONS EXAMPLE : 8 POS N x 2.0= 16.0mm
- RoHS COMPATIBLE PRODUCT SPECIFICATIONS
 - MANUFACTURING PROCESS COMPATIBILITY
 - THE HOUSING WILL WITHSTAND EXPOSURE TO 260°C ±5°C SOLDER BATH TEMPERATURE FOR 5 SECONDS IN A WAVE SOLDER APPLICATION WITH A 1.6mm MIN THICK CIRCUIT BOARD.
 - LABELLING:
 - MEETS PACKAGING SPECS AS PER GS-14-920
 - THIS PRODUCT MEETS EUROPEAN DIRECTIVES AND OTHER COUNTRY REGULATIONS AS DISCRIBED IN GS-47-0004
- HOLE DIMENSION TO BE $\phi 1.6 \pm 0.03$ FOR INTERFERENCE FIT APPLICATIONS, SEE SHEET 2. HOLE DIMENSIONS TO BE $\phi 1.95 \pm 0.05$ FOR LOCATION APPLICATION WITH AUTOMATIC PICK AND PLACE MACHINES.
- ODD NBR OF POS : 7.00mm
EVEN NBR OF POS : 5.00mm
- THIS PART SERIES IS NOT INITIALLY INTENDED FOR AUTOMOTIVE APPLICATIONS. ADDITIONAL FEES ARE CHARGEABLE FOR ANY ADDITIONAL QUALIFICATION AND TEST REPORTS PERFORMED OUTSIDE THE SCOPE OF THE STANDARD PRODUCT SPECIFICATIONS.
- UNLESS OTHERWISE APPROVED BY AMPHENOL, ALL PARTS AND COMPONENTS ARE DESIGNED & BUILT ACCORDING TO AMPHENOL'S SPECIFICATIONS WHICH ARE SUBJECT TO CHANGE WITHOUT NOTICE.

mat'l. code		surface ISO 1302 ✓		tolerance ISO 406 ISO 1101		projection		product family MINITEK	
Ltr	ecn no	dr	date	tolerances unless otherwise specified		mm		title	
L	B-16822	JCO	14.01.23	angles	linear	.X ±0.3	scale 5:1	MINITEK TMT SR RA POL & LATCHING	
M	B-19186	LMU	14.10.24			.XX ±0.13			
N	B-19986	JCO	15.01.13			.XXX ±0.05			
P	B-19995	JCO	15.01.15	dr	J.FABRE	13.01.07	dwg no		
R	F-23053	AMA	16.01.15	engr	J.FABRE	13.01.07	sheet 1 of 2		
S	F-55059	DDE	25.03.20	chr	P.NIZZI	13.01.07	size		
				appd	J.COMPAGNON	13.01.07	91269 A3		
sheet index		revision sheet	S B					type CUSTOMER Drawing	
			1 2						

RECOMMENDATION TO PLACE THE CONNECTOR ONTO THE PCB

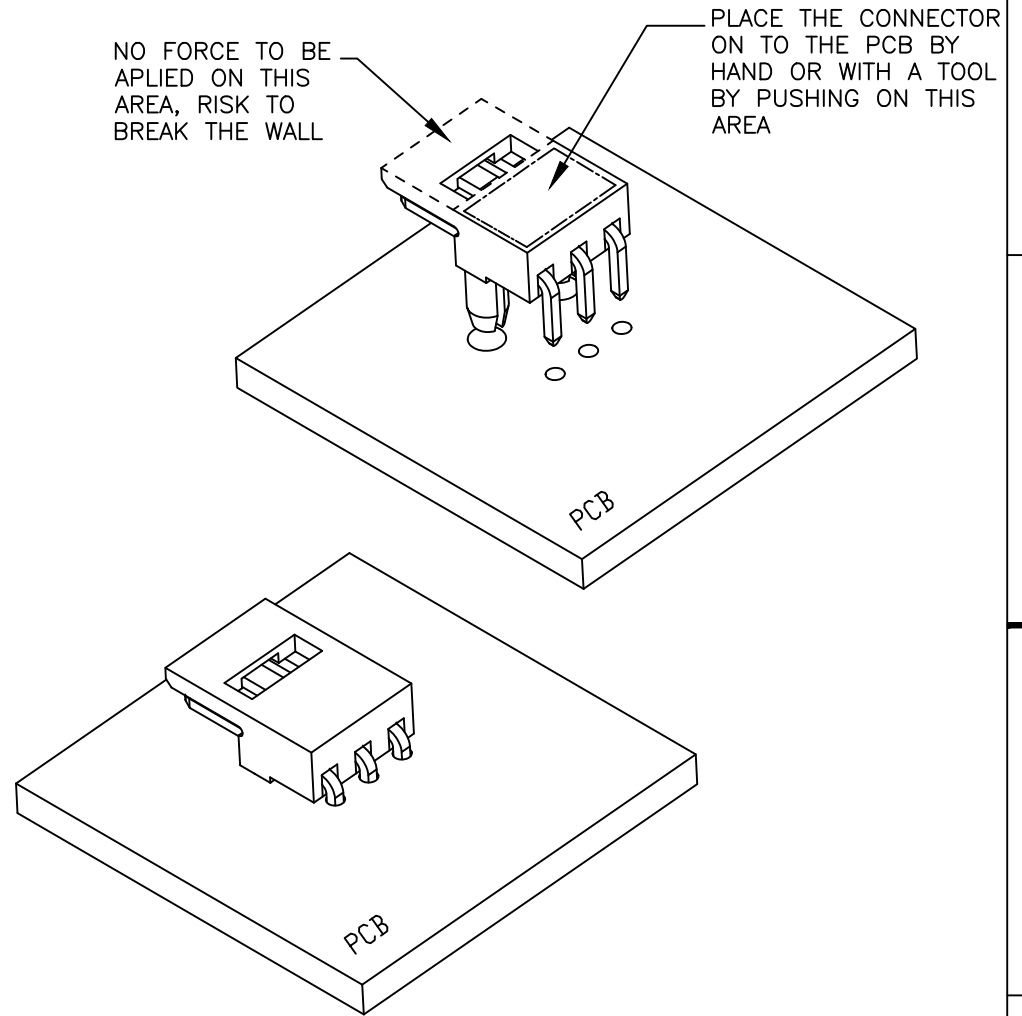
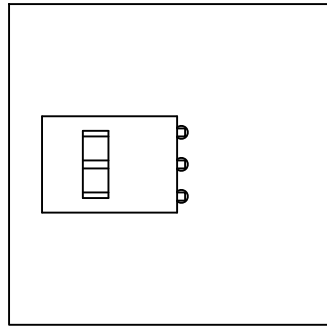

mat'l. code		surface		tolerance		projection		product family	
		ISO 1302 <input checked="" type="checkbox"/>		ISO 406 ISO 1101				MINITEK	
ltr		ecn no		date		tolerances unless otherwise specified		title	
A		B-19986		JCO 15.01.13		.X ±0.3		 scale 1:1	
B		F-55059		DDE 25.03.20		linear			
						.XX ±0.13 .XXX ±0.05			
				dr		J.FABRE 15.01.07		dwg no	
				enrg		L.MULIN 15.01.07		sheet 2 of 2	
				chr		J.COMPAGNON 15.01.12		size	
				appd		J.COMPAGNON 15.01.13		A3	
sheet index		revision sheet						type	
								CUSTOMER Drawing	



Amphenol FCI
FCIconnect.com

Copyright FCI