

1

2

3

4

5

6

7

A

B

C

D

E

F

G

H

A

B

C

D

E

F

G

H

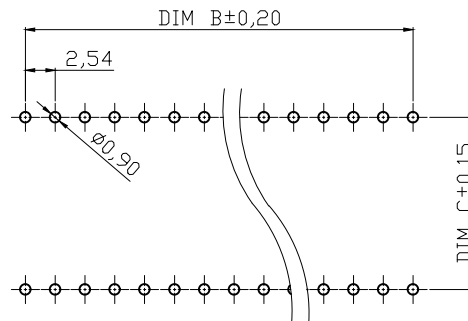
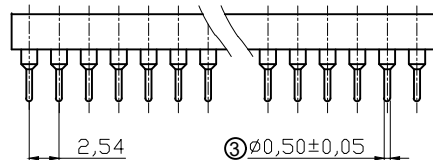
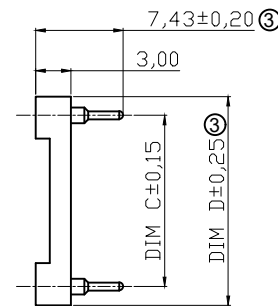
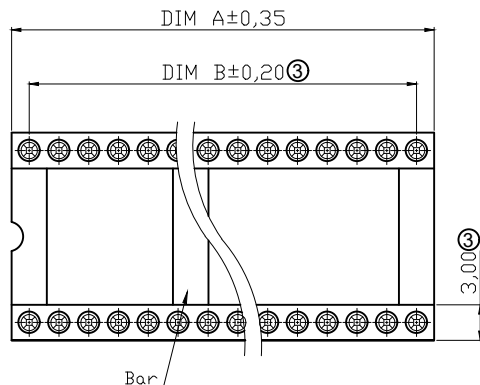

Packing: Tube

NOTES:

MATERIAL

- ⑥ 1.Pin(outer sleeve): Brass, machined CuZn38Pb2
- ③ 2.Clip(contact 4 finger): Beryllium copper, heat treated
- 3.Plating(outer sleeve): HZL: 2um/80u"nickel, 5um/200u"Tin
HGL: 2um/80u"nickel, Gold flash
- 4.Plating(contact): 2um/80u"nickel, Gold flash or 10u", 30u" Gold
- 5.Insulator Material: Glass filled PBT, UL94V-0 Black

ELECTRICAL

- 1.Current Rating: 3Amps/contact max.
- 2.Contact Resistance: 4mΩ/contact max.
- ⑥ 3.Insulation Resistance: ≥1000MΩ at 100VAC
- ⑥ 4.Operating Voltage: 60V AC/DC

MECHANICAL

- ⑥ 1.Average Insertion force with steel pin of $\phi 0.43\text{mm}/0.017"$: 4 finger < 250gf
- ⑥ 2.Average Withdrawal force with steel pin of $\phi 0.43\text{mm}/0.017"$: 4 finger > 25gf.
- 3.Mechanical life cycle: 200 min.
- 4.Operation Temperature: -40°C to +105°C
- ⑥ ④ 5.Wave Soldering temperature: +220°C, 5-10s max.

Contact	Dim A	Dim B	Dim C	Dim D	Note ③
06	7.62	5.08	7.62	10.16	w/o bar
08	10.16	7.62	7.62	10.16	
10	12.70	10.16	7.62	10.16	
14	17.78	15.24	7.62	10.16	
16	20.32	17.78	7.62	10.16	
18	22.86	20.32	7.62	10.16	
20	25.40	22.86	7.62	10.16	with bar
⑤ 22*	27.94	25.40	7.62	10.16	
22	27.94	25.40	10.16	12.70	
24*	30.48	27.94	7.62	10.16	
24	30.48	27.94	15.24	17.78	
28*	35.56	33.02	7.62	10.16	
28	35.56	33.02	15.24	17.78	
32	40.64	38.10	15.24	17.78	

Order Code:

AR xx-x x

No. of contact
06 ~ 64

Versions
-TT - Standard
/7-TT - Only for 22+24+28 poles* ⑤
(Dim C: 7.62)

Plating
outer sleeve / contact
HZL - Sleeve tin / clip gold flash
HZL/01 - Sleeve tin / clip 10u" gold
HZL/07 - Sleeve tin / clip 30u" gold
② HGL - Sleeve gold flash / clip gold flash

RoHS compliant

Unit:mm

Scale	Free	⑥	Update	04.06.2026	Segal	Date	Name	Customer-No.
TOLERANCE		⑤	Add the 22 Pin series drawing	08.08.2019	Segal	Drawn	23.07.2012	ASSMANN WSW-No. AR xx-x x
X.	±0.50	④	Update wave solder temp.	16.08.2017	Amy	Approved	04.06.2026	
X.X	±0.30	③	Update to new drawing	28.10.2016	Amy			Drawing-No. ASS 4852 CO
X.XX	±0.20	②	Add "HGL"-Version,corrected P/N code	28.01.2014	A. Plate			
X.XXX	±0.10	①	Add sheet 2	16.08.2012	Lucas			Replace Sheet 1 / 2
DIM	TOL	Id.	Modification	Date	Name			
Angle	±5°							A company of 
Angle	TOL							

1

2

3

4

5

6

7

1

2

3

4

5

6

7

A

B

C

D

E

F

G

H

A

B

C

D

E

F

G

H

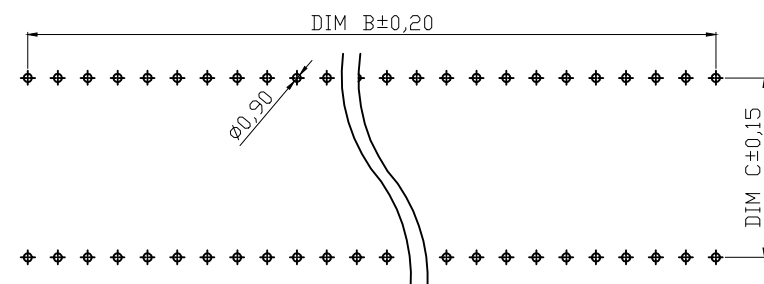
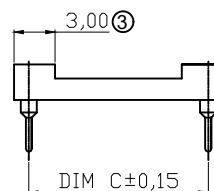
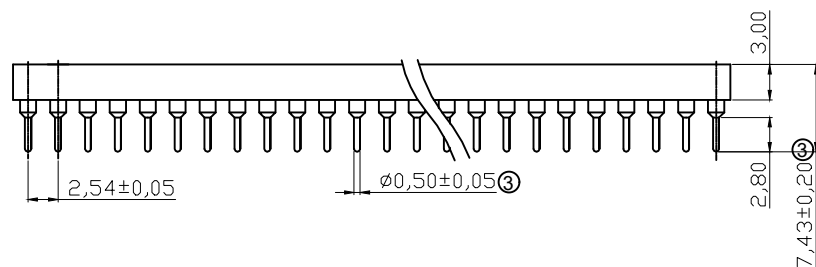
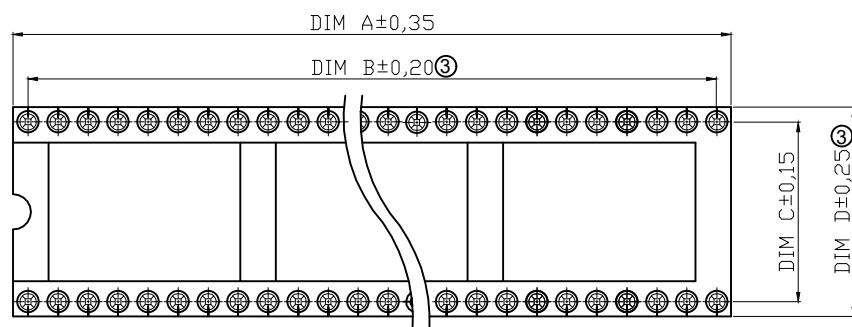

PCB LAYOUT

NOTES:

MATERIAL

- ⑥ 1.Pin(outer sleeve): Brass, machined CuZn38Pb2
 ③ 2.Clip(contact 4 finger): Beryllium copper, heat treated
 3.Plating(outer sleeve): HZL: 2um/80u"nickel, 5um/200u"Tin
 HGL: 2um/80u"nickel, Gold flash
 4.Plating(contact): 2um/80u"nickel, Gold flash or 10u", 30u" Gold
 5.Insulator Material: Glass filled PBT, UL94V-0 Black

ELECTRICAL

- 1.Current Rating: 3Amps/contact max.
 2.Contact Resistance: 4mΩ/contact max.
 ⑥ 3.Insulation Resistance: ≥1000MΩ at 100VAC
 ⑥ 4.Operating Voltage: 60V AC/DC

MECHANICAL

- ⑥ 1.Average Insertion force with steel pin of
 φ0.43mm/0.017": 4 finger<250gf
 ⑥ 2.Average Withdrawal force with steel pin of
 φ0.43mm/0.017": 4 finger>25gf.
 3.Mechanical life cycle: 200 min.
 4.Operation Temperature: -40°C to +105°C
 ⑥ ④ 5.Wave Soldering temperature: +220°C, 5-10s max.

Packing: Tube

Contact	Dim A	Dim B	Dim C	Dim D
36	45.72	43.18	15.24	17.78
40	50.80	48.26	15.24	17.78
42	53.34	50.80	15.24	17.78
48	60.96	58.42	15.24	17.78
50	63.50	60.96	15.24	17.78
52	66.04	63.50	15.24	17.78
⑥ 60	76.20	72.66	15.24	17.78
⑥ 64	81.28	78.74	15.24	17.78

RoHS compliant

Unit:mm

Scale	Free	⑥	Update	04.06.2026	Segal		Date	Name	Customer-No.
TOLERANCE		⑤	Add the 22 Pin series drawing	08.08.2019	Segal	Drawn	23.07.2012	Lucas	ASSMANN WSW-No. AR xx-x x
X.	±0.50	④	Update wave solder temp.	16.08.2017	Amy	Approved	04.06.2026	Segal	
X.X	±0.30	③	Update to new drawing	28.10.2016	Amy				
X.XX	±0.20	②	Add "HGL"-Version,corrected P/N code	28.01.2014	A. Plate				Drawing-No.
X.XXX	±0.10	①	Add sheet 2	16.08.2012	Lucas				ASS 4852 CO
DIM	TOL	Id.	Modification	Date	Name				rev06
Angle	±5°					A company of 		Replace	Sheet 2 / 2
Angle	TOL								

1

2

3

4

5

6

7