

PRODUCT
PN-XXXXX-XXXX

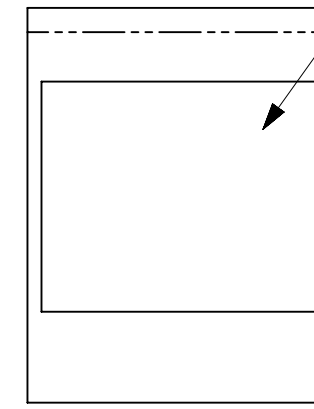

LABEL WITH EACH BAG:
PART NUMBER:
ORDER NUMBER:
MOLEX
DATE: YYWW

ONE SET PER ZIPPER POLY BAG
P/N: 89707-0318

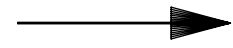

50 SETS PER POLY BAG
P/N: 89707-0176

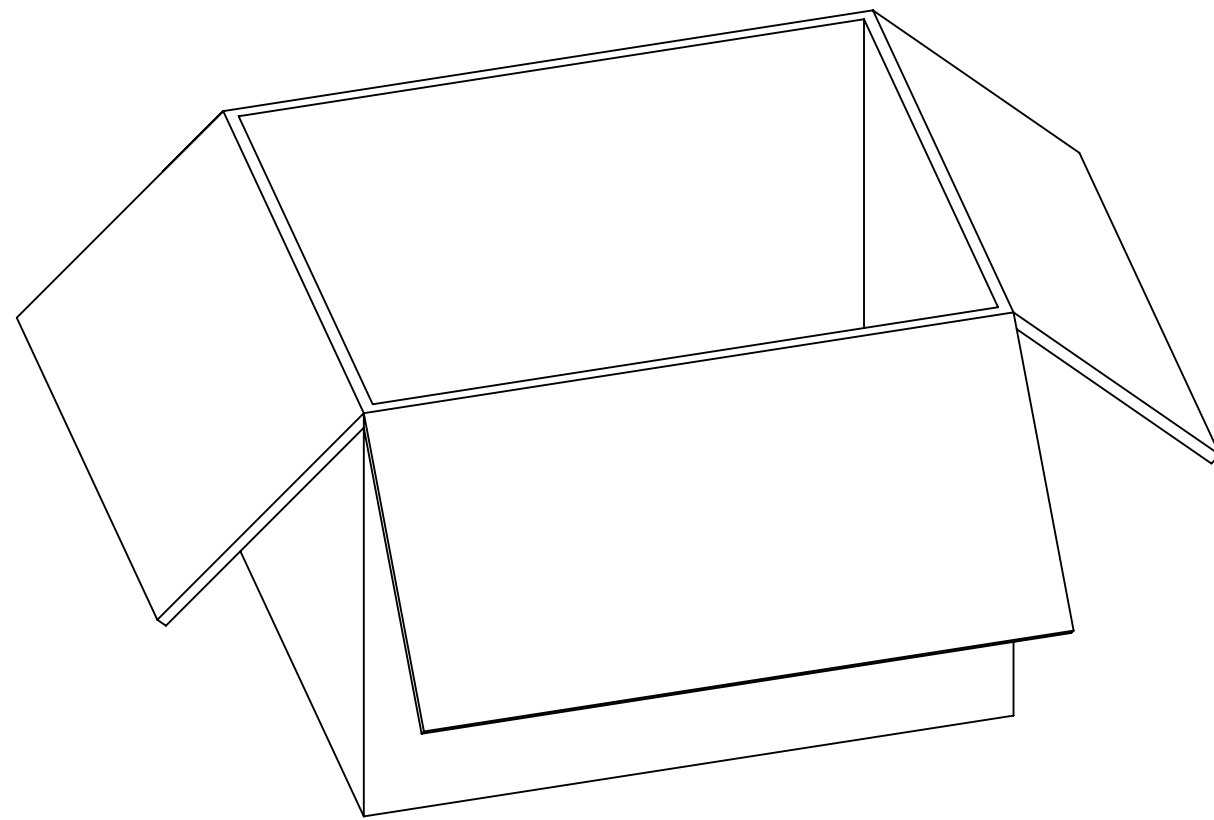
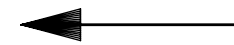

500 SETS PER INNER
CARTON BOX
P/N: 89499-9027

FUNCTIONAL SYMBOLS $\nabla_A = 0$ $\nabla_C = 0$ $\nabla_P = 0$	THIS DRAWING CONTAINS INFORMATION THAT IS PROPRIETARY TO MOLEX ELECTRONIC TECHNOLOGIES, LLC AND SHOULD NOT BE USED WITHOUT WRITTEN PERMISSION		CURRENT REV DESC: NEW RELEASE PER EWR16325-A					
	DIMENSION UNITS	SCALE						
	GENERAL TOLERANCES (UNLESS SPECIFIED)							
	ANGULAR TOL	$\pm 0.5^\circ$			STATUS: Design Approved DRWN: Cela Wei CHK'D: Kerrie Chen APPR: Darry Cheng			
DIVISIONAL SYMBOLS 3 PLACES \pm 2 PLACES \pm 1 PLACE \pm 0 PLACES \pm	MM	NTS	2024-02-23	DOCUMENT NUMBER	DOC TYPE	DOC PART	REVISION	
	DRAFT WHERE APPLICABLE MUST REMAIN WITHIN DIMENSIONS		THIRD ANGLE PROJECTION	DRAWING	SERIES	MATERIAL NUMBER	CUSTOMER	SHEET NUMBER
				C-SIZE	89542	895420250	PSD	000
								A
							1 OF 1	

MATERIALS AND FINISHES

BODY: ZINC ALLOY
PLATED (SEE TABLE)
THICKNESS (SEE TABLE)

CENTER CONTACT: BRASS
PLATED GOLD (THICKNESS SEE TABLE)

INSULATOR: TEFLON

OUTER CONTACT (OC): BERYLLIUM COPPER
PLATED GOLD (THICKNESS SEE TABLE)

CRIMP TUBE: BRASS
PLATED (SEE TABLE)
THICKNESS (SEE TABLE)

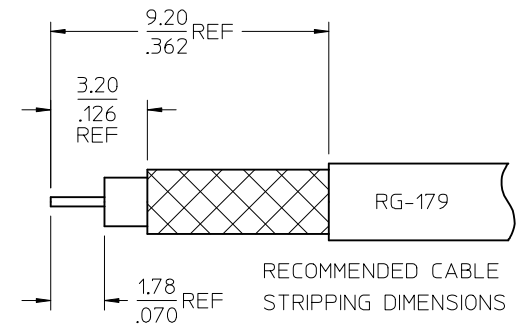
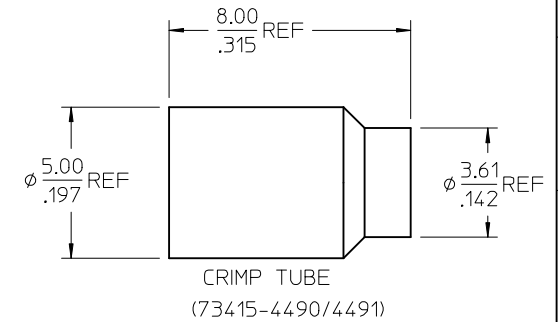
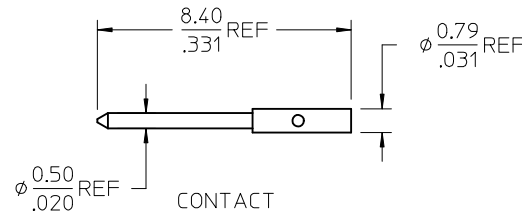
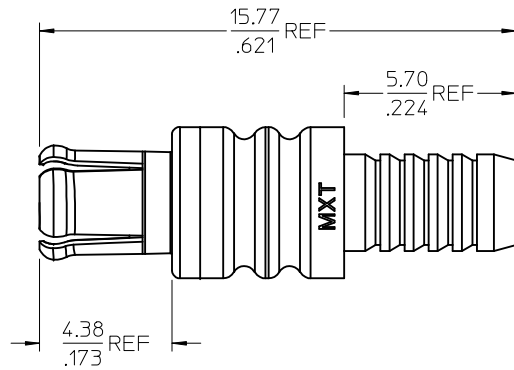
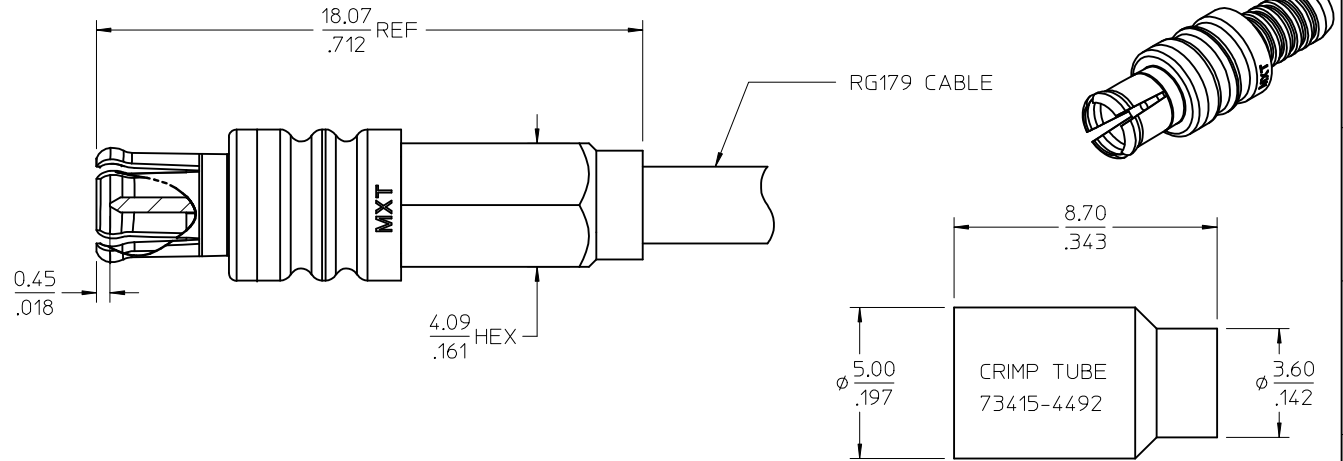

73415-4492	BAG	70 μ" MIN NICKEL	30 μ" MIN	30 μ" MIN	70 μ" MIN NICKEL
73415-4491	ONE PER BAG	GOLD FLASH	10 μ" MIN	5 μ" MIN	10 μ" MIN GOLD
73415-4490	BAG	GOLD FLASH	10 μ" MIN	5 μ" MIN	10 μ" MIN GOLD
PART NO.	PACKAGING	BODY FINISH	CONTACT FINISH	OC FINISH	CRIMP TUBE FIN

CHG: BAG WAS BULK PER RF17-E062 EC NO: URF2017-0344 DRW: IN LIN 2017/03/27 CHKD: APPR: YCHENG 2017/03/29 REV: A5	QUALITY SYMBOLS ▽=0 ▽=0	GENERAL TOLERANCES (UNLESS SPECIFIED) 4 PLACES ± --- ± --- 3 PLACES ± --- ± --- 2 PLACES ± --- ± --- 1 PLACE ± --- ± --- ANGULAR ± 2°	DIMENSION STYLE MM/IN	SCALE DESIGN UNITS METRIC	THIRD ANGLE PROJECTION	
	DRAWN BY TEF 2003/08/11	CHECKED BY SSS 2003/08/11	APPROVED BY GMH 2003/08/11	MATERIAL NO. SEE TABLE	DOCUMENT NO. SD-73415-449	SHEET NO. 1 OF 1
	TITLE MCX PLUG STR FOR RG179 75 OHMS MCX-PC EWR-2114					
	MOLEX INCORPORATED					
DRAFT WHERE APPLICABLE MUST REMAIN WITHIN DIMENSIONS THIS DRAWING CONTAINS INFORMATION THAT IS PROPRIETARY TO MOLEX INCORPORATED AND SHOULD NOT BE USED WITHOUT WRITTEN PERMISSION						