

UNIT : inches

REVISIONS					
REV	DATE	DESCRIPTION	BY	CHK	APPV
D6	05AUG2025	REVISED PER ECN-25-336612	AP	TC	

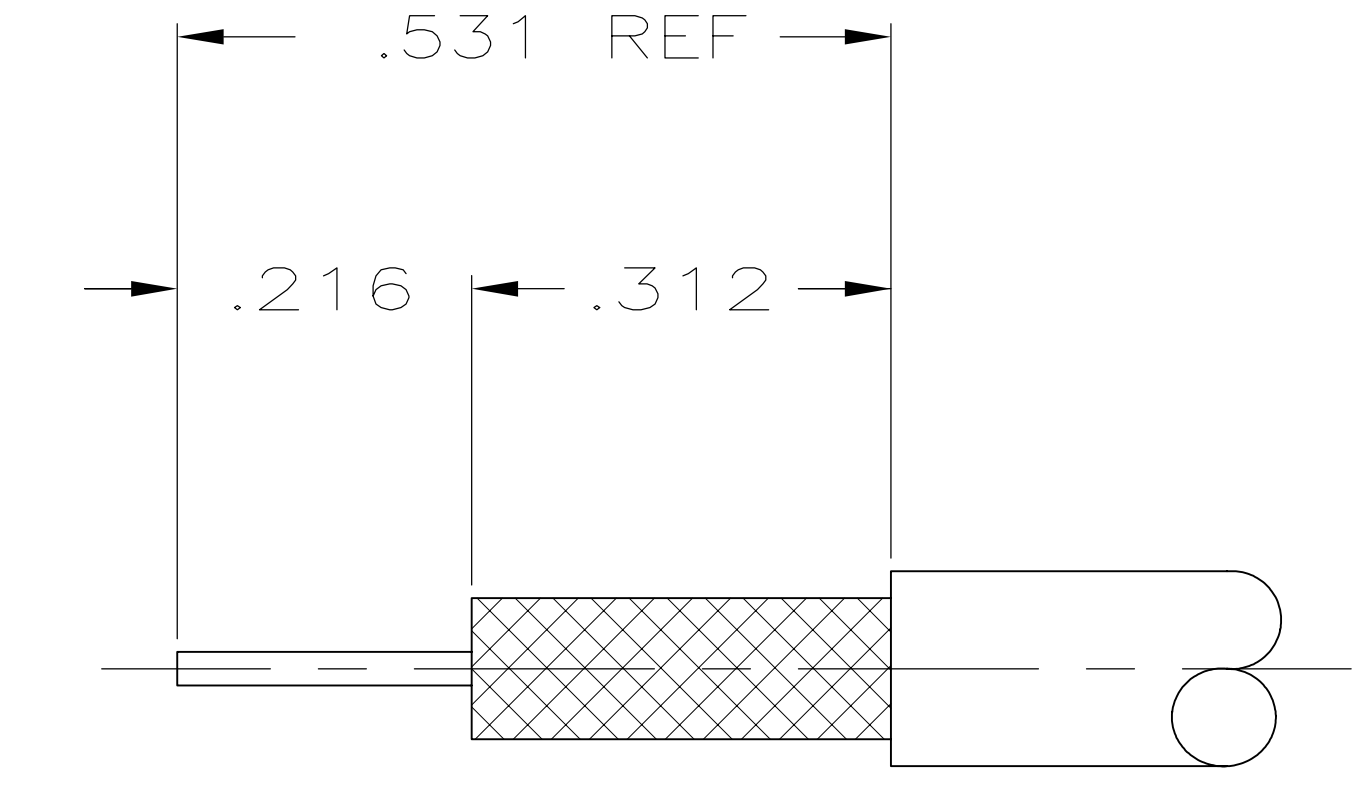
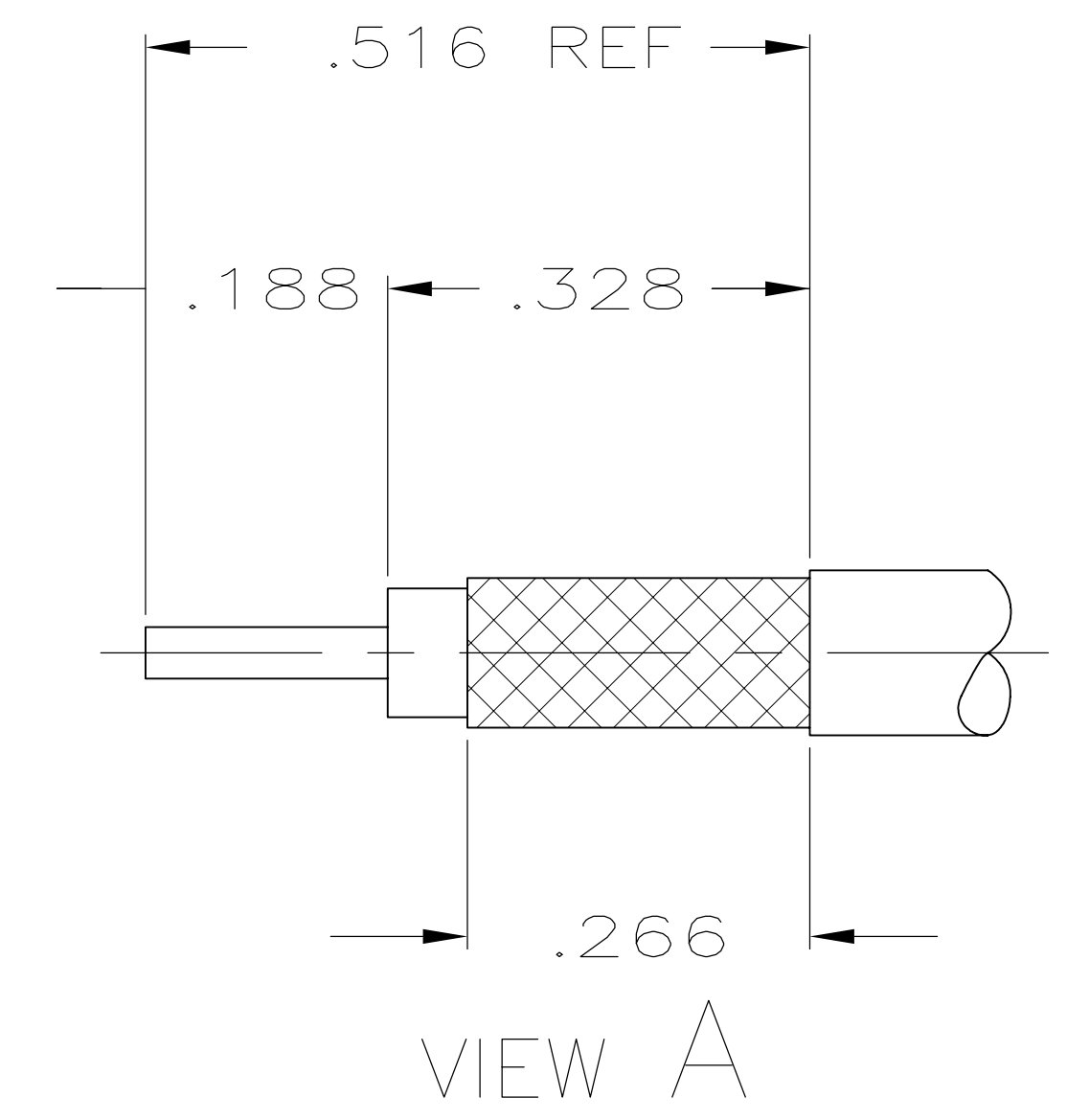
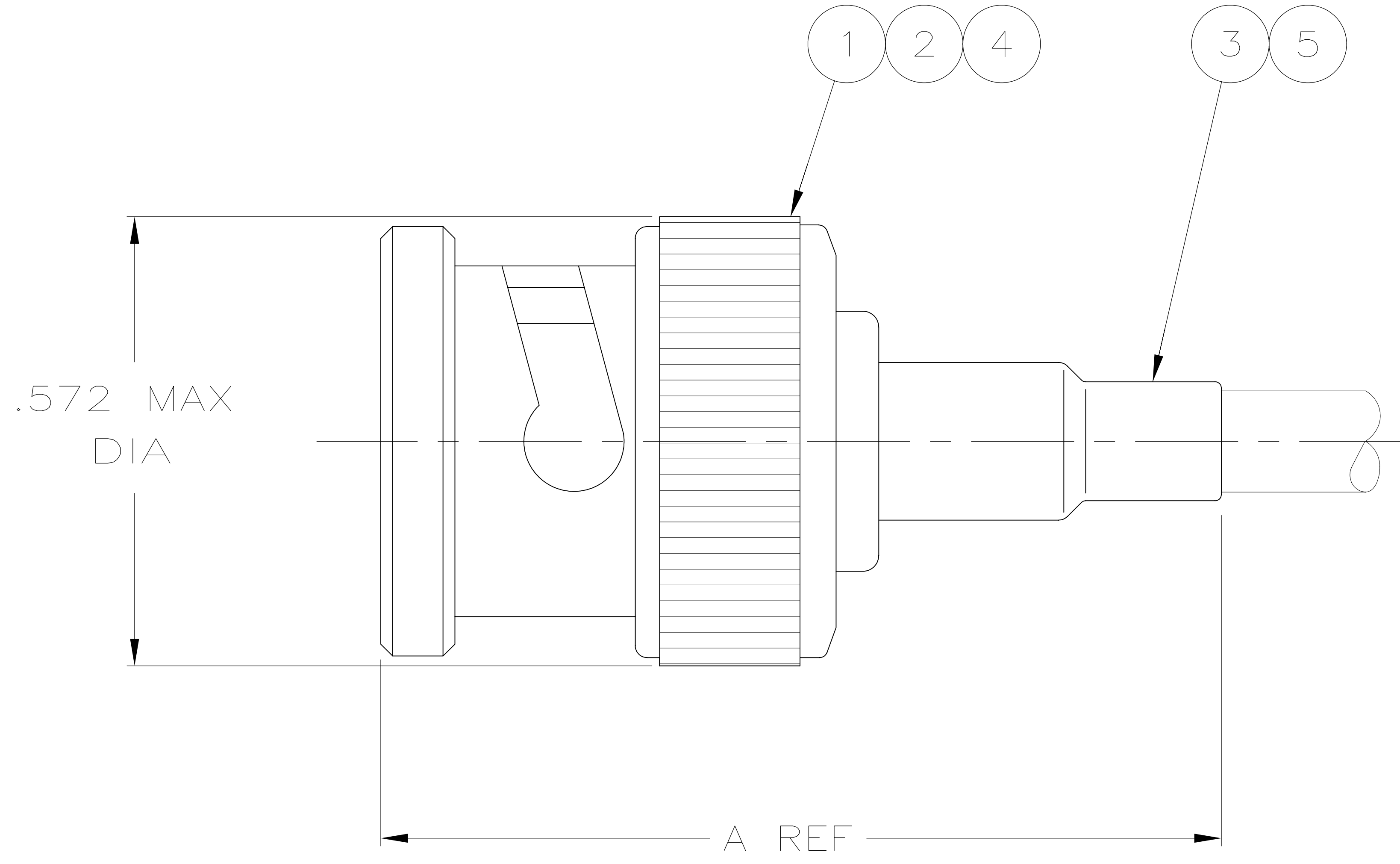

RECOMMENDED STRIP LENGTH

- ① CABLE USED WITHOUT SPACER
- ② CABLE USED WITH SPACER
- ③. SEE INSTRUCTION SHEET 408-2798
- ④. PARTS PACKAGED UNASSEMBLED
- ⑤ USE WITH HAND TOOL FRAME 354940-1
- ⑥ USE WITH HANDTOOL 69710-1, OR PNEUMATIC TOOL 69365 & 69365-3
- ⑦ OBSOLETE PARTS: OBSOLETE CIS STREAMLINING PER D.RENAUD/D.SINISI

RG-174/U & 188/U	220217-3	220210-1	220009-5	A	1.090	227194-1	-	9-328666-4	227322-8	9-227074-1	8-5227079-3
RG-174/U & 188/U	220217-3	220210-1	220009-5	A	1.090	227194-1	-	9-328666-0	227322-8	9-227074-1	1-5227079-6
① RG-59/U,59A/U & 59B/U	220217-2	220189-2	220187-2	A	1.090	-	227423-1	9-50428-0	9-221607-6	9-413530-0	1-5227079-1
② RG-62/U,62A/U & 62B/U				B							
① RG-59/U,59A/U & 59B/U	220217-2	220189-2	220187-2	A	1.090	-	227423-1	9-50428-0	221607-6	9-227074-2	5227079-7
② RG-62/U,62A/U & 62B/U				B							
RG-55/U,55A/U,55B/U, & 223/U	220217-1	220189-1	220187-1	A	1.280	-	-	9-225382-0	221607-5	9-227074-0	5227079-6
CABLE SIZE	DIE SET ⑥	DIE SET ⑤	CRIMP TOOL	VIEW	A	⑤ TUBING QTY=1	④ SPACER QTY=1	③ FERRULE QTY=1	② CONTACT QTY=1	① PLUG ASSY QTY=1	PART NUMBER

THIS DRAWING IS A CONTROLLED DOCUMENT.

DIMENSIONS: INCHES

TOLERANCES UNLESS OTHERWISE SPECIFIED:

0. PLC	± .01
1. PLC	± .01
2. PLC	± .01
3. PLC	± .016
4. PLC	± .01
ANGLES	± .01

MATERIAL: - FINISH: -

WEIGHT: 0.000000

CUSTOMER DRAWING

DIN: J. HAVENER 29MAR2005
CHK: J. HAVENER 29MAR2005
APVD: J. LIPPERT 29MAR2005

NAME: -
PRODUCT SPEC: 108-12044
APPLICATION SPEC: -

SIZE: A1
SCALE: 4:1
SHEET: 1 OF 3
REV: D6

TE Connectivity
PLUG, COMMERCIAL, BNC

UNIT : mm

REVISIONS					
REV	DATE	DESCRIPTION	BY	CHK	APPV
-	-	SEE SHEET 1	-	-	-

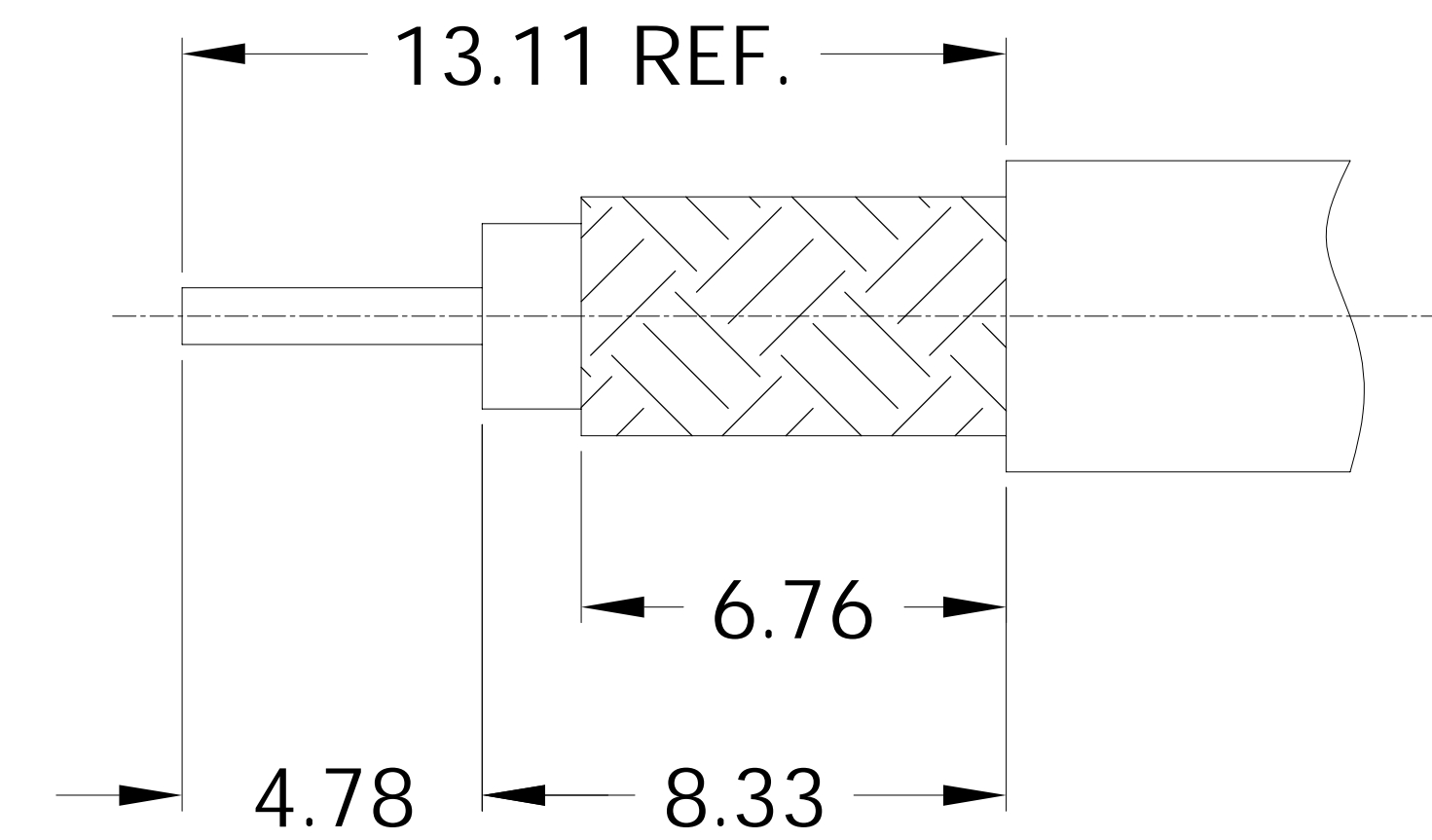
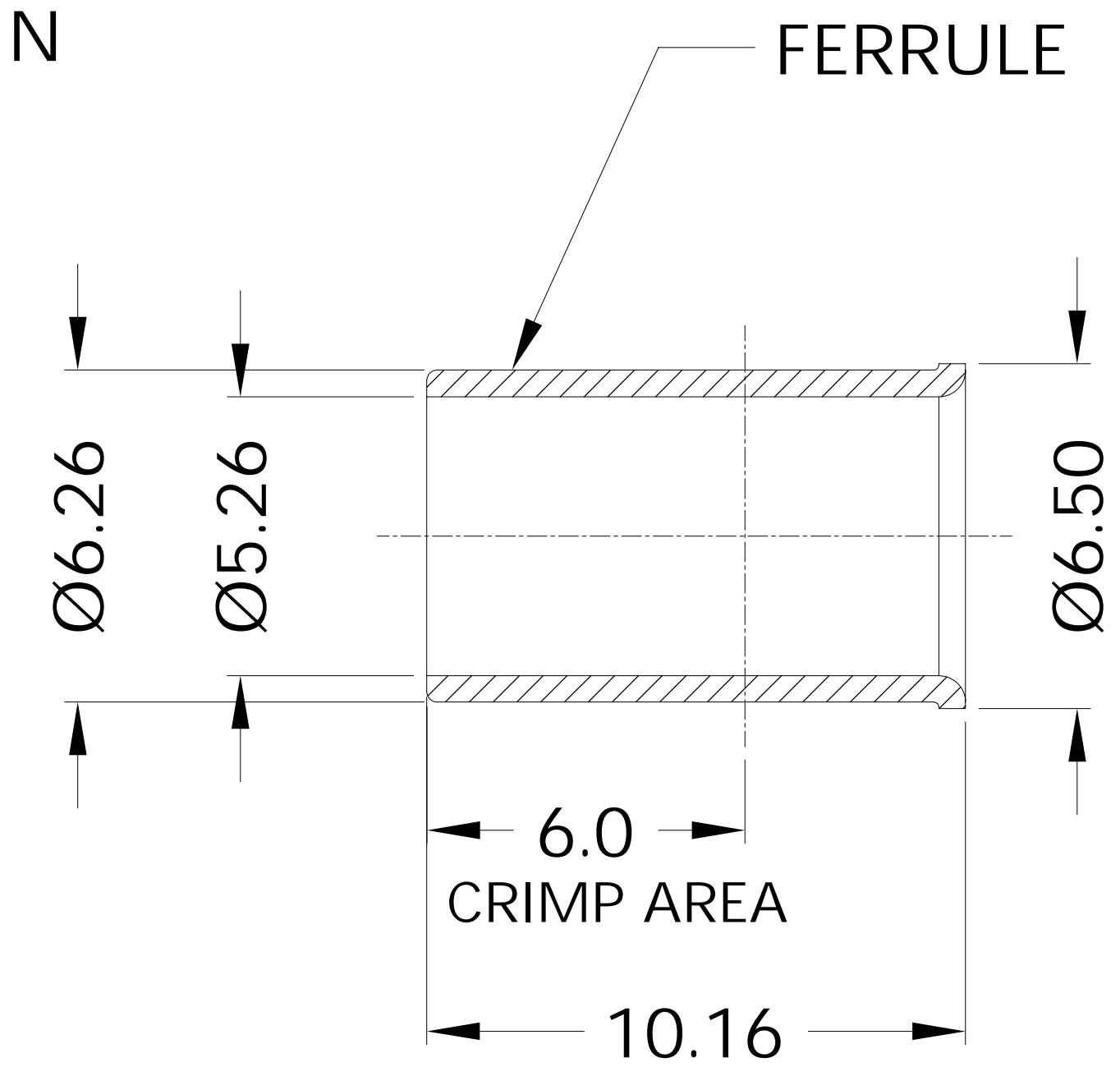
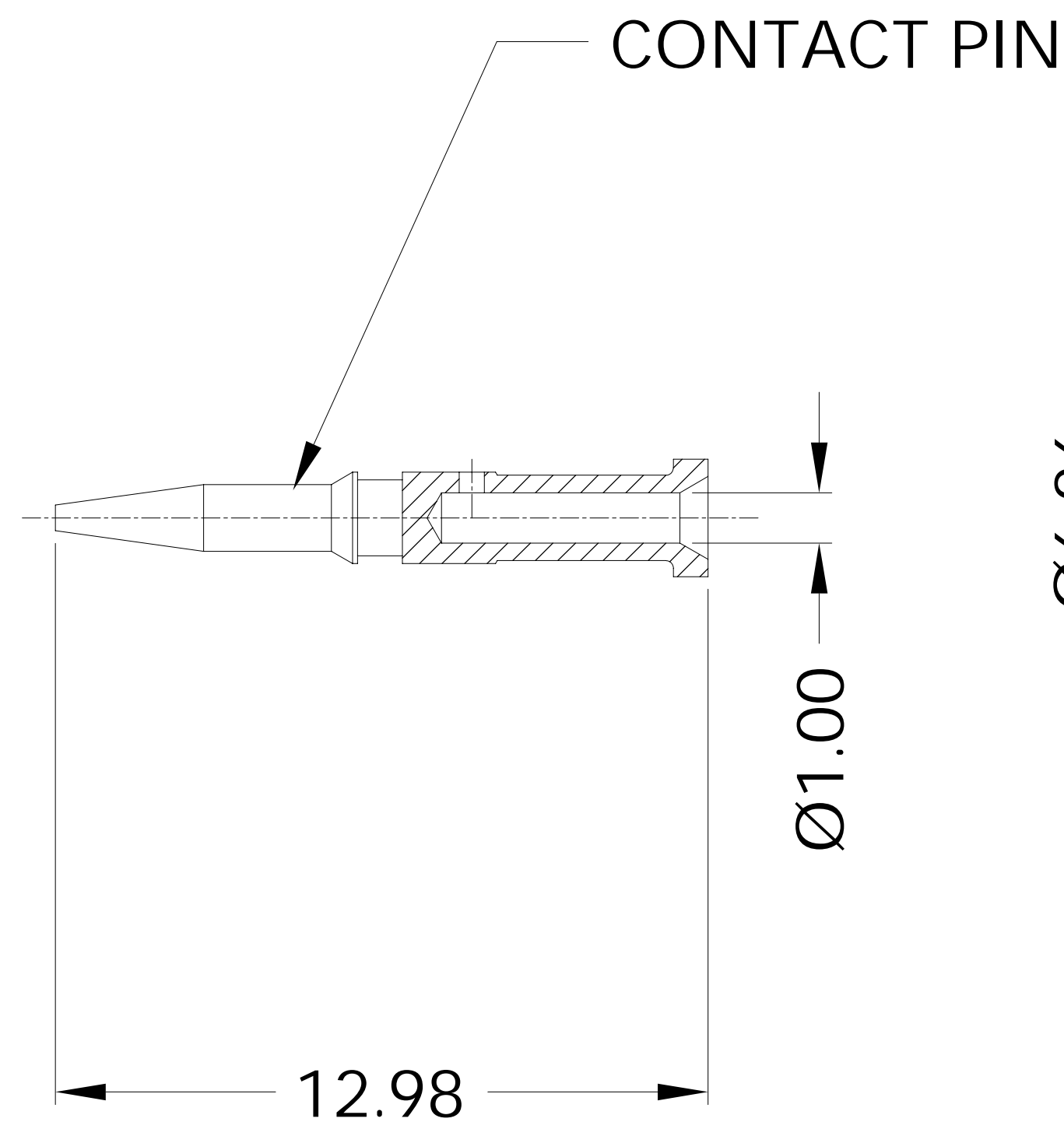
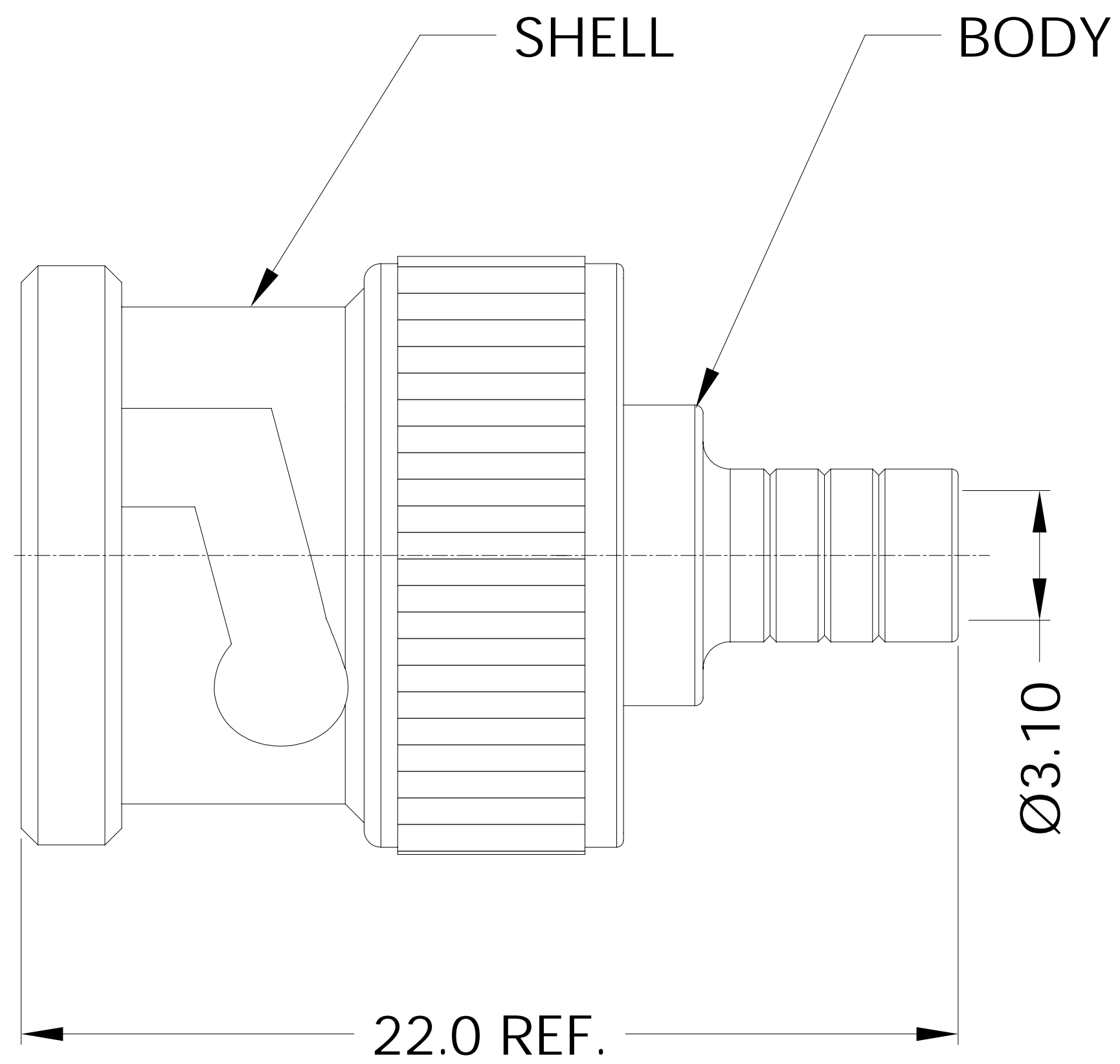

NOTES

- 1 PACK IN ACCORDANCE WITH TE SPEC 107-3275;
- 2 ALL DIMENSIONS ARE NOMINAL FOR REFERENCE ONLY UNLESS OTHERWISE STATED;
- 3 ELECTRICAL CHARACTERISTICS :
 - FREQUENCY RANGE : DC-4GHz
 - NOMINAL IMPEDANCE : 50 OHMS
 - INSULATION RESISTANCE : 5000 MOHMS
 - WORKING VOLTAGE : 335 VOLTS MAX
 - DIELECTRIC WITHSTANDING VOLTAGE : 1000 VOLTS MAX
 - V.S.W.R : 1.50 MAX (DC-4GHz)
 - INSERTION LOSS : 0.1 SQRT(F) dB
 - CONTACT RESISTANCE :
 - CENTER CONTACT : 1.5 mOHMS MAX
 - OUTER CONTACT : 1 mOHMS MAX
- 4 ENVIRONMENTAL :
 - OPERATING TEMPERATURE : -40°C TO +125°C
 - THERMAL SHOCK:MIL-STD-202, METH.107, COND.B
 - VIBRATION:MIL-STD-202, METH.204, COND.D
 - SHOCK:MIL-STD-202, METH.213, COND.I
- 5 DURABILITY : 500 CYCLES MIN
- 6 RoHS : COMPLIANT
- 7 FERRULE TO CRIMPED THE HEX. SIZE .205".
USE WITH HAND TOOL 2087631-1 AND DIE SET 2087632-1.
CONTACT PIN TO SOLDER.

RECOMMENDED CABLE STRIPPING DIM'S

1	1	MATTE TIN 100 u"	BRASS	FERRULE	5
1	1	/	PTFE	INSULATOR	4
1	-	GOLD 5 u"/NICKEL /COPPER	BRASS C3604	CONTACT PIN	3
-	1	GOLD 30 u"/NICKEL /COPPER	BRASS C3604	CONTACT PIN	3
1	1	NICKEL 50 u"/COPPER	ZINC ALLOY	SHELL	2
1	1	NICKEL 50 u"/COPPER	BRASS C3604	BODY	1
5227079-1	5227079-5	PLATING	MATERIAL	DESCRIPTION	ITEM

QUANTITY PER ASSY		PARTS LIST			
THIS DRAWING IS A CONTROLLED DOCUMENT.		DIMENSIONS: INCHES 0. PLC ± 0.3 1. PLC ± 0.2 2. PLC ± 0.15 3. PLC ± 0.1 4. PLC ± 0.1 ANGLES ± 5°		TOLERANCES UNLESS OTHERWISE SPECIFIED: 0. PLC ± 0.3 1. PLC ± 0.2 2. PLC ± 0.15 3. PLC ± 0.1 4. PLC ± 0.1 ANGLES ± 5°	
MATERIAL: - FINISH: -		THIS DRAWING IS A CONTROLLED DOCUMENT. DWG: J. HAVENER 29MAR2005 CHK: J. HAVENER 29MAR2005 APVD: J. LIPPERT 29MAR2005 NAME: - PRODUCT SPEC: 108-12044 APPLICATION SPEC: -		DRAWING NO: - SIZE: A1 CASE CODE: 00779 DRAWING NO: 5227079 RESTRICTED TO: -	
WEIGHT: 0.000000 CUSTOMER DRAWING		SCALE: 4:1 SHEET: 2 OF 3 REV: D6			

UNIT : mm

REVISIONS					
REV	DATE	DESCRIPTION	BY	CHK	APPV
-	-	SEE SHEET 1	-	-	-

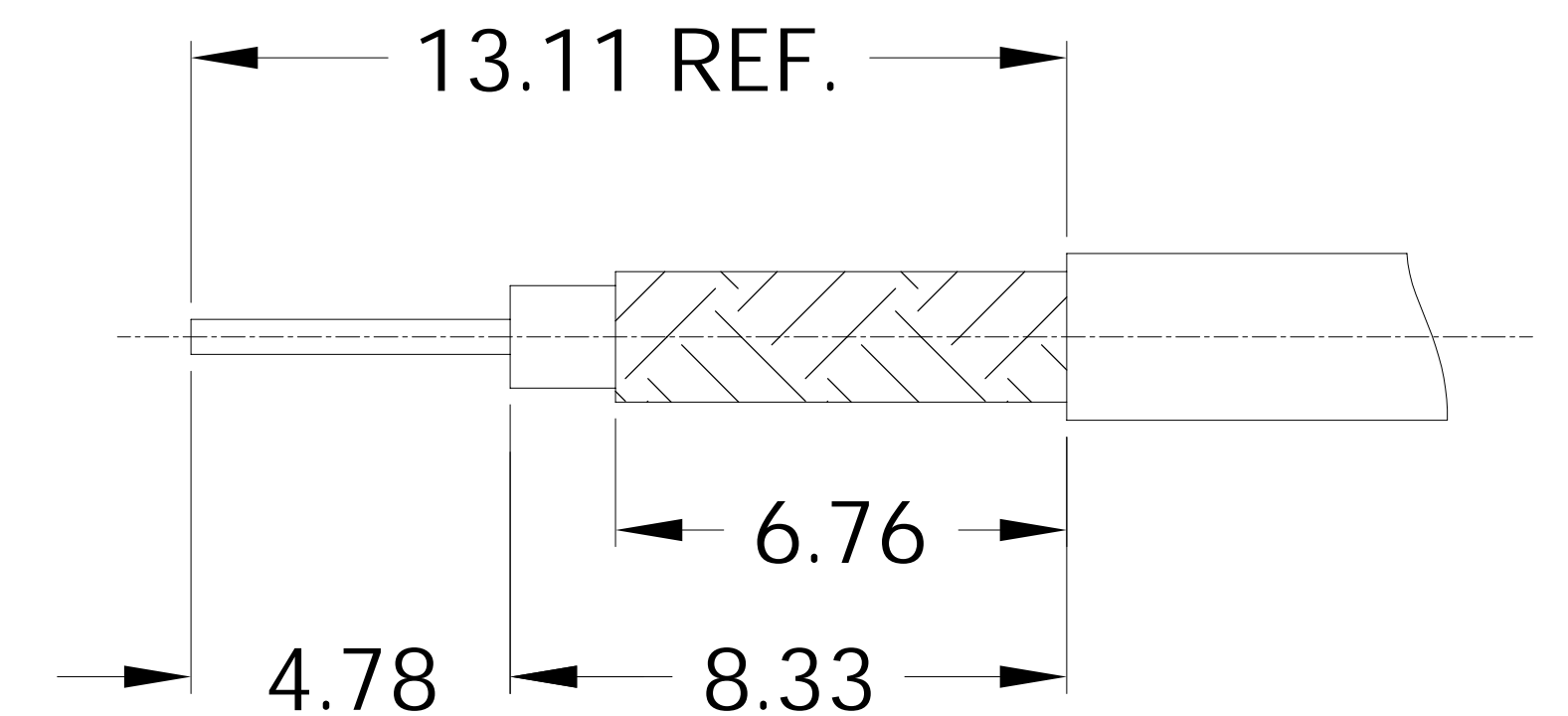
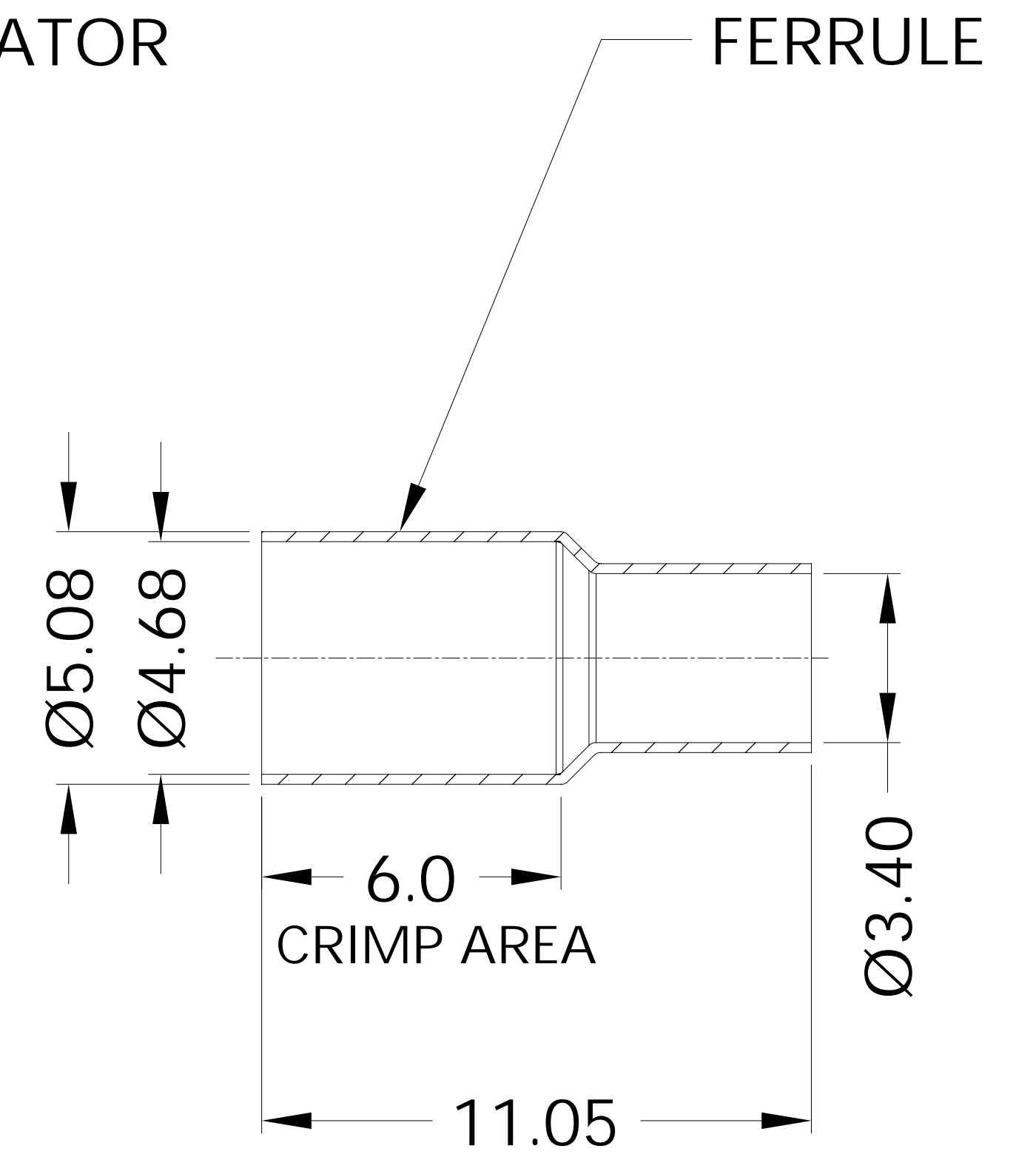
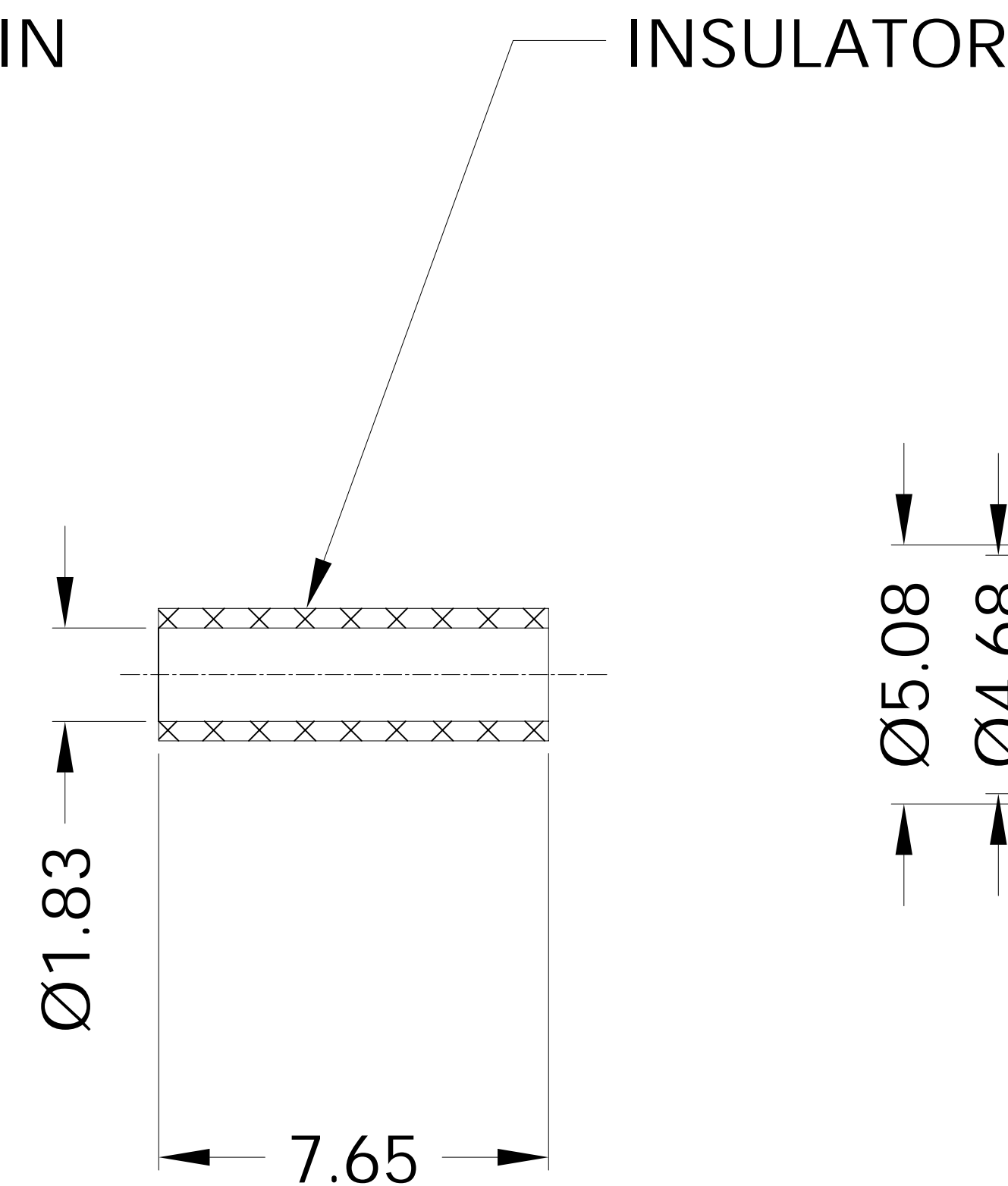
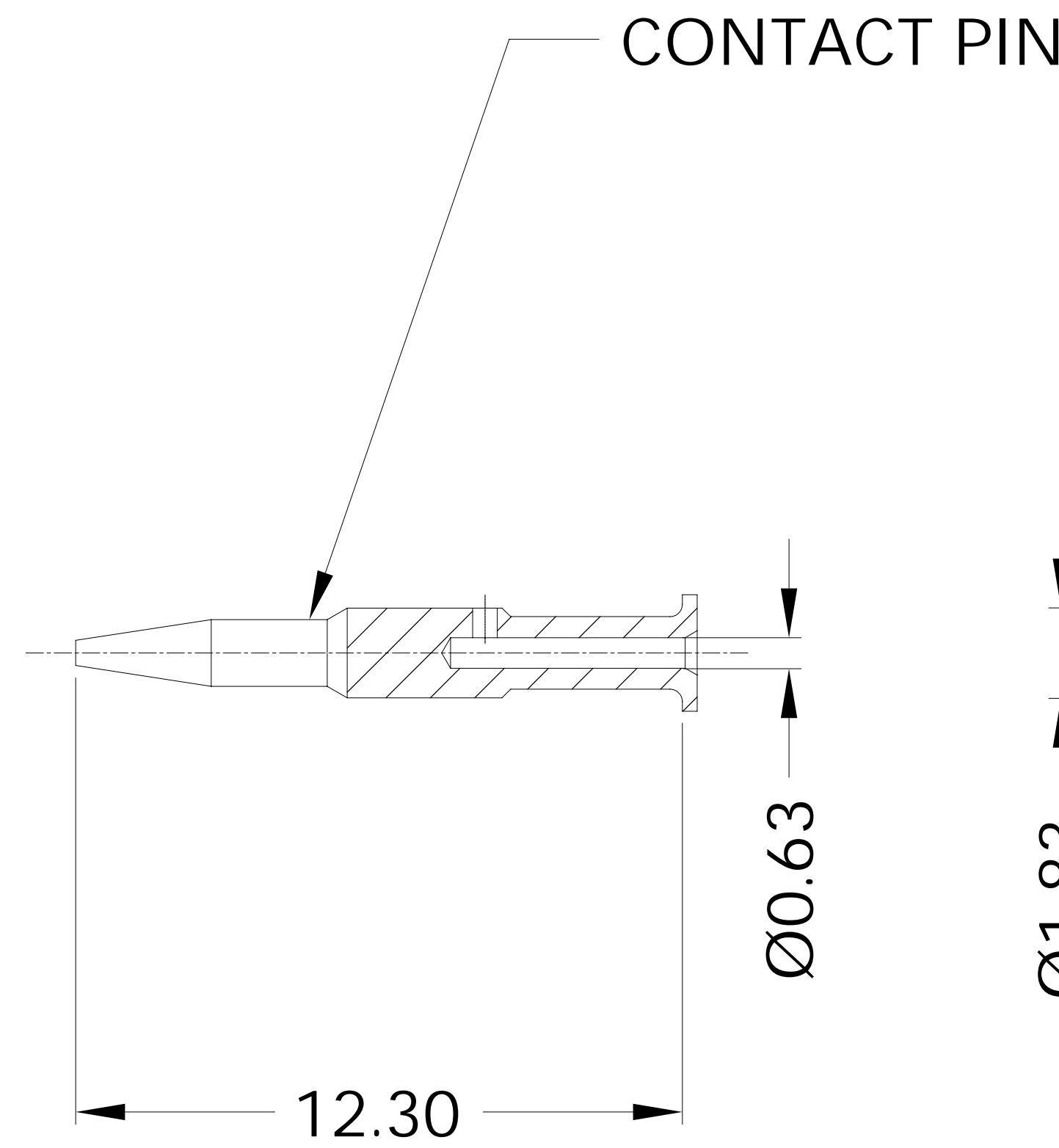
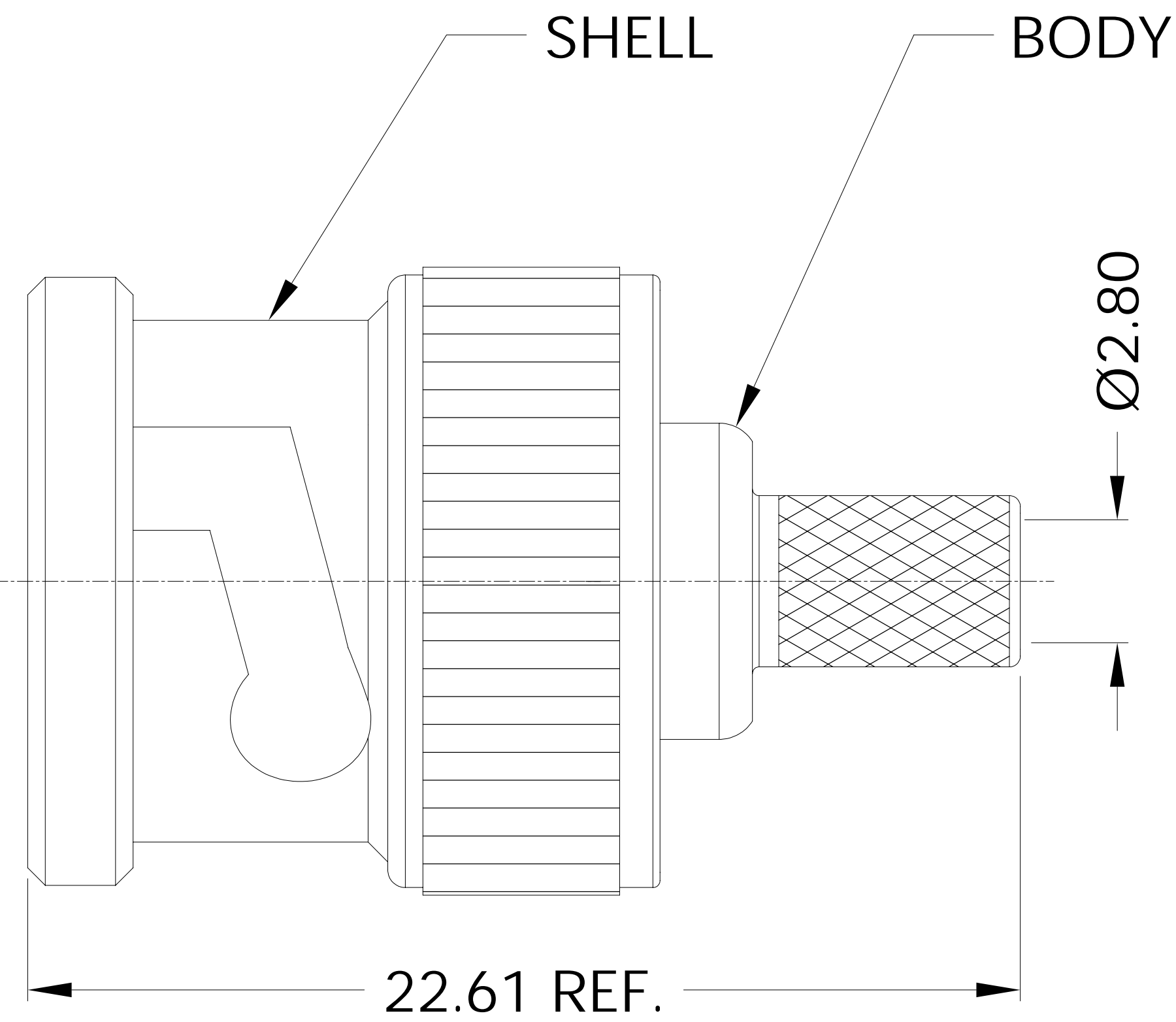

RECOMMENDED CABLE STRIPPING DIM'S

NOTES

- PACK IN ACCORDANCE WITH TE SPEC 107-3275;
- ALL DIMENSIONS ARE NOMINAL FOR REFERENCE ONLY UNLESS OTHERWISE STATED;
- ELECTRICAL CHARACTERISTICS :
 FREQUENCY RANGE : DC-1GHz
 NOMINAL IMPEDANCE : 50 OHMS
 INSULATION RESISTANCE : 5000 MOHMS
 WORKING VOLTAGE : 335 VOLTS MAX
 DIELECTRIC WITHSTANDING VOLTAGE : 1000 VOLTS MAX
 INSERTION LOSS : 0.1 SQRT(F) dB
 CONTACT RESISTANCE :
 CENTER CONTACT : 1.5 mOHMS MAX
 OUTER CONTACT : 1 mOHMS MAX
- ENVIRONMENTAL :
 OPERATING TEMPERATURE : -40°C TO +125°C
 THERMAL SHOCK:MIL-STD-202, METH.107, COND.B
 VIBRATION:MIL-STD-202, METH.204, COND.D
 SHOCK:MIL-STD-202, METH.213, COND.I
- DURABILITY : 500 CYCLES MIN
- RoHS : COMPLIANT
- FERRULE TO CRIMPED THE HEX. SIZE .177".
 USE WITH HAND TOOL 2087631-1 AND DIE SET 2087632-2.
 CONTACT PIN TO SOLDER.

QTY	PER ASSY	MATERIAL	DESCRIPTION	ITEM	
1	1	MATTE TIN 100 u"	FERRULE	5	
1	1	/	INSULATOR	4	
1	-	GOLD 5 u"/NICKEL /COPPER	CONTACT PIN	3	
-	1	GOLD 30 u"/NICKEL /COPPER	CONTACT PIN	3	
1	1	NICKEL 50 u"/COPPER	SHELL	2	
1	1	NICKEL 50 u"/COPPER	BODY	1	
5227079-2	8-5227079-2	PLATING	DESCRIPTION	ITEM	
QUANTITY PER ASSY		PARTS LIST			

THIS DRAWING IS A CONTROLLED DOCUMENT.

DIMENSIONS: INCHES	TOLERANCES UNLESS OTHERWISE SPECIFIED:	DIN J. HAVENER 29MAR2005	APVD J. LIPPERT 29MAR2005	NAME
0. PLC ± 0.3	1. PLC ± 0.2	2. PLC ± 0.15	3. PLC ± 0.15	4. PLC ANGLES ± 5°
MATERIAL	FINISH	WEIGHT 0.000000	SIZE A1 00779	CAGE CODE 5227079
CUSTOMER DRAWING		SCALE 4:1	SHEET 3 OF 3	REV D6

TE Connectivity
 PLUG, COMMERCIAL, BNC
 MATCH WITH RG316D AND RG188D