

- NOTES :
- MATERIAL :
HOUSING : POLYESTER ,UL94V-0 ,
COLOR:BLACK, OR WHITE
TERMINAL : PHOSPHOR BRONZE (PhBr)
METAL SHELL : COPPER ALLOY
 - PLATING :
TERMINAL :
CONTACT AREA :
(a) GOLD FLASH.
(b) GOLD (Au), THICKNESS=30 MICROINCH /0.76 MICROMETER
SOLDER TAIL : (a) TIN-LEAD (90/10) ALLOY
,THICKNESS=150 MICROINCH/3.8 MICROMETER
(b) PURE TIN PLATING,
,THICKNESS=50 MICROINCH/1.27MICROMETER MINIMUM.
UNDER PLATE : NICKEL (NI)
,THICKNESS=50 MICROINCH / 1.27 MICROMETER
 - METAL SHELL :
(a) TIN-LEAD (Sn-Pb) ALLOY
,THICKNESS=100 MICROINCH /2.54 MICROMETER
(b) PURE TIN PLATING,
,THICKNESS =50 MICROINCH/1.27 MICROMETER MINIMUM.
UNDER PLATE : NICKEL (NI)
,THICKNESS=50 MICROINCH / 1.27 MICROMETER
 - RECOMMENDED PCB THICKNESS : 1.60±0.05mm
 - PRODUCT SPECIFICATION : REFER TO PS-67998-0000

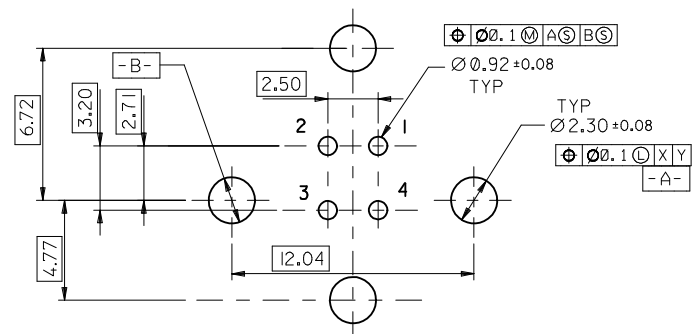

REVISED	EC NO:	DRWN:YPMU	CHKD:	APPR:	DESCRIPTION	QUALITY SYMBOLS	GENERAL TOLERANCES (UNLESS SPECIFIED)		DIMENSION STYLE		SCALE	DESIGN UNITS	THIRD ANGLE PROJECTION
						▽=0 ∇=0	mm	INCH	MM ONLY	1:1	METRIC		
							4 PLACES	± ---	± ---	DRAWN BY	DATE	TITLE	
							3 PLACES	± ---	± ---	SAM SHIN	1998/12/21	USB B VERTICAL CONN	
							2 PLACES	± 0.25	± ---	CHECKED BY	DATE		
							1 PLACE	± 0.25	± ---	VLIN	1998/12/21		
							ANGULAR ± 3 °		APPROVED BY	DATE	MOLEX INCORPORATED		
							DRAFT WHERE APPLICABLE MUST REMAIN WITHIN DIMENSIONS		NEGA LIN	1998/12/21	DOCUMENT NO.	SHEET NO.	
									SEE TABLE		SD-67265-002	1 OF 2	
									THIS DRAWING CONTAINS INFORMATION THAT IS PROPRIETARY TO MOLEX INCORPORATED AND SHOULD NOT BE USED WITHOUT WRITTEN PERMISSION				

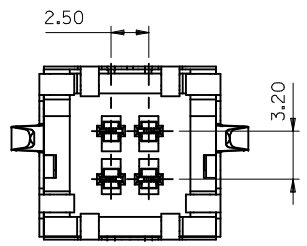
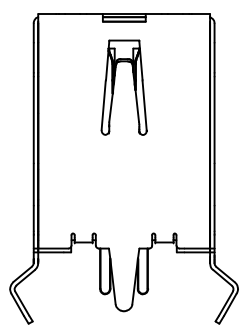
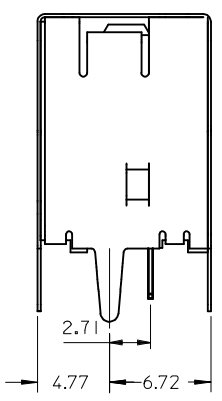
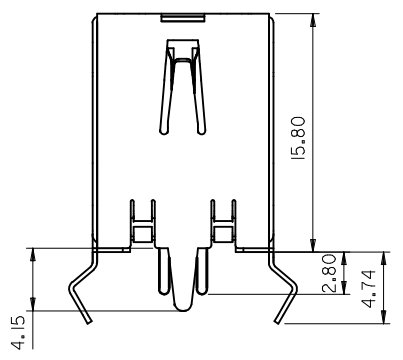