

Recommended PCB Layout
(Tolerance: ± 0.05)

■ Solder Area

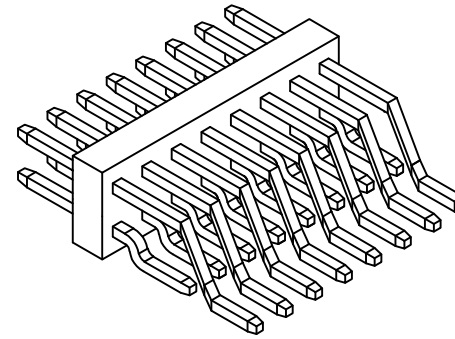

Contacts	Dimensions	
	A	B
4	1.00	2.20
6	2.00	3.20
8	3.00	4.20
10	4.00	5.20
12	5.00	6.20
14	6.00	7.20
16	7.00	8.20
18	8.00	9.20
20	9.00	10.20
22	10.00	11.20
24	11.00	12.20
26	12.00	13.20
28	13.00	14.20
30	14.00	15.20

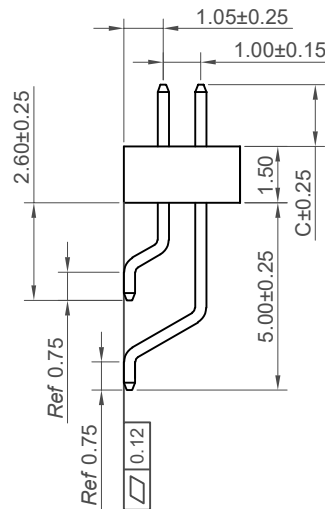
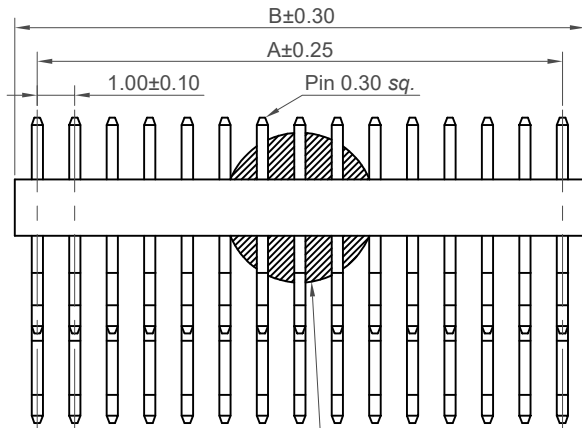

Film $\varnothing = 3.00\text{mm}$ (04-06 Contacts)
 $\varnothing = 4.00\text{mm}$ (08-30 Contacts)
 Thickness = 0.15mm (All)

Specifications

Material

Insulator: Polymer LCP, UL94V-0
 Contact: Copper Alloy

Plating

Gold Flash All Over

Electrical

Current Rating: 1 Amp Per Pin
 Contact Resistance: 20 m Ω max.
 Insulation Resistance: 1000 M Ω min.
 Dielectric Withstand Voltage: 300V AC

Mechanical & Environmental

Operating Temperature: -40°C to +125°C
 Soldering Process:
 IR Reflow: 260°C for 10 sec.
 Manual Solder: 350°C for 3-5 sec.

Mates with (Subject to pin length)

BC084 BC085

Ordering Grid

BC057-XX-A-A-XXXX-L-C Request Samples and Quotation

No. of Contacts
04 to 30

Contact Plating
A = Gold Flash All Over

Insulator Width
A = 1.50mm

Packing Option
C = Tape & Reel with Film

Insulator Material
L = LCP

Dimension C (1/100mm) (Post Height)
0150 = 1.50mm (Standard)
 or specify Dimension C
 eg 0250 = 2.50mm
 (Maximum 0600=6.00mm)
 (Minimum 0100=1.00mm)

Part Number		Product Description	
BC057		1.0mm Pitch Pin Header, Dual Row, Surface Mount, Horizontal	
Drawing Date		9th September 2009	
By	MW	Tolerances (Except as Noted)	Units:
Detail	BC057 I PCN	Length: X. ± 0.30 Angle: XX ± 0.25 Revision: X.XX ± 0.15 Date: X.XXX ± 0.10	Metric (mm)
		X. $\pm 5^\circ$ X.X $\pm 3^\circ$ X.XX $\pm 2^\circ$ X.XXX $\pm 1^\circ$	3rd Angle Projection
Revision	I4		
Date	29/12/25		

Halogen Free



This drawing is confidential and copyright of Global Connector Technology, Ltd (GCT). This drawing must not be copied or disclosed without written consent. E & OE



Not to Scale | Drawn By ASE | Sheet No. 1/1